

TENDER DOCUMENT

TURNKEY WORKS FOR SETTING UP OF AMRIT PHARMACY

AT

**B J GOVT. MEDICAL COLLEGE & SASSOON
GENERAL HOSPITAL, PUNE, MAHARASHTRA**



**PROJECTS DIVISION,
HLL LIFECARE LIMITED**

(A GOVT. OF INDIA ENTERPRISE)

Corporate and Registered Office:

HLL Bhavan, Poojappura,

Thiruvananthapuram – 695012, Kerala, India

Phone +91 471 2354949 / 2775500/ 2775588

Web: www.lifecarehll.com

MARCH 2018

HLL LIFECARE LIMITED

(A Government of India Enterprise)
 Projects Division
 Corporate Head Office, Poojappura.P.O,
 Thiruvananthapuram – 695012,
 Kerala, India
 Phn: 0471- 2354949, 2775588

INVITATION FOR BIDS (IFB)

IFB No : HLL/CHO/PROJ/RBD/AMRIT- MH/BJGMC-PUNE/2017-18

Date : 07-03-2018

HLL Lifecare Limited (HLL), a Government of India Enterprise is in the process of setting up of AMRIT Pharmacies at various locations in India. For the said project, sealed and super scribed bids are invited from competent and experienced Suppliers/Contractors who are capable to do the following work meeting their requirements as per our tender.

Sl. No	Brief Description of Item/Work	Qty	EMD in Rs
1	Turnkey works for setting up of AMRIT Pharmacy at BJ Govt. Medical College & Sassoon General Hospital, Pune, Maharashtra as per <u>Schedule of Work</u> enclosed.	As per Schedule V	Rs 36,000/-

2. The bid documents will be available up to 15.00 Hrs. on the previous working day of the opening of the bids. The scheduled date for issue, receipt and opening of bids is as follows.

- a) Date of issue of tender document - 07-03-2018 onwards
- b) Last date and time for receipt of bids - 21-03-2018 up to 15.00 Hrs.
- c) Date and time of opening of bids - 21-03-2018, 15.30 Hrs.
- d) Address for communication, receipt and place of opening of bids:

SENIOR MANAGER (PROJECTS),

PROJECTS DIVISION,
 HLL LIFECARE LIMITED,
 Corporate Head Office, Poojappura.P.O,
 Thiruvananthapuram – 695012, Kerala, India
 Phn: 0471- 2354949, 2775588
 E-mail: choprojects@lifecarehll.com, harikrishnankp@lifecarehll.com

3. The completed and sealed bid documents should be submitted to Senior Manager (Projects), in the above address along with the EMD. The outer cover should bear the Enquiry No, closing date and General description of item tendered, and the words “DO NOT OPEN BEFORE” 15.30 Hrs (IST) on ----- (Indicate the Closing Date). EMD shall be submitted in the form of demand draft drawn from a nationalized bank in favor of **HLL Lifecare Limited payable at Thiruvananthapuram**. Bids received after due date and time will be rejected. Any bid not accompanied by EMD will be rejected.

4. Bids will be opened in the presence of Bidders representative(s) who choose to attend on the specified date and time, at the office of HLL at the address given in Clause 2 (d) above.
5. In the event of the date specified for bid receipt and opening being declared as a closed holiday for the above purchaser's office, the due date for submission of bids and opening of bids will be the following working day at the appointed times.
6. HLL may, at its discretion, extend this deadline for submission of bids by amending the Bid Documents or any other reasons, in which case all rights and obligations of HLL and Bidders previously subject to the deadline will thereafter be subject to the deadline as extended.
7. HLL will not be held responsible for the postal delay, if any, in the delivery of the bidding document or the non-receipt of the same. Bids sent by Telex/Fax/Telegraph will not be accepted.
8. The EMD should be enclosed in a separate envelope and super scribed as "EMD" and to be attached in the main cover.
9. SSI/MSME units interested in availing exemption from payment of EMD should submit a valid copy of their registration certificate issued by the concerned DIC or NSIC / Udyog Aadhaar. But the Party has to provide Security deposit if Tender is awarded to them.
10. The bidder will be disqualified if they have any record of poor performance such as abandoning the works, not properly completing the contract, inordinate delays in completion, litigation history, or financial failures etc.
11. The Bid must include the following information;
 - a. Enquiry No.
 - b. EMD
 - c. Promised Delivery/Completion Schedule
 - d. Price Schedule in Format For Quoting
 - e. All other documents/certificate/information as specified in the bid document.
12. In addition to the invitation for bids, the bidding documents include the following schedules.

Schedule I	-	Conditions of Contract
Schedule II	-	Acceptance Form
Schedule III	-	Capability Certificate
Schedule IV	-	Performance Statement
Schedule V	-	Schedule of Works
13. The company reserves the right to club or split the items of works, change the qualifying criteria at their discretion and to reject or cancel the Invitation for bids without assigning any reason thereof.

SENIOR MANAGER (PROJECTS)

SCHEDULE I

CONDITIONS OF CONTRACT

1) PRICE

The price quoted should be inclusive of all material cost, loading and unloading charges, all applicable taxes and other levies, labor charges, insurance etc. The **Schedule of work** is enclosed as **Schedule V**.

Price quoted should be firm without any escalation till the order is completely executed.

2) TAXES/DUTIES/LEVIES

The contractor shall be entirely responsible for all applicable taxes including GST, duties, license fees etc. incurred until successful completion of contract.

3) ESCALATION

The rates quoted by the Contractor in the contract documents shall be final and shall not be subjected to any change due to the increase in labour wages or inflation in the cost of materials or any other price variations due to any reason during the stipulated time period of the contract or during the extended time period of completion.

Rates quoted should be inclusive of all cost of materials, Tools/Equipments labor charges, conveyance to site, handling charges, loading and unloading charges, hiring charges, clearing of debris, statutory payments etc.

4) COMPLETION TIME

Work should be completed within **6 WEEKS** from the date of issuing the Letter Of Intent or Work Order.

5) PAYMENT TERMS

The contractor can submit two running account bills during the work period and payment made as below:

- a) 80% of the bill value will be paid on each running account bill submitted by the contractor.
- b) Balance 20% will be paid along with the final bill only after issue of Work Completion certificate by Engineer In Charge/Officer In Charge of HLL Lifecare Ltd.

5% amount of the Bill will be retained as retention money and will be released only after the Defect liability period of 12 months.

The running account bills are to be submitted detailing the work description, quantity and rate as per the Work Order. Payment will be made against actual measurements recorded and certified jointly by HLL Engineer in charge and the Contractor's representative. For supply of capital items, duly certified delivery challan/supporting documents such as Warranty Certificates etc. shall be enclosed along with bill.

Tax Deduction: All statutory deductions like GST, Income Tax, Works Contract Tax, E.S.I., P.F. or any other government-imposed liabilities shall be borne by the Contractor (as applicable at the time of execution of job) and shall be deducted from each bill submitted by the Contractor.

6) SECURITY DEPOSIT

- 6.1 Simultaneously with the execution of the contract successful bidder shall furnish a Security deposit in the form of a Demand Draft from a nationalised bank drawn in favour of HLL Lifecare Limited, Thiruvananthapuram payable at Thiruvananthapuram or a Bank Guarantee from a nationalised bank, for an amount equal to 5% of the total contract value as Security Deposit for his faithful execution of contract. The Security deposit should be valid until successful completion of the contract and acceptance of the Equipment/works by the Purchaser/Owner and will be released after acceptance of the Equipment/works by the Purchaser/Owner. In case of a delay in the works the validity of security deposit shall be extended.
- 6.2 Within 10 days of the receipt of notification of award from the Purchaser/Owner; the successful Bidder shall furnish the security deposit in the form of a Demand Draft or Bank Guarantee in the security deposit form to be sent along with the Notification of Award.
- 6.3 Failure of the successful Bidder to accept the notification of award or submission of security deposit within the timeframe shall constitute sufficient grounds for the annulment of the award and forfeiture of the EMD, in which even the Purchaser/Owner may make the award to the next lowest evaluated bidder or call for new bids.

7) EARNEST MONEY

- 7.1 Each bid must be accompanied by E.M.D.
- 7.2 The EMD is required to protect the Purchaser/Owner against risk of Bidder's conduct, which would warrant the security's forfeiture.
- a. The EMD shall be in the form of cash deposit or demand draft from a nationalized bank drawn in favour of HLL Lifecare Limited, Thiruvananthapuram payable at Thiruvananthapuram.
 - b. E.M.D. from unsuccessful bidders will be returned after the acceptance of order by the L1 party.
 - c. In the case of successful bidder, the Earnest Money will be returned after signing the contract, and submission of Security Deposit, which they will have to offer for the faithful execution of the contract.
- 7.3 The EMD may be forfeited:
- (a) If a Bidder withdraws its bid during the period of bid validity specified by the Bidder on the Bidding Document; or
 - (b) In case of the successful Bidder, if the Bidder fails:
 - (i) to sign the Contract
 - (ii) to furnish security deposit

8) INDEMNIFICATION CLAUSE

The Bidder shall indemnify and hold harmless the Owner/Purchaser from and against the below mentioned:

- i. All claims, demands, action, proceedings, losses, damages, liabilities, cost, charges, expenses or obligations that are occasioned or may occasion to HLL as a result of our non-payment of any statutory dues levied/leviable on the Contractor or the Contractor committing breach of any the rules, regulations, orders, directives, instructions that may be issued by any authority under various Labor Laws, PF, ESI Acts and all other applicable Laws/Acts/Rules or any other Statute or Laws for the time being in force
- ii. Any damages, loss or expenses due to or resulting from any negligence or breach of duty on our part or on the part of Sub-Contractor/s, if any, servants or agents of the Bidder.
- iii. Claims, if any, of the employee or the Contractor and its Sub Contractor/s, under the Workmen's Compensation Act, 1923 and Employer's Liability Act 1938 or Various Labor Laws or any other Laws rules and regulations in force for the time being in India and any acts replacing and/or amending the same or any of the same as may be in force at the time and under any law in respect of injuries to persons or property arising out of and in the course of the execution of the contract work and / or arising out of and in the course of employment of any workmen / employee.
- iv. Any non - compliance or improper compliance of statues, rules and regulations which are applicable to HLL and also to the Contractor and to the employees , in respect of (a) Employees' Provident Fund and Miscellaneous Provision Act, 1952, (b) Employees State Insurance Act, 1948, © Contract Labor (R&A) Act, 1970 (d) Minimum Wages Act, 1948 (e) Payment of Wages Act,1936 (f) Bonus Act, 1965 (g) Workmen's Compensation Act, 1923 and / or any other laws which may become applicable in respect of the Contract/ Agreement between HLL and the Bidder.
- v. Any Act or omission by us or our Sub-contractor/s, if any, our /their servants or agents which may involve any loss, damages, liability, civil or criminal action.
- vi. To protect against all claims for damage caused due to non-obtaining of insurance policy during the project period.

9) DEFECT LIABILITY PERIOD:

The defect liability period of the work shall be 12 months from the date of completion of the work and this date will start from successful completion and handing over. If any damage or defect occurs in the work during this period then the Contractor shall rectify the damage or defect at his own expense to the satisfaction of the Purchaser/Owner. If the Contractor fails to do so, then the Purchaser/Owner shall have the authority to get the work done by other means and the expenditure incurred shall be recovered from the Contractor.

Even if Inspection and/or tests are fully carried out by Purchaser/Owner or their representatives, the Contractor is not absolved to any degree of his responsibility to ensure that all equipment fabricated comply strictly with the requirements as per specifications given in the order, and the Purchaser/Owner shall be free to point out any defect till the defect liability period is over.

10) FORCE MAJEURE

- a. Neither the Contractor nor the Purchaser/Owner shall be considered in default in the performance of their obligations as per the Contract so long as such performance is prevented or delayed because of strikes, war, hostilities, revolution, civil commotion, epidemics, accidents, fire, cyclone, flood or because of any law and order proclamation, regulation or ordinance of Government or subdivision thereof or because of any act of God. The proof of existence of force majeure shall be provided by the party claiming it to the satisfaction of the other.
- b. The Contractor shall advise Purchaser/Owner initially by a Fax, followed by post, the beginning and end of any of the above causes of delay, failing which Purchaser/Owner shall not be liable to consider delays due to the above reasons. Notice as stated above should be given even in case where only the Contractor's bids are under the consideration of the Purchaser/Owner and no acceptance of the same has been given and detailed order issued.
- c. In the event of definite delay even if arising out of reasons due to force majeure, Purchaser/Owner shall have the right at their discretion to cancel the Order or part of the Order without any liability on their part to make any payment to the Contractor while reserving the right to claim refund of and any payment if advanced or paid to Contractor.

11) DELAY IN WORK EXECUTION DUE TO REASONS BEYOND CONTRACTOR'S CONTROL

- 11.1 Force majeure: If the execution of work is delayed due to force majeure, then Purchaser/Owner as per the affected period may extend the time period.
- 11.2 In case work is delayed due to non-availability of stores supplied by Owner or any decision by Owner holding the progress of work, the contractor then upon any such happening causing delay shall immediately but not later than 10 days, give notice thereof in writing to the Owner, but nevertheless use constantly his best effort to prevent or make good delay. The Owner may in his discretion grant such extension of time as may appear reasonable to him and the same shall be communicated to the contractor in writing and shall be final and binding on him and the contractor shall be bound to complete the work within such extended time.

12) LIQUIDATED DAMAGES FOR DELAYS

If the work is not completed and handed over to the Purchaser/Owner within the time stipulated in the Order, Purchaser/Owner may at their option, either (1) recover from the Contractor liquidated damages at the rate of 0.5 % of the total contract value for every week of delay, subject to a maximum of 7.5 % of the total contract value, or (2) at the risk and cost of the Contractor and without prejudice to the other remedies/rights as per the Contract, terminate the order wholly or partially and complete it themselves or reassign it to other contractors.

13) SPECIAL INSTRUCTIONS

- 13.1 The bidder shall visit the site before quoting for the work and also take their own assessments before quoting of bids.**
- 13.2 All pages of the bid, except for un-amended printed literature shall be signed by the person or persons signing the bid. The seal of the company shall be stamped in all pages.
- 13.3 Bids shall be made in English. The bid shall contain no interlineations, erasures or overwriting except as necessary to correct errors made by the Bidder, in which case such corrections shall be signed by the person or persons signing the bid.
- 13.4 To assist in the examination, evaluation and comparison of bids, the Owner may, at its discretion, ask the bidder for a clarification of its bid. The request for clarification and the response shall be in writing and no change in the rate or substance of the bid shall be sought, offered or permitted.
- 13.5 Arithmetical errors will be rectified on the following basis. If there is a discrepancy between the unit price and the total price that is obtained by multiplying the unit price and quantity, the unit price shall prevail and the total price shall be calculated. If there is a discrepancy between the words and figures of unit price, the amount in words of unit price shall prevail.
- 13.6 Prior to the detailed evaluation, the Owner will determine the substantial responsiveness of each bid to the bidding documents. For purposes of these clauses, a substantially responsive bid is one, which conforms to specifications and all the terms and conditions of the bidding documents without material deviation. The Owner's determination of a bid's responsiveness is to be based on the contents of the bid itself without recourse to extrinsic evidence.
- 13.7 The Owner's determination as to the substantial responsiveness or otherwise of each bid or consideration of a minor informality or non-conformity or irregularity is final and conclusive.
- 13.8 The Owner reserves the right to negotiate with the lowest evaluated responsive bidder.
- 13.9 The Owner will award the Contract to the successful Bidder whose bid has been determined to be substantially responsive and has been determined as the lowest evaluated bid provided further that the Bidder is determined to be qualified to perform the Contract satisfactorily for the items offered.
- 13.10 Prior to the expiration of the period of bid validity, the Owner will notify the successful Bidder in writing by or cable or telex or fax, to be confirmed in writing by post, that its bid has been accepted. The notification of award may be sent in the form of Letter of Intent and/or Work order.
- 13.11 The signed acceptance of the notification of award by the Contractor will constitute a concluded contract.

- 13.12 The work should be carried out without causing any inconvenience to the public and shall ensure that no damages are caused to the existing site premises.
- 13.13 During the execution of work, the contractor or authorized representative should be present at site.
- 13.14 All Materials, Equipment's/ Tools required for the work should be arranged by the contractor and brought to site for the timely completion of the work.
- 13.15 The materials used shall be as per specification and of good quality.
- 13.16 The Contractor has to arrange necessary insurance coverage for the machine, workmen etc. deployed by him. He shall arrange all safety measures to protect his workmen and also the properties of HLL/Hospital Building. The work site safety of all employees, their ESI, PF etc will have to be borne by the contractor.
- 13.17 The work should be carried out in truly professional manner, neatly finished with proper line, level and plumb. Cleanliness and finishing of the job is of utmost importance. Hence the job should be done most carefully with best workmanship. For all finishing jobs samples should be approved from the Purchaser/Owner before completely executing the work.
- 13.18 The Purchaser/Owner should be immediately informed for any discrepancy in drawings, specifications and instructions in the execution of job before actual execution of particular item having discrepancy.
- 13.19 Any item found to be having been executed with poor workmanship then the Contractor shall have to rectify /reconstruct the work as specified by Purchaser/Owner. No extra charge will be admissible in such case. If CONTRACTORS fails to do so, the Purchaser/Owner reserved the right to rectify/reconstruct the work through some other agency at the expenses of Contractor.
- 13.20 The schedule of activities as submitted by the Contractor shall have to be strictly adhered to. Regular progress reports shall have to be submitted by the Contractor giving all details for monitoring of the schedule.
- 13.21 The Contractor shall make initial drawings/layouts (as per site conditions) and get it approved by HLL before execution.
- 13.22 Special care is to be taken for cleanliness of the site. After the end of day's work, the site should be cleaned immediately.
- 13.23 The Contractor shall have to co-operate with the agencies executing other works in the same area.
- 13.24 While executing the work, the Contractor shall ensure safety and security of the property of the Purchaser/Owner so as to avoid theft etc.

13.25 Measurement & Payment terms:

The method of measurement of completed work shall be in accordance with the standard measurement. Final Payment will be made on satisfactory completion of work as per the order. Interim or running account bills shall be submitted by the contractor for the work executed on the basis of such recorded measurements in the format of HLL. All such interim payments shall be regarded as payment by way of advances against final payment only, and shall not preclude the requiring of bad, unsound and imperfect or unskilled work to be rejected, removed, taken away and reconstructed or re erected. Any certificate given by the officer relating to the work done or materials delivered forming part of such payment, may be modified, or corrected by any subsequent such certificate(s) or by the final certificate and shall not by itself be conclusive evident that any work or material so which it relates is /are in accordance with the contract and certificate. Any such interim payment,/any part there of shall not in any respect conclude, determine or affect in any way powers of the engineer in charge under the contract or any of such payment s be treated as final settlement and adjustment of accounts or in any way vary or affect the contract.

13.26 If contractor is executing any extra items as per direction of Engineer in charge / Officer in charge, the rates shall be worked out as per the latest CPWD Schedule of Rates and in case, the item is not included in the CPWD schedule, the rate shall be arrived as per prevailing Market rates.

13.27 The Quantity shown in the schedule is an approximate estimated quantity. No rate revision will be entertained if the quantity increases/decreases due to the site condition while executing the work.

13.28 Water and Electricity: The contractor shall make his own arrangement for water and electricity required for the works. HLL will not be responsible for the supply of either electricity or water.

13.29 During the execution of work, the contractor or authorized representative/s at least one person having technical qualification should be present at site.

13.30 The contractor shall comply with by-laws and regulation of local and statutory authorities having jurisdiction over the work and shall be responsible for payment of all statutory fees and other charges and the giving and receiving of all necessary notices and the Owner shall be kept informed of the said compliances with by-laws, payment made, notices issued and received. All statutory payments shall be made by the Contractor and the same will be reimbursed by HLL on producing original challans/receipts.

13.31 Electrical

The work shall be carried out by a contractor holding valid licence issued by the State Government/Competent Authority for carrying out installation work of all voltage classes involved, under direct supervision of the persons holding valid certificates issued or recognized by the state government/competent authority.

13.32 Final payment shall be paid only after clearing the site as per direction of Engineer-in-charge/ Officer in charge.

14) CORRESPONDENCE

All correspondence relating to this Order shall be in English, to:

SENIOR MANAGER (PROJECTS),
PROJECTS DIVISION,
HLL LIFECARE LIMITED (A Government of India Enterprise)
Corporate Head Office, Poojappura.P.O,
Thiruvananthapuram – 695012,
Kerala, India
Phn: 0471- 2354949, 2775588
E-mail: choprojects@lifecarehll.com, harikrishnankp@lifecarehll.com

15) SETTLEMENT OF DISPUTES

Arbitration shall not be a means of settlement of any dispute or claim arising out of the contract relating to the work. Any disputes or difference arising between the parties with respect to the performance of any part of this agreement or any thing connected therewith, etc shall as far as possible be mutually settled by the process of dialog and negotiation.

The Courts at Thiruvananthapuram alone shall have jurisdiction in respect of settlement of any matter arising out or in connection with the contract.

SCHEDULE II

ACCEPTANCE FORM

(To be submitted in the letter pad of the firm indicating full name and address, telephone & fax numbers etc.)

From

To

SENIOR MANAGER (PROJECTS),
PROJECTS DIVISION,
HLL LIFECARE LIMITED (A Government of India Enterprise)
Corporate Head Office, Poojappura.P.O,
Thiruvananthapuram – 695012,
Kerala, India
Phn: 0471- 2354949, 2775588
E-mail: choprojects@lifecarehll.com, harikrishnankp@lifecarehll.com

Dear Sir,

I / We, hereby offer to supply/construct/erect/install/commission the work as detailed in schedules/drawings hereto or such portion thereof as you may specify in the acceptance of Bid at the price given in the price bid and agree to hold this offer open till 90 days after the date of bid opening prescribed by the purchaser/Owner. I/We have understood the terms and conditions mentioned in the invitation for bid and Conditions of Contract furnished by you and have thoroughly examined the specifications quoted in the bid document/drawings hereto and are fully aware of the nature of the scope of work required and my/our offer is to comply strictly in accordance with the requirement and the terms and conditions mentioned above.

Yours faithfully,

SIGNATURE OF THE BIDDER

SCHEDULE III

CAPABILITY CERTIFICATE

(To be submitted in the letter pad of the firm indicating full name and address, telephone & fax numbers etc.)

I/We have the financial capability to execute the work and complete the same within the specified time period (6 weeks). The delay, if any, in taking measurements, certification of bills, submission of bills and release of payments will not affect the progress and completion of work. I have read all the terms and conditions of the tender document including payment terms and confirm my acceptance of the same.

SIGNATURE OF THE BIDDER WITH SEAL

SCHEDULE IV

PROFORMA FOR PERFORMANCE STATEMENT

Proforma for Performance Statement (for a period of last 3 year)

Name of the Tenderer:.....

Name & Address of the Tenderer / Service Provider:.....

.....

Order placed by <i>(Full Address of Company / Consignee)</i>	Order No. and Date	Description and quantity of ordered work and service	Value of order	Date of Completion of Contract		Remarks indicating reasons for delay, if any	Have the works been satisfactorily completed? <i>(Attach a documentary proof from the client)</i>
				As per Contract	Actual		

We hereby certify that if at any time, information furnished by us is proved to be false or incorrect, we are liable for any action as deemed fit by the Company in addition to forfeiture of earnest money.

Signature and Seal of the Bidder

.....

SCHEDULE V					
SCHEDULE OF WORK					
Sub:	Turnkey works for setting up of AMRIT Pharmacy at at BJ Govt. Medical College & Sassoon General Hospital ,Pune , Maharashtra				
Item no.	Specification	Quantity	Unit	Rate	Amount
	CIVIL WORKS				
	Earth Works				
1	Clearing jungle including uprooting of rank vegetation, grass, brush wood, trees and saplings of girth up to 30 cm measured at a height of 1 m above ground level and removal of rubbish up to a distance of 50 m outside the periphery of the area cleared.	85.00	Sqm		
2	Clearing grass and removal of the rubbish up to a distance of 50 m outside the periphery of the area cleared.	75.00	Sqm		
3	Earth work in surface excavation not exceeding 30 cm in depth but exceeding 1.5 m in width as well as 10 sqm on plan including getting out and disposal of excavated earth upto 50 m and lift upto 1.5 m, as directed by Engineer-in-Charge: All kinds of soil	63.00	Sqm		
4	Earth work in excavation by mechanical means (Hydraulic excavator) / manual means in foundation trenches or drains (not exceeding 1.5 m in width or 10 sqm on plan), including dressing of sides and ramming of bottoms, lift upto 1.5 m, including getting out the excavated soil and disposal of surplus excavated soil as directed, within a lead of 50 m. All kinds of soil.	9.00	Cum		
5	Filling earth (excluding rock) in trenches, plinth, sides of foundations etc. in layers not exceeding 20cm in depth, consolidating each deposited layer by ramming and watering, lead up to 50 m and lift upto 1.5 m.	13.00	Cum		
6	Extra for carriage of Earth by Mechanical Transport including loading, unloading and stacking, above 50 metre and up to 5 Km lead.	6.00	Cum		
7	Supply / injecting / Spraying Herbal Anti-Termite Treatment AT - CT (Construction Treatment) as per Manufacturer's Instruction. Using Oslin AT @ 0.13 ltr/sqm	38.00	Sqm		
	Masonry Works				
8	Random rubble masonry with hard stone in foundation and plinth including levelling up with cement concrete 1:6:12 (1 cement : 6 coarse sand : 12 graded stone aggregate 20 mm nominal size) upto plinth level with : Cement mortar 1:6 (1 cement : 6 coarse sand)	8.50	Cum		
9	Brick work with common burnt clay F.P.S. (non modular) bricks of class designation 7.5 in superstructure above plinth level up to floor V level in all shapes and sizes in :Cement mortar 1:4 (1 cement : 4 coarse sand)	16.50	Cum		

SCHEDULE V					
SCHEDULE OF WORK					
Sub:	Turnkey works for setting up of AMRIT Pharmacy at at BJ Govt. Medical College & Sassoon General Hospital ,Pune , Maharashtra				
Item no.	Specification	Quantity	Unit	Rate	Amount
Concrete Works					
10	Providing and laying in position cement concrete of specified grade excluding the cost of centering and shuttering - All work up to plinth level : 1:5:10 (1 cement : 5 fine sand : 10 graded stone aggregate 40 mm nominal size).	6.00	Cum		
11	Providing and laying damp-proof course 50mm thick with cement concrete 1:2:4 (1 cement : 2 coarse sand(zone-III) : 4 graded stone aggregate 20mm nominal size).	13.00	Sqm		
12	Reinforced cement concrete work in beams, suspended floors, roofs having slope up to 15° landings, balconies, shelves, chajjas, lintels, bands, plain window sills, staircases and spiral stair cases above plinth level up to floor five level, excluding the cost of centering, shuttering, finishing and reinforcement, with 1:1.5:3 (1 cement : 1.5 coarse sand (zone-III) : 3 graded stone aggregate 20 mm nominal size). cum	1.50	Cum		
13	Centering and shuttering including strutting, propping etc. and removal of form for all heights :				
13.1	Lintels, beams, plinth beams, girders, bressumers and cantilevers	18.00	Sqm		
13.2	Suspended floors, roofs, landings, balconies and access platform	2.00	Sqm		
14	Steel reinforcement for R.C.C. work including straightening, cutting, bending, placing in position and binding all complete above plinth level. Thermo-Mechanically Treated bars of grade Fe-500 D or more.	160.00	Kg		
15	Making plinth protection 50mm thick of cement concrete 1:3:6 (1 cement : 3 coarse sand : 6 graded stone aggregate 20 mm nominal size) over 75mm thick bed of dry brick ballast 40 mm nominal size, well rammed and consolidated and grouted with fine sand, including necessary excavation, levelling & dressing & finishing the top smooth.	15.00	Sqm		
Roof Works					
16	Steel work in built up tubular (round, square or rectangular hollow tubesetc.) trusses etc., including cutting, hoisting, fixing in position and applying a priming coat of approved steel primer, including welding and bolted with special shaped washers etc. complete. Hot finished welded type tubes	780.00	Kg		
17	Structural steel work of factory made MS Holding down foundation bolts including nuts and washer plates of any dia including necessary threading and machining.	20.00	Kg		

SCHEDULE V					
SCHEDULE OF WORK					
Sub:	Turnkey works for setting up of AMRIT Pharmacy at at BJ Govt. Medical College & Sassoon General Hospital ,Pune , Maharashtra				
Item no.	Specification	Quantity	Unit	Rate	Amount
18	Providing and fixing precoated galvanised iron profile sheets (size, shape and pitch of corrugation as approved by Engineer-in-charge) 0.50 mm (+ .05 %) total coated thickness with zinc coating 120 grams per sqm as per IS: 277, in 240 mpa steel grade, 5-7 microns epoxy primer on both side of the sheet and polyester top coat 15-18 microns. Sheet should have protective guard film of 25 microns minimum to avoid scratches during transportation and should be supplied in single length upto 12 metre or as desired by Engineerin-charge. The sheet shall be fixed using self drilling /self tapping screws of size (5.5x 55 mm) with EPDM seal, complete upto any pitch in horizontal/ vertical or curved surfaces, excluding the cost of purlins, rafters and trusses and including cutting to size and shape wherever required.	73.00	Sqm		
19	Providing and fixing precoated galvanised steel sheet roofing accessories 0.50 mm (+ 0.05 %) total coated thickness, Zinc coating 120 grams per sqm as per IS: 277, in 240 mpa steel grade, 5-7 microns epoxy primer on both side of the sheet and polyester top coat 15-18 microns using self drilling/ self tapping screws complete :				
19.1	Ridges plain (500 - 600mm)	24.00	Metre		
19.2	North light curves .	10.00	Metre		
	Finishing Works				
20	12 mm cement plaster of mix : 1:4 (1 cement: 4 fine sand)	73.00	Sqm		
21	15 mm cement plaster on the rough side of single or half brick wall of mix : 1:4 (1 cement: 4 fine sand)	70.00	Sqm		
22	6 mm cement plaster of mix : 1:3 (1 cement : 3 fine sand) sqm 143.80	2.00	Sqm		
23	Add for plaster drip course/ groove in plastered surface or moulding to R.C.C. projections. metre	10.00	Metre		
24	Providing and applying plaster of paris putty of 2 mm thickness over plastered surface to prepare the surface even and smooth complete.	74.00	Sqm		
25	Applying one coat of water thinnable cement primer of approved brand and manufacture on wall surface : Water thinnable cement primer	130.00	Sqm		
26	Finishing walls with Acrylic Smooth exterior paint of required shade : New work (Two or more coat applied @ 1.67 ltr/10 over and including priming coat of exterior primer applied @ 2.20 kg/10 sqm) sqm	71.00	Sqm		
27	Wall painting with acrylic emulsion paint of approved brand and manufacture to give an even shade : Two or more coats	60.00	Sqm		

SCHEDULE V					
SCHEDULE OF WORK					
Sub:	Turnkey works for setting up of AMRIT Pharmacy at at BJ Govt. Medical College & Sassoon General Hospital ,Pune , Maharashtra				
Item no.	Specification	Quantity	Unit	Rate	Amount
28	Painting with synthetic enamel paint of approved brand and manufacture to give an even shade :Two or more coats	2.00	Sqm		
29	Providing and laying vitrified floor tiles in different sizes (thickness to be specified by the manufacturer) with water absorption less than 0.08% and conforming to IS : 15622, of approved make, in all colours and shades,laid on 20mm thick cement mortar 1:4 (1 cement : 4 coarse sand), including grouting the joints with white cement and matching pigments etc.,complete:Size of Tile 600x600 mm	44.00	Sqm		
30	Providing and laying Vitrified tiles in different sizes (thickness to be specified by manufacturer), with water absorption less than 0.08 % and conforming to I.S. 15622, of approved make, in all colours & shade, in skirting, riser of steps, over 12 mm thick bed of cement mortar 1:3 (1 cement: 3 coarse sand), jointing with grey cement slurry @ 3.3kg/sqm including grouting the joint with white cement & matching pigments etc. complete. Size of Tile 600x600 mm	4.00	Sqm		
31	Providing and fixing 18 mm thick gang saw cut, mirror polished, premoulded and prepolished, machine cut for kitchen platforms, vanity counters, window sills , facias and similar locations of required size, approved shade, colour and texture laid over 20 mm thick base cement mortar 1:4 (1 cement : 4 coarse sand), joints treated with white cement, mixed with matching pigment, epoxy touch ups, including rubbing, curing, moulding and polishing to edges to give high gloss finish etc. complete at all levels. Granite of any colour and shade .Area of slab over 0.50 sqm	2.00	Sqm		
32	Providing edge moulding to 18 mm thick marble stone counters, Vanities etc., including machine polishing to edge to give high gloss finish etc. complete as per design approved by Engineer-in-Charge.Granite work	8.00	Metre		

SCHEDULE V**SCHEDULE OF WORK**

Sub:	Turnkey works for setting up of AMRIT Pharmacy at at BJ Govt. Medical College & Sassoon General Hospital ,Pune , Maharashtra				
Item no.	Specification	Quantity	Unit	Rate	Amount
33	<p>Providing and fixing tiled false ceiling of approved materials of size 595x595 mm in true horizontal level, suspended on inter locking metal grid of hot dipped galvanized steel sections (galvanized @ 120 grams/ sqm, both side inclusive) consisting of main “T” runner with suitably spaced joints to get required length and of size 24x38 mm made from 0.30 mm thick(minimum) sheet, spaced at 1200 mm center to center and cross “T” of size 24x25 mm made of 0.30 mm thick (minimum) sheet, 1200 mm long spaced between main “T” at 600 mm center to center to form a grid of 1200x600 mm and secondary cross “T” of length 600 mm and size 24x25 mm made of 0.30 mm thick (minimum) sheet to be interlocked at middle of the 1200x600 mm panel to form grids of 600x600 mm and wall angle of size 24x24x0.3 mm and laying false ceiling tiles of approved texture in the grid including, required cutting/making, opening for services like diffusers, grills, light fittings, fixtures, smoke detectors etc. Main “T” runners to be suspended from ceiling using GI slotted cleats of size 27 x 37 x 25 x1.6 mm fixed to ceiling with 12.5 mm dia and 50 mm long dash fasteners, 4mm GI adjustable rods with galvanised butterfly level clips of size 85 x 30 x 0.8 mm spaced at 1200 mm center to center along main T, bottomexposed width of 24 mm of all T-sections shall be pre-painted with polyester paint, all complete for all heights as per specifications, drawings and asdirected by Engineer-in-charge.</p> <p>12.5 mm thick square edge PVC Laminated Gypsum Tile of size 595x595 mm, made of Gypsum plasterboard,manufactured from natural gypsum as per IS 2095 part I and laminated with white 0.16mm thick fire retardant PVC film on the face side and 12micron metalized polyester on the back side with all edges sealed with the face side PVC film which goes around and wraps the edges and is bonded to the edges and the back side metalized polyester film so as to make the tile a completely sealed unit.</p>	37.00	Sqm		

SCHEDULE V					
SCHEDULE OF WORK					
Sub:	Turnkey works for setting up of AMRIT Pharmacy at at BJ Govt. Medical College & Sassoon General Hospital ,Pune , Maharashtra				
Item no.	Specification	Quantity	Unit	Rate	Amount
34	Providing and laying 60mm thick factory made cement concrete interlocking paver block of M -30 grade made by block making machine with strong vibratory compaction, of approved size, design & shape, laid in required colour and pattern over and including 50mm thick compacted bed of coarse sand, filling the joints with line sand etc. all complete as per the direction of Engineer-in-charge.	13.00	Sqm		
	Door Works				
35	Providing and fixing in position factory made precast RCC M 40 Fixing with hold fast embedded in 1:3:6 concrete block doors and windows frames having smooth finish as per IS: 6523 with reinforcement of 3 Nos, 6 mm dia main bars tied with 3 mm M.S stirrups placed @ 200 mm C/C and 6 numbers high strength polymer blocks of required size for fixing hinges including providing 6 no specially designed M.S. galvanised sleeves for accomodating 6 mm dia fully threaded bolts for fixing hold fast on vertical members, providing suitable arrangement for receiving sliding door bolts and tower bolt etc. all complete, as per the direction of Engineer in charge. The frame shall be measured in running meter correct to two places of decimal.Door frame of size100 mmx 60 mm	6.00	Metre		
36	Providing and fixing ISI marked flush door shutters conforming to IS : 2202 (Part I) decorative type, core of block board construction with frame of 1st class hard wood and well matched teak 3 ply veneering with vertical grains or cross bands and face veneers on both faces of shutters. 35 mm thick including ISI marked S tainless Steel butt hinges with necessary screws .	2.00	Sqm		
37	Providing and fixing bright finished brass night latch of approved quality including necessary screws etc. complete.	1.00	Each		
38	Providing and fixing bright finished brass handles with screws etc. complete: 125 mm	2.00	Each		
39	Providing and fixing aluminium hanging floor door stopper, ISI marked, anodised (anodic coating not less than grade AC 10 as per IS : 1868) transparent or dyed to required colour and shade, with necessary screws etc. complete.Twin rubber stopper	1.00	Each		

SCHEDULE V					
SCHEDULE OF WORK					
Sub:	Turnkey works for setting up of AMRIT Pharmacy at at BJ Govt. Medical College & Sassoon General Hospital ,Pune , Maharashtra				
Item no.	Specification	Quantity	Unit	Rate	Amount
40	Providing and fixing aluminium extruded section body tubular type universal hydraulic door closer (having brand logo with IS : 3564, embossed on the body , door weight upto 36 kg to 80 kg and door width from 701 mm to 1000 mm), with double speed adjustment with necessary accessories and screws etc. complete.	1.00	Each		
41	Providing and fixing aluminium tower bolts, ISI marked, anodised (anodic coating not less than grade AC 10 as per IS : 1868) transparent or dyed to required colour or shade, with necessary screws etc. complete : 300x10 mm	2.00	Each		
	Alluminium Works				
42	Providing and fixing aluminium work for doors, windows, ventilators and partitions with extruded built up standard tubular sections/ appropriate Z sections and other sections of approved make conforming to IS: 733 and IS: 1285, fixing with dash fasteners of required dia and size, including necessary filling up the gaps at junctions, i.e. at top, bottom and sides with required EPDM rubber/ neoprene gasket etc. Aluminium sections shall be smooth, rust free, straight, mitred and jointed mechanically wherever required including cleat angle, Aluminium snap beading for glazing / paneling, C.P. brass / stainless steel screws, all complete as per architectural drawings and the directions of Engineer-in-charge. (Glazing and paneling to be paid for separately) :For fixed portion:Powder coated aluminium (minimum thickness of powder coating 50 micron)	20.00	Kg		
43	Providing and fixing glazing in aluminium door, window, ventilator shutters and partitions etc.withEPDM rubber / neoprene gasket etc.complete as per the architectural drawings and the directions of Engineer-in-charge. With float glass panes of 8 mm thickness .	4.00	Sqm		
44	Filling the gap in between aluminium frame & adjacent RCC/ Brick/ Stone work by providing weather silicon sealant over backer rod of approved quality as per architectural drawings and direction of Engineer-in-charge complete.Upto 5mm depth and 5 mm width	9.00	Metre		

SCHEDULE V					
SCHEDULE OF WORK					
Sub:	Turnkey works for setting up of AMRIT Pharmacy at at BJ Govt. Medical College & Sassoon General Hospital ,Pune , Maharashtra				
Item no.	Specification	Quantity	Unit	Rate	Amount
Rolling Shutter Works					
45	Supplying and fixing rolling shutters of approved make, made of required size M.S. laths, interlocked together through their entire length and jointed together at the end by end locks, mounted on specially designed pipe shaft with brackets, side guides and arrangements for inside and outside locking with push and pull operation complete, including the cost of providing and fixing necessary 27.5 cm long wire springs manufactured from high tensile steel wire of adequate strength conforming to IS: 4454 - part 1 and M.S. top cover of required thickness for rolling shutters. 80x1.25 mm M.S. laths with 1.25 mm thick top cover	7.00	Sqm		
46	Providing and fixing sufficient ball bearing for rolling shutters.	2.00	Each		
ELECTRICAL WORKS					
47	Point wiring in PVC conduit, with Modular type switch: Wiring for light point/ fan point/ exhaust fan point/ call bell point with 1.5 sq.mm FRLS PVC insulated copper conductor single core cable in surface / recessed medium class PVC conduit, with modular switch, modular plate, suitable GI box and earthing the point with 1.5 sq.mm. FRLS PVC insulated copper conductor single core cable etc as required - Group C(Recommended Makes: RRKabel/National/Ralison/RKG/Finolex/Polycab / Havells)	29.00	Point		
48	Wiring for light/ power plug with 2X4 sq. mm FRLS PVC insulated copper conductor single core cable in surface/ recessed medium class PVC conduit alongwith 1 No. 4 sq. mm FRLS PVC insulated copper conductor single core cable for loop earthing as required. (Recommended Material : Polycab, RR Kabel, V Guard, Havells)	150.00	Metre		
49	Wiring for circuit/ submain wiring alongwith earth wire with the following sizes of FRLS PVC insulated copper conductor, single core cable in surface/ recessed medium class PVC conduit as required.(Recommended Material : RR Kabel/National/Ralison/RKG/Finolex/Polycab / Havells)				
49.1	2 X 1.5 sq. mm + 1 X 1.5 sq. mm earth wire	80.00	Metre		
49.2	2 X 2.5 sq. mm + 1 X 2.5 sq. mm earth wire	40.00	Metre		

SCHEDULE V					
SCHEDULE OF WORK					
Sub:	Turnkey works for setting up of AMRIT Pharmacy at at BJ Govt. Medical College & Sassoon General Hospital ,Pune , Maharashtra				
Item no.	Specification	Quantity	Unit	Rate	Amount
50	Supplying and fixing of following sizes of medium class PVC conduit (ISI brand) along with accessories in surface/recess including cutting the wall and making good the same in case of recessed conduit as required .: 25 mm	40.00	Metre		
51	S/F light plug point modular type accessories : Supplying and fixing suitable size GI box with modular plate and cover in front on surface or in recess, including providing and fixing 3 pin 5/6 amps modular socket outlet and 5/6 amps modular switch, connection,painting etc as required,	8.00	Each		
52	S/F Power plug point with modular type switch : Supplying and fixing suitable size GI box with modular plate and cover in front on surface or in recess, including providing and fixing 6 pin 15/16 and 15/16 amps modular switch, connection,painting etc as required.	5.00	Each		
53	S/F 20A SPN MCB industrial socket outlet : Supplying and fixing 20 A, 240 V, SPN Industrial type socket outlet, with 2 pole and earth, metal enclosed plug top alongwith 20 A, "C" curve, SP, MCB, in sheet steel enclosure, on surface or in recess, with chained metal cover for the socket outlet and complete with connections, testing and commissioning etc. as required.	2.00	Each		
54	S/F Modular boxes, base & cover plate : Supplying and fixing 1 or 2 module (75 mmx75 mm),GI box along with modular base, cover plate for modular switches in recess etc as required.	8.00	Each		
55	Supply and fixing of RJ-45 socket outlet , including all and as per the instructions of Engineer in Charge.	8.00	Each		
56	Supplying and drawing of UTP 4 pair CAT 6 LAN Cable in the existing surface/ recessed Steel/ PVC conduit as required. 1 run of cable	130.00	Metre		
MCCB, MCB & DB'S					
57	Supplying and fixing following way, single pole and neutral, sheet steel, MCB distribution board, 240 V, on surface/ recess, complete with tinned copper bus bar, neutral bus bar, earth bar, din bar, interconnections, powder painted including earthing etc. as required. (But without MCB/RCCB/Isolator) 8 way, Double door	1.00	Each		

SCHEDULE V					
SCHEDULE OF WORK					
Sub:	Turnkey works for setting up of AMRIT Pharmacy at at BJ Govt. Medical College & Sassoon General Hospital ,Pune , Maharashtra				
Item no.	Specification	Quantity	Unit	Rate	Amount
58	Supplying and fixing following way, horizontal type three pole and neutral, sheet steel, MCB distribution board, 230 V, on surface/ recess, complete with tinned copper bus bar, neutral bus bar, earth bar, din bar, interconnections, powder painted including earthing etc. as required. 4 way (4 + 12), Double door	1.00	Each		
59	S/F 'C' series, MCB : Supplying and fixing 5 amps to 32 amps rating, 240/415 volts, "C" curve, miniature circuit breaker suitable for inductive load of following poles in the existing MCB DB complete with connections, testing and commissioning etc. as required.				
59.1	Single pole	15.00	Each		
59.2	Single pole and neutral	1.00	Each		
60	Supplying and fixing following rating, four pole, (three phase and neutral), 415 V, residual current circuit breaker (RCCB), having a sensitivity current 30 mA in the existing MCB DB complete with connections, testing and commissioning etc. as required. 63A	1.00	Each		
61	Supplying and fixing Cable End Box (Loose wire box)(IP 43) suitable for following triple pole and neutral, sheet steel, MCB distribution board, 415 V, on surface/ recess, complete with testing and commissioning etc. as required. For 4 way, Double door TPN MCBDB	1.00	Each		
62	Supplying and fixing Cable End Box (Loose wire box)(IP 43) suitable for following single pole and neutral, sheet steel, MCB distribution board, 240 V, on surface/ recess, complete with testing and commissioning etc. as required. For 8 way, Double door SPN MCBDB	1.00	Each		
LIGHT /FAN FITTINGS					
63	Supply, installation, testing and commissioning of the following types of light fittings with all accessories on false ceiling, true ceiling or wall as directed and giving connections with 16/0.20 mm 3 core PVC insulated and sheathed round copper conductor flex wire or extending the original wiring and giving connections as required. All recessed type fixtures are to be supported independently with chains or GI wire anchored to the ceiling with anchoring bolt of necessary size. All loose wires above the false ceiling are to be neatly concealed by flexible metal/pvc conduits.(cost to include lamps & all consumables also)				

SCHEDULE V					
SCHEDULE OF WORK					
Sub:	Turnkey works for setting up of AMRIT Pharmacy at at BJ Govt. Medical College & Sassoon General Hospital ,Pune , Maharashtra				
Item no.	Specification	Quantity	Unit	Rate	Amount
63.1	15W 4000k LED luminaire with High translucent diffuser gives soft glare free light & complete with electronic driver including all required mounting accessories complete.(Havells DIVA (RECESS) - 15W or equivalent)	15.00	Each		
63.2	1x18W T8 slim type tube fitting with decorative end caps. (Havells , Philips, Bajaj or equivalent)	10.00	Each		
	FAN				
64	Supply, Installation, testing and commissioning of wall mount fan (400mm sweep), adjustable speed . min 60 degree oscillation, swing, Adjustable upward and downward tilt mechanism, Protective Guard, Including connections with 1.5 sq. mm FRLS PVC insulated, copper conductor, single core cable, mounting accessories, etc. as required. It shall be double ball bearing type. (Make : USHA, Crompton , Havells)	2.00	Nos.		
	METERING				
65	Supply, Installation, testing & commissioning of 3 phase 4 wire electronic type energy meter with LCD display with battery back up, class 1.00 CT with inbuilt CT. The whole unit to be mounted on suitable metal enclosure (powder coated with locking arrangement, seperate enclosure for incoming and outgoing) with 3 Nos. HRC fuses, Neutral Link and all connections complete.	1.00	Set		
	CABLE / EARTHING				
66	Earthing with G.I. earth pipe 4.5 meter long, 40 mm dia including accessories, and providing masonry enclosure with cover plate having locking arrangement and watering pipe etc. with charcoal/ coke and salt as required.	1.00	Each		
67	Providing and fixing 4.00 mm dia copper wire on surface or in recess for loop earthing as required.	80.00	Metre		
68	Supply and laying of following size 1.1 KV grade XLPE insulated, PVC sheathed, armoured Aluminium conductor power cable conforming to IS 7098 (Part 1) amended upto date.(including termination on both ends, laying as per site condition) 4C x 10 Sq.mm	40.00	Metre		
	CCTV-SECURITY SYSTEM				
	Supply ,Installation ,Testing & commissioning of the following items :				
69	Indoor IR Dome camera : 1/3" CCD or equiv, 1.0 lux,AWB / BLC / AGC , min 20m range, Built-in IR illumination, white color case, PAL-CE/FCC approved., make CP PLUS or equivalent	4.00	Nos.		

SCHEDULE V					
SCHEDULE OF WORK					
Sub:	Turnkey works for setting up of AMRIT Pharmacy at at BJ Govt. Medical College & Sassoon General Hospital ,Pune , Maharashtra				
Item no.	Specification	Quantity	Unit	Rate	Amount
70	Outdoor IR Bullet camera : 1/3" CCD or equivalent, 1.0 lux,AWB / BLC / AGC , ,min 20m range,Built-in IR illumination, white color case, DC12V, PAL-CE/FCC approved., make CP Plus or equivalent	2.00	Nos.		
71	Power supply unit for above camera as specified by camera manufacturer -12VDC 10A	1.00	Nos.		
72	Digital Video Recorder : 8-Channel Embedded HD DVR, 400fps, Real-time, with 2 TB HDD and English OSD, 230VAC. Rate shall be inclusive of all accessories, termination of cables, etc complete.	1.00	Nos.		
73	Supply and fixing of 18" LED Color Monitor for CCTV including all and as per the instruction of Engineer in Charge . Make (LG/Samsung)	1.00	Nos.		
74	Supply and Laying of RG-6 Coaxial video cable with ISI marked PVC conduit including terminations with suitable BNC, etc complete. Make : Technoflex/Neolex/Finolex	160.00	Metre		
CAPITAL ITEMS					
75	SIT of 2 KVA Online UPS Systems of the following specifications :- True on - line 2 KVA UPS system. Inversion shall be Microprocessor controlled with instantaneous sine wave Control using IGBT. UPS shall have standard display features, alarms, safeties, etc Input Voltage range : A.C 235 V (+15% to -20%), 1 phase Input Frequency : 50 HZ (+/- 3HZ) Power Factor : 0.9 or above. THD : less than 5% ; Ripple Voltage in battery terminal : less than 2% DC Voltage Minimum Back up time : Continuous 60 Mins at full load Rectifier shall be Full wave Type (Shall fully meet the specified input power requirements) Battery Type : SMF	1	Job		
76	Desktop Computers (Server type) : Supply and Installation at site ,all in one Desktop Computer (Business PC)- Core i3, 4GB RAM, 1 TB, DVD RW, 19.5" Screen,10/100/1000 Gigabyte LAN, Win 10 PRO down gradable to Windows 8.1, Wired keyboard and mouse , 3 Years Warranty with WPS Office Version 10 or higher/Open Office preloaded. Recommended Make: HP, ASUS, DELL, ACER, LENOVO	1	Set		

SCHEDULE V**SCHEDULE OF WORK**

Sub:	Turnkey works for setting up of AMRIT Pharmacy at at BJ Govt. Medical College & Sassoon General Hospital ,Pune , Maharashtra				
Item no.	Specification	Quantity	Unit	Rate	Amount
77	Desktop Computers (User type) : Supply and installation at site, all in one Desktop Computer (Business PC) - Intel Dual core CPU 3.2Ghz or higher, 4GB RAM, 500 GB HDD, DVD RW, 19.5" Screen,10/100/1000 Gigabyte LAN, Win 10 PRO downgradable to Windows 8.1, Wired keyboard and mouse ,3 Years Warranty with WPS Office Version 10 or higher/Open Office preloaded. Recommended Make: HP, ASUS, DELL, ACER, LENOVO	3	Set		
78	Monochrome Laser Printer: Supply and Installation at site Monochrome Laser Printer as per the following specifications: Print Resolution: 600 x 600 dpi, Print Speed: Up to 14 ppm (mono), Print Cartridge: HP LaserJet Print Cartridge Print Technology: Laserjet, Connectivity: Hi-speed USB 2.0 Supported Media Types: Paper, envelopes, labels, cardstock, transparencies, postcards, Functionality: Print Power Consumption: Maximum 250 Watts Model : HP 1020Plus or equivalent	2	Set		
79	Ink tank Multi functional Printer Supply and Installation at site Multi functional Printer as per the following specifications: Ink tank Multi functional Printer, for Bill Printing cum Office use with Warranty period of one year. Print Technology: Inkjet, Connectivity: Hi-speed USB 2.0 Supported Media Types: Paper, envelopes, labels, cardstock, transparencies, postcards, Functionality: Print, Scan/Copy. Power Consumption: Maximum 250 Watts Recommended Make: EPSON M200/HP GT5810/Canon G2000	1	Set		
80	Domestic Refrigerator Standard single door refrigerator of minimum 185 Litres capacity (~20 ltrs. Freezer capacity) , Free standing, BEE 3 star rated or more, Stabilizer free operation on 230V AC Supply, minimum 3 nos. adjustable racks, with suitable voltage stabilizer, Manufacturer Warranty : Min. 5 Years for Compressor, Min.1 year for product. Make: LG, HAIER, SAMSUNG or equivalent	1	No.		

SCHEDULE V					
SCHEDULE OF WORK					
Sub:	Turnkey works for setting up of AMRIT Pharmacy at at BJ Govt. Medical College & Sassoon General Hospital ,Pune , Maharashtra				
Item no.	Specification	Quantity	Unit	Rate	Amount
81	Supply, installation, testing and commissioning of Air Cooled High Wall mounted Split Air Conditioner of following capacity consisting of high wall mounted type room unit (fan coil) with cordless remote control and one number outdoor condensing unit comprising of enegy efficient suitable rotary compressor for operation on single phase, 230 V, 50Hz supply, fixing the outdoor unit on a raised platform as per manufacturers recommendation and fixing of room (fan coil) unit on wall, standard 4 m distance refrigerant copper piping with 13mm nitrile rubber insulation, providing and making interconnection between room & condenser as per site conditions, comprising of 1" dia drain PVC pipe with insulation 4m, canvas connections, full electrical cabling from power plug near indoor unit and to outdoor unit, ODU MS stand, first charge refrigerant gas, suitable stabilizer etc complete as required. (Make : Voltas , Blue Star, Siemens, Hitachi) : 2 TR 3 star rated as per BEE	2	Nos		
82	Cash Counting Machine cum Fake Note Detector Make : Optimus-Model No.OLC 04 or equivalent	1.00	Each		
83	Cash Safe (Coffer) Volume. 14 L Min WallThickness: 2.5 mm min for body and 5 mm min for door Recommended Make: Godrej make, Model No. Premium Coffer BRN (Item Code: SEBP 1112) or equivalent (only manual locking system)	1.00	Each		
COUNTER AND FURNITURE					
84	COUNTER: Single level Counter, Level at 750 mm from ground and 600 mm depth. 8mm Thk WPC sheet to be used for counter top on 18mm thick commercial ply. Under counter storage unit to be fixed with individual locks and handles as per drawing, 600mm wide laminated door and Cash drawer of suitable design is to be installed including handle, lock and drawer channel.The rate is inclusive of painting,putty etc.which are necessary for the counter .Make PLYWOOD: Commercial. LAMINATE:GREENLAM, MARINO OR EQUIVALANT. Note: Only front elevation will be measured.	4.00	Sqm		

SCHEDULE V					
SCHEDULE OF WORK					
Sub:	Turnkey works for setting up of AMRIT Pharmacy at at BJ Govt. Medical College & Sassoon General Hospital ,Pune , Maharashtra				
Item no.	Specification	Quantity	Unit	Rate	Amount
85	Counter Height Stools : Supply and installation at site counter height stools of following specifications :Revolving adjustable Chrome plated steel body chairs with resistance to the corrosion. Cushion Seat with Lift mechanism for Adjustment of height. Minimum height 750mm before expansion. Medium Back rest and arm rest. Item shall be of reputed make.	4.00	Nos.		
86	Supply of Working Table of minimum size 900mmX 600mm with at least one drawer with lock and handle and storage space with swing door ,lock and handle . Table made with 18mm thick Plywood / Particle board having both side lamination with sufficient supports,edge beedings,painting if requered etc including all accesories complete and as per the instruction of Engineer in charge	1.00	Nos		
87	Supply of Revolving height adjustable chair :Medium back ergonomic chair with five nos. star shaped Nylon base. Castors: 50mm diameter nylon twin wheel, gas lift height adjustment, back angle adjustment and backrest height adjustment. Fixed armrest providing natural resting for arms. Seat with PU cutted foam backed fabric, back rest with mesh type fabric, Upholstery: Heavy duty rubber backed fabric in BLACK. Item shall be of reputed make.	2.00	Nos.		
88	Top & Bottom Cabinets Sliding with MS Shelves: Providing and Fixing Medical Store display cabinets with storage unit made of high-quality Steel, with powder coated aluminum section door for sliding and Glass shatters with proper provision of racks and shelves. Aluminium Channel Sliding with 6mm glass / Aluminium window sliding with 4mm thick glass. Top Cabinet Size (Min): H-120cm D-40cm and No of Shelves 3Nos+ Base. Bottom Cabinet Size (Min): H-100cm D-60cm and No of Shelves 2Nos+ Base Maximum height of the cabinet is depending upon the available height at the location. Shelves to be fix with proper bracket holders. Note: Only front elevation will be measured.	25.00	Sqm		

SCHEDULE V
SCHEDULE OF WORK

Sub: Turnkey works for setting up of AMRIT Pharmacy at at BJ Govt. Medical College & Sassoon General Hospital ,Pune , Maharashtra

Item no.	Specification	Quantity	Unit	Rate	Amount
89	Slotted angle metallic rack made up of 40 X 40 X 3 mm size rolled steel Angle posts shall have 8-mm diameter holes provided at 50-mm centres. The holes shall start at 12.5 mm centres from each end. Metal shelves shall be made from mild steel sheets not less than 1.0 mm in thickness. Shelves shall have lipped flanges width of flange being 30 mm and depth of lip 15 mm and having 5 shelves.The center to center distance of posts shall not exceed 750mm in both directions. Of Size 1200mm B X 400mm D X 2400mm H	5	Nos.		
	Miscellaneous				
90	Supply and Installation of backlit flex board of approved size and design. The board shall be fabricated out of of GI metal fixed on MS angle supports fastened to wall/structure. Including electrical fittings, connections, all accessories, necessary coat of primer and enamel paint, complete. (size shall vary as per approved design and site conditions and will be paid as actuals). Note: Only front elevation will be measured.	6.00	Sqm		
Grand Total				Rs.	
GST @ 18%				Rs.	
Grand Total (In Rs. Incl. of taxes)				Rs.	
Grand Total in words					
Rupees.....					
.....					
.....					

I AGREE TO EXECUTE THE WORKS AS PER THE RATES QUOTED ABOVE

Signature of Contractor

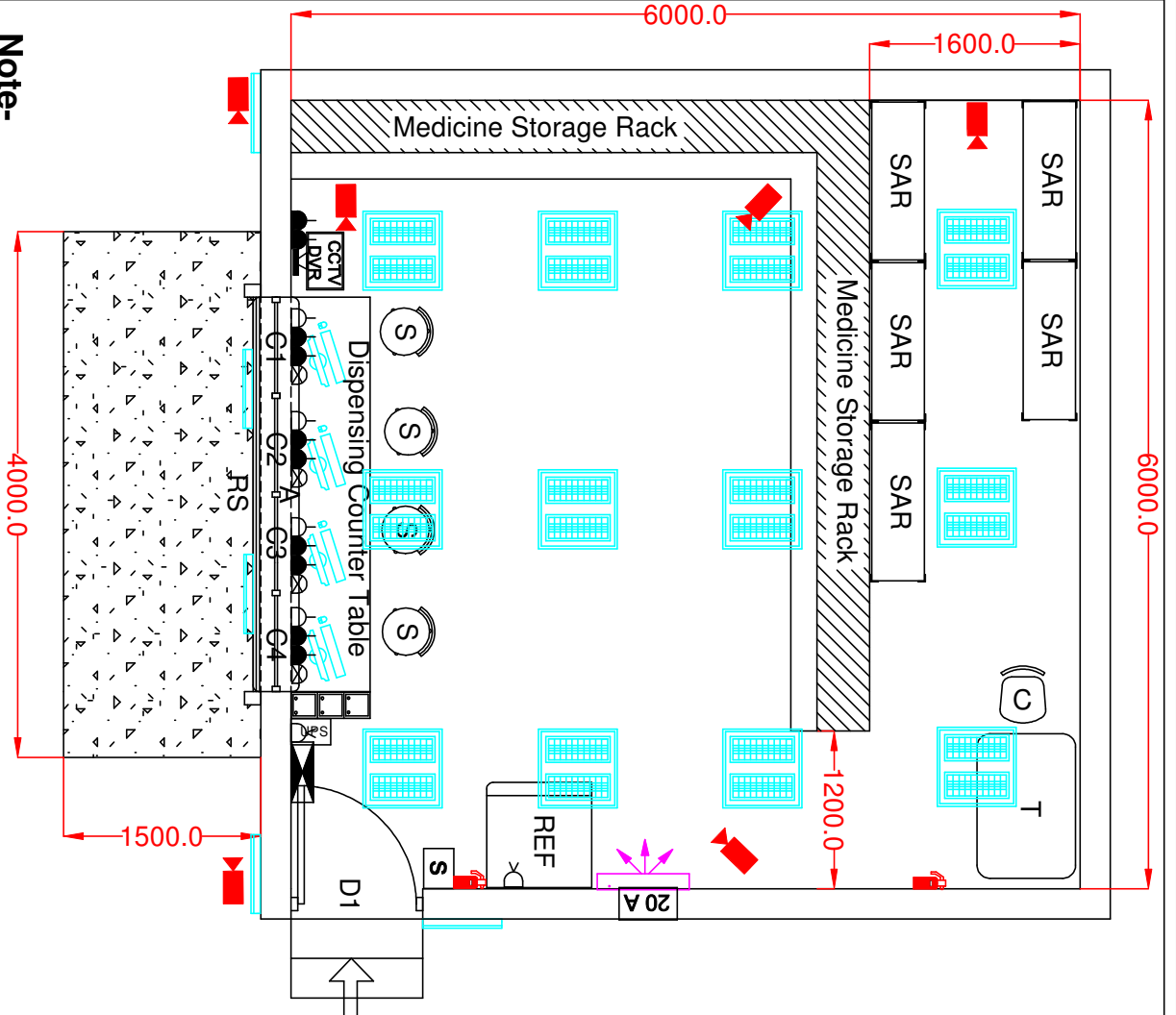

Note-
 Quantities shall be limited to Scheduled Quantities. Any additional quantity shall be executed only after prior approvals from Engineer-in-charge.

Details	
	5 / 6 A Normal Power Point
	5 / 6 A UPS Power Point
	15 A Power Socket
	20 A Industrial Power Socket
	RJ 45 Network Outlet
	15 W LED Fitting
	18 W T8 Tube Light Fitting
	Switch Box
	Online UPS Position
	CCTV DVR Position
	CCTV Camera Position
	SPN DB

Details	
D 1	Single Swing Door W 1200 x H 2100 mm
RS	Rolling Shutter W 3750 x H 1900 mm
C1, C2, C3&C4	Dispensing Counters, W 750 mm Each
REF	Refrigerator Position
S	Counter Height Stool
C	Computer Chair
T	Table
	Desktop Computer
	Fire Extinguisher
SAR	Slotted Angle Rack

For Details :-

- Medicine Storage Rack:-
- Refer Drawing No :HLL-PRO-RBD-AP-018
- Dispensing Counter :-
- Refer Drawing No : HLL-PRO-RBD-AP-017
- False Ceiling
- False Ceiling should be done at a height 2700 mm FFL as per Schedule.
- Floor Tiling
- Vitrified Floor Tiling should be done as per Schedule.

All Dimensions are in Millimeter

PLACE: BGMG & SASOON GENERAL HOSPITAL, PUNE	HLL Lifecare Limited Thiruvananthapuram	AREA 36 Sq. M
DRAWN BY: SARATHH	TITLE:- PROPOSED LAYOUT FOR AMRIT PHARMACY- AT BGMG & SASOON GH, PUNE	
CHECKED BY: AJITH		
APPROVED BY: DATE: 06-03-2018	DRG NO: HLL-PRO-RBD-AP-031	REV:-01 DATE:- 06.03.2018
SCALE: NTS	SHEET NO : 01 OF 03	
ALL DIMENSIONS ARE IN MILLIMETER		

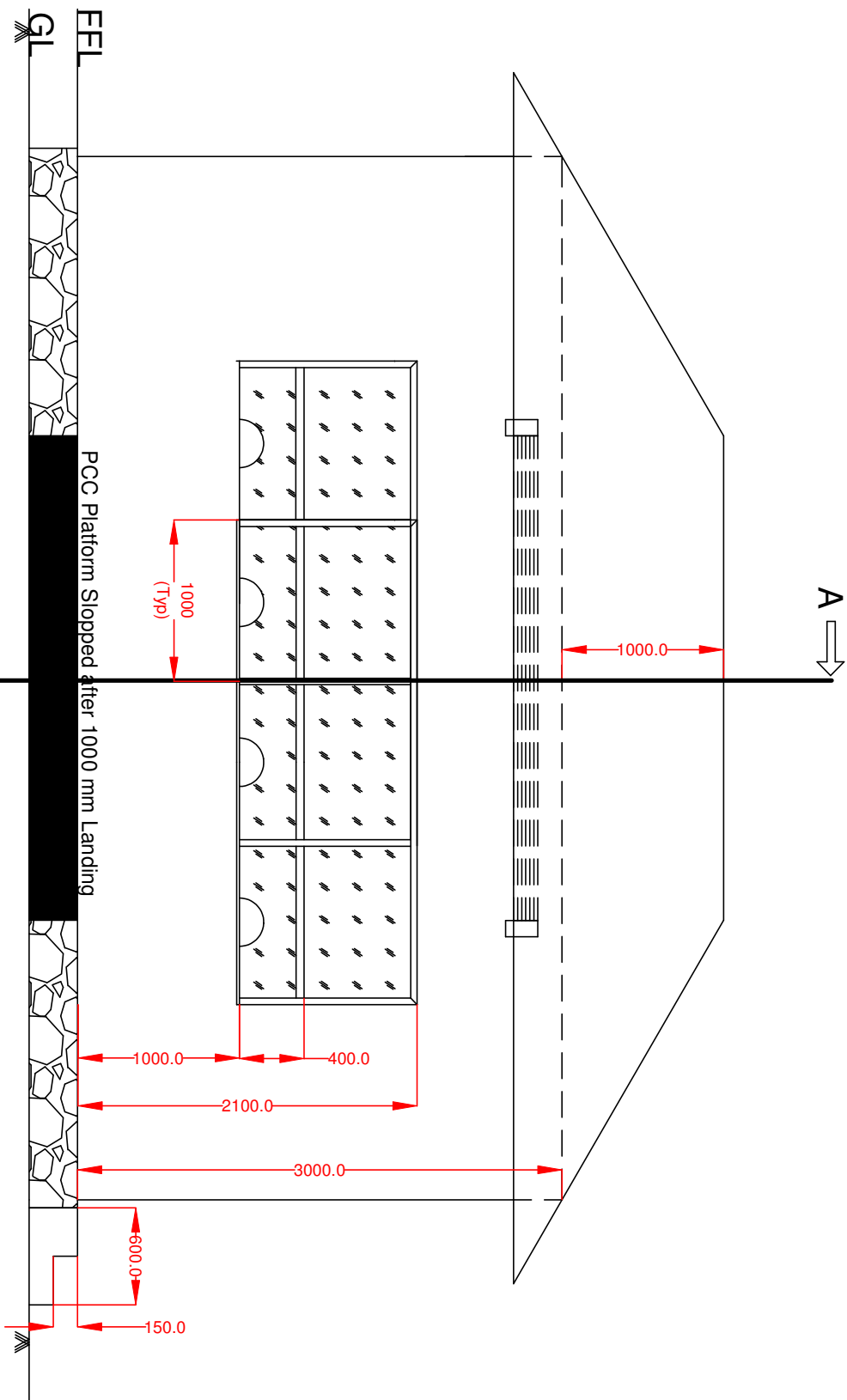

Note-

Quantities shall be limited to Scheduled Quantities.

Any additional quantity shall be executed only after prior approvals from Engineer-in-charge.

All Dimensions are in Millimeter

PLACE: BUGMC & SASOON GENERAL HOSPITAL, PUNE	DRAWN BY: SARATHI AJITH	HLL Lifecare Limited Thiruvananthapuram	AREA 36 Sq. M
CHECKED BY: DATE: APPROVED BY: SCALE:	06-03-2018 NTS	TITLE: PROPOSED LAYOUT FOR AMRIT PHARMACY- AT BUGMC & SASOON GH, PUNE	DRG NO: HLL-PRO-RBD-AP-031
ALL DIMENSIONS ARE IN MILLIMETER		SHEET NO : 02 OF 03 DATE: 06.03.2018	

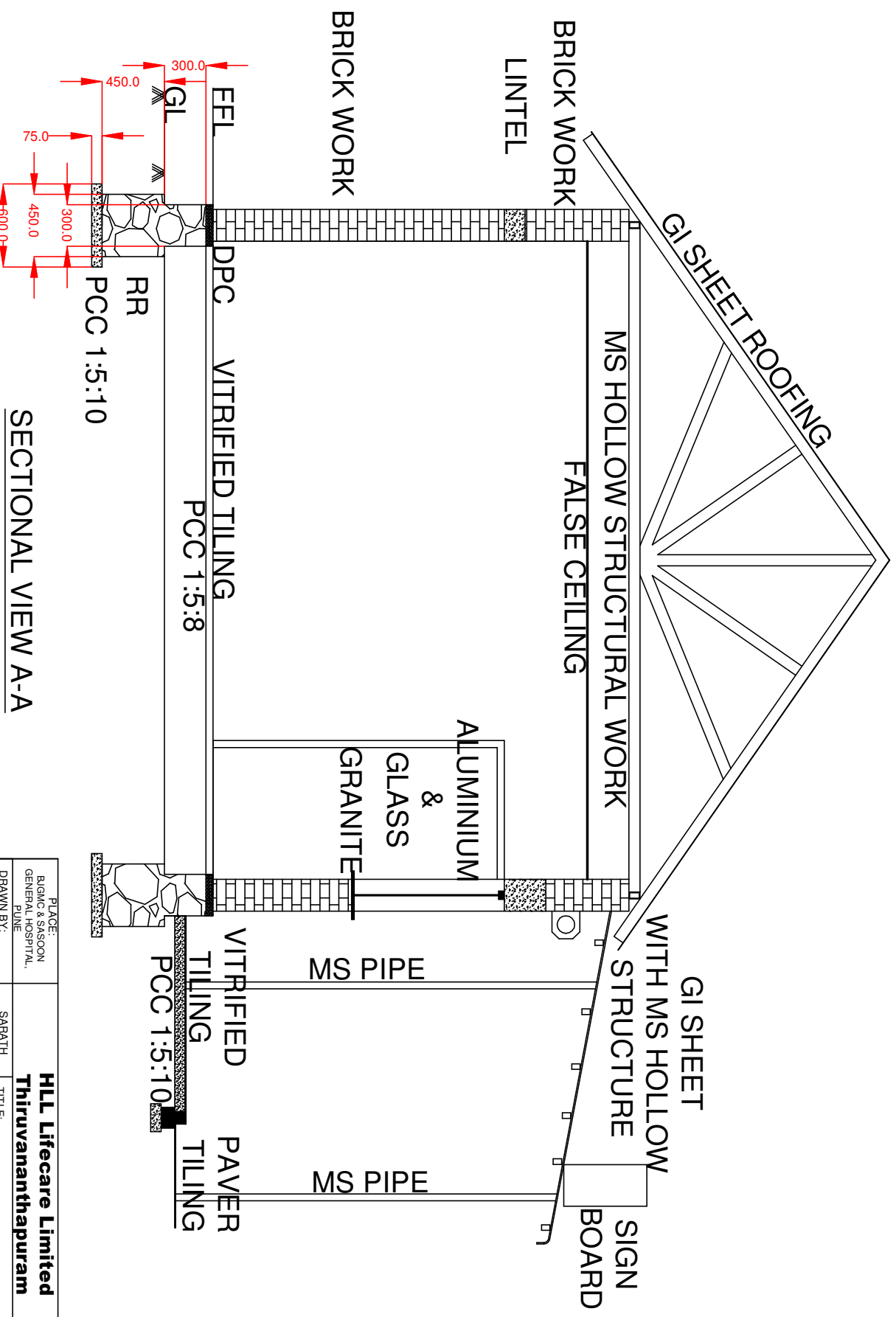

SECTIONAL VIEW A-A

Note-
Quantities shall be limited to Scheduled Quantities.
Any additional quantity shall be executed only after prior approvals from
Engineer-in-charge.

All Dimensions are in Millimeter

PLACE: B.G.M.C & S.A.SOON GENERAL HOSPITAL, PUNE	DRAWN BY: SARATHI AJITH	CHECKED BY: AJITH	DATE: 06-03-2018	SCALE: NTS	ALL DIMENSIONS ARE IN MILLIMETER
HLL Lifecare Limited Thiruvananthapuram	TITLE: PROPOSED LAYOUT FOR AMRIT PHARMACY- AT B.G.M.C & S.A.SOON GH, PUNE	DRG NO: HLL-PRO-RBD-AP-031	SHEET NO : 03 OF 03	AREA 36 Sq. M	REV:-00 DATE:- 06.03.2018

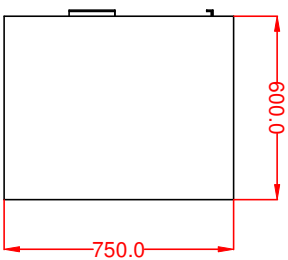
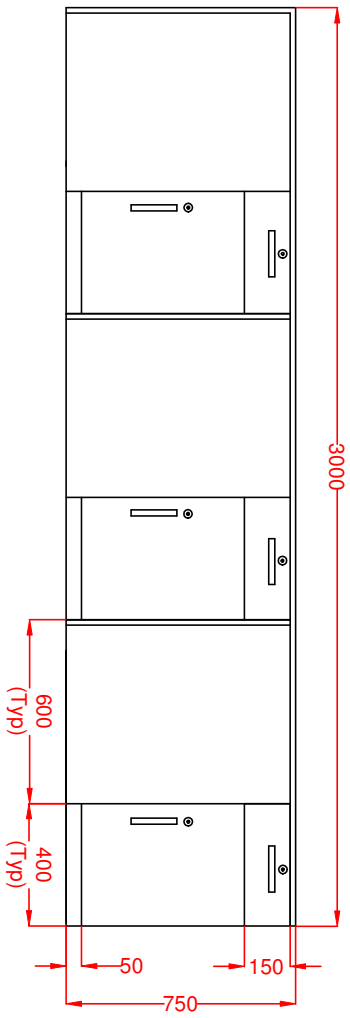
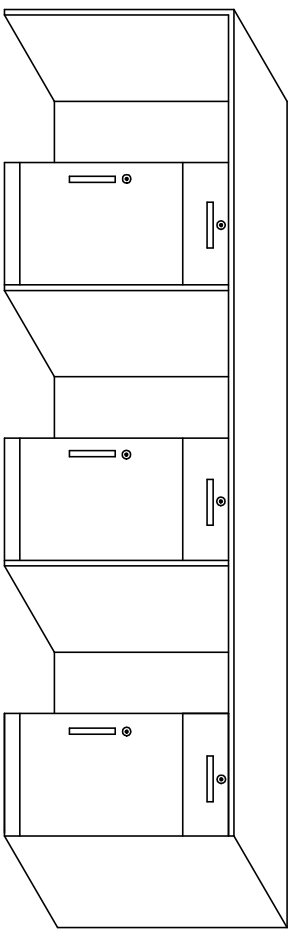
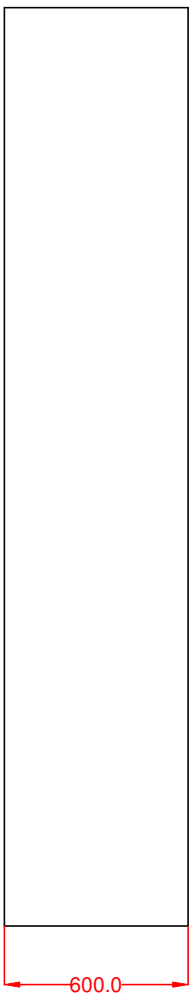

Material :
 Body : 18 mm Thick Commercial Ply
 Lock : Plated Brass Lock
 Handle : Anodised Aluminium Alloy
 Hinges : Stainless Steel

MATERIAL: AS SPECIFIED	HLL Lifecare Limited		FINISH: AS SPECIFIED
DRAWN BY: SARATHI	Thiruvananthapuram		
CHECKED BY: AJITH	SINGLE LEVEL DISPENSING COUNTER		
APPROVED BY:	TABLE		
DATE: 04-01-2018	DRG NO: HLL-PRO-RBD-AP-017		
SCALE: NTS	SHEET NO : 01 OF 01	REV: 00	DATE: 04.01.2018
ALL DIMENSIONS ARE IN MILLIMETER			

All Dimensions are in Millimeter

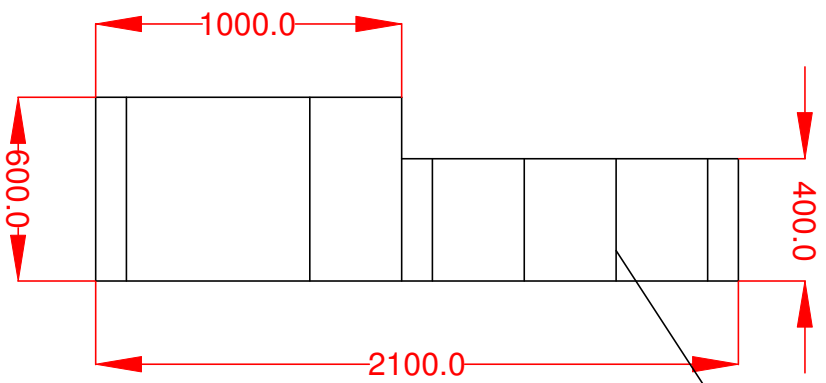
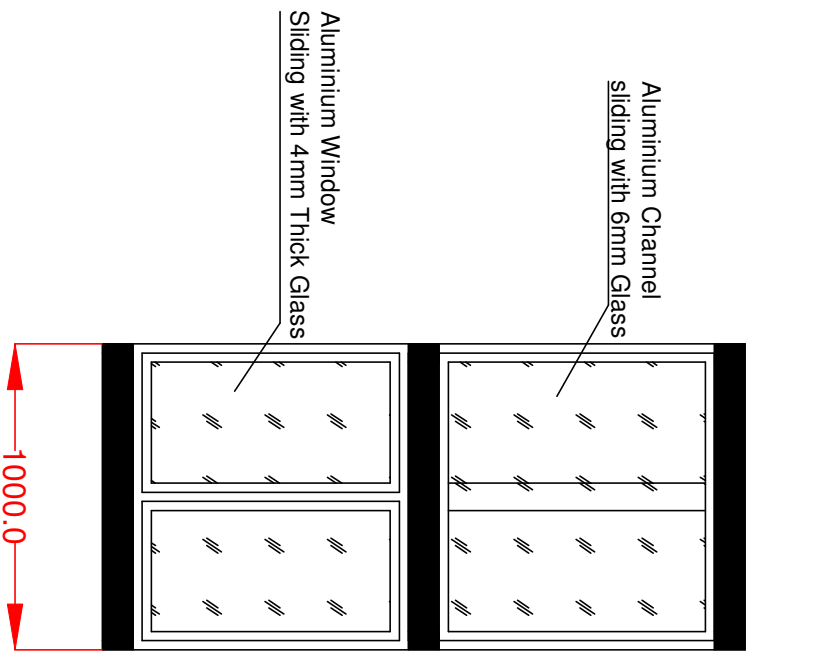

Glass (Min 5.5 mm Thick) / High quality Steel (Min 16 SWG)

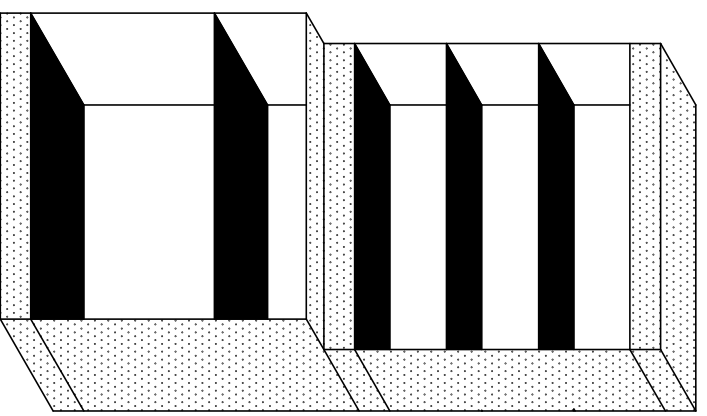

Material :-
As per Schedule

Layouts are for Reference Only.

All Dimensions are in Millimeter

MATERIAL: AS SPECIFIED	SARATHI	HLL Lifecare Limited		FINISH: AS SPECIFIED
DRAWN BY:	ASWATHY	Thiruvananthapuram		
CHECKED BY:		MEDICINE STORAGE RACK		
APPROVED BY:		TITLE:-		
DATE:	10-01-2018	DRG NO:	HLL-PRO-RBD-AP-018	
SCALE:	NTS	SHEET NO :	01 OF 01	REV:-00
ALL DIMENSIONS ARE IN MILLIMETER				DATE:- 10.01.2018