

Amendment No.3

Date: 02.09.2014

Subject: Amendment no.3 to the Tender Enquiry Document

Ref:(i) Tender Enquiry No.: HLL/PCD/PMSSY/AIIMS-II/19/14-15 dated 20.06.2014.

(ii) Amendment No.1 dtd.31.07.2014

(iii) Amendment No.2 dtd. 20.08.2014

The following changes are incorporated to the referred tender document/ subsequent amendments published thereafter:

SECTION - VI **LIST OF REQUIREMENTS**

1)For:-

Part II: Required Delivery Schedule:

For Indigenous and Goods offered from India: 90 days from the date of opening of Notification of Award. The date of delivery will be the date of Delivery at site. (Tenderers may quote the earliest delivery period). Installation and commissioning shall be done within 45 days of receipt of the stores/ goods at site or within 45 days of handing over the site for installation, whichever is later

Read as:

For Indigenous and Goods offered from India: 90 days from the date of opening of **Notification of Award or 30 days after the site readiness whichever is later.** The date of delivery will be the date of Delivery at site. (Tenderers may quote the earliest delivery period). Installation and commissioning shall be done within 45 days of receipt of the stores/ goods at site or within 45 days of handing over the site for installation, whichever is later.

2) For:-

Part II: Required Delivery Schedule:

b) For Imported goods directly from foreign: 90 days from the date of opening of L/C. The date of delivery will be the date of Bill of Lading/Airway bill. (Tenderers may quote the earliest delivery period). Installation and commissioning shall be done within 45 days of receipt of the stores/ goods at site or within 45 days of handing over the site for installation, whichever is later.

Read as:

b) For Imported goods directly from foreign: 90 days from the date of opening of L/C or 30 days after the site readiness whichever is later. The date of delivery will be the date of Bill of Lading/Airway bill. (Tenderers may quote the earliest delivery period). Installation and commissioning shall be done within 45 days of receipt of the stores/ goods at site or within 45 days of handing over the site for installation, whichever is later.

Section VII **Technical Specifications**

1. Existing Specification:

Para: 4. CT Specifications :

Integrated CT hardware option for transmission attenuation correction and lesion localization for all applications. Anatomical and functional data co-registration software for exact image localization (SPECT/CT fusion software).The slice thickness of the CT reconstructed image should be atleast 5 mm.

Read as:

Integrated CT hardware option for transmission attenuation correction and lesion localization for all applications. Anatomical and functional data co-registration software for exact image localization (SPECT/CT fusion software).The slice thickness of the **CT reconstructed image should be atleast 2.5 mm or less.**

2. Existing Specification:

4. CT Specifications :

Anatomical and functional data co-registration software for exact image localization (SPECT/CT fusion software).The slice thickness of the CT reconstructed image should be atleast 5 mm.

Read as:

Anatomical and functional data co-registration software for exact image localization (SPECT/CT fusion software).The slice thickness of the **CT reconstructed image should be atleast 2.5 mm or less.**

3. Existing Specification:

Para: 11.Accessories and QC Utility:

2. High resolution network Laser Color Paper printer compatible with the processing workstation (MS Windows) with 5 sets of all cartridges.

Read as:

Para: 11.Accessories and QC Utility:

2. High Quality COLOUR LASER PRINTER with following specification:

Speed: 20 ppm Black / Colour

Resolution: (Colour& Black) : 600 x 600 DPI

Duty cycle: 1000 pages per month

Hi speed USB 2.0 port

Fast Ethernet 10 / 100 base Tx network port

Duplex printing

50 sheet capacity multipurpose tray

250 input standard tray

Media sizes :Tray 1: A4, A5, A6, B5 (JIS), 16K, 10 x 15 cm, postcards (JIS single, JIS

double), envelopes (ISO DL, ISO C5, ISO B5); Tray 2, optional Tray 3: A4, A5, A6, B5 (JIS),

16K, 10 x 15 cm, postcards (JIS single, JIS double), envelopes (ISO DL, ISO C5, ISO B5);
Automatic duplexer: A4, B5
Media types: Paper (bond, brochure, coloured, glossy, letterhead, photo, plain, preprinted, prepunched, recycled, rough), postcards, transparencies, labels, envelopes

4. Existing Specification:

Para: 11. Accessories and QC Utility:

11. One vital sign monitor (Standard make)

Read as:

Para: 11. Accessories and QC Utility:

11. Multi Para Monitor with following

- High – resolution colour TFT display of minimum screen size 10”.
- Should be able to monitor ECG, NIBP, SpO₂. Temperature and Respiration and ET CO₂
- Plethysmograph with perfusion indicator
- Monitor should monitor at least three channel
- 24 Hrs. graphical / tabular trends
- NIBP trends memory should be more than 200 readings (tabular)
- Should display Critical Alarm summary of at least last 15 Alarm conditions.
- Suitable for Adult
- Selectable Arrhythmia detection
- Should have option to attach inbuilt two channel recorder
- Must have Graded and Colour coded alarms
- User selectable screen formats and user – friendly menu driven functions through optical encoder
- Machine should have inbuilt side stream Capnography module
- Battery backup for at least 1 Hrs.
- It should be European CE or US FDA Certified

Should be supplied with:

One 3 lead ECG cable, Reusable SpO₂ sensor, NIBP cuffs (each for Adult and child).

5. Existing Specification:

13. One Defibrillator

Read as:

13. One Defibrillator

Defibrillator

1. The defibrillator should be least, lightweight, small size with bright colored display
2. The defibrillator should be Biphasic waveform with 3 wave form display with screen size minimum 6 inches diagonal
3. It should display of both selected and delivered energy
4. It should have ability to energy selection from Paddles as well as unit.
5. In manual mode the unit should provide energy selection at (1-10, 15, 20, 30, 50, 100, 150, 200) joules

7. The unit should do self test daily with facility to give print out of defibrillator testing report and also have code ready indicator on unit.
12. The Unit should be US FDA or European CE approved.

6. Existing Specification:

Para: 1. Accessories and QC Utility:

32. One latest specifications Desktop PC with licensed windows, MS office software and laser printer for reporting purposes.

Read as:

Para: 1. Accessories and QC Utility:

Desktop PC

Desktop PC: Intel Pentium i5 or better Generation Processor 4 MB L2 Cache

4 GB DDR3 RAM

1TB GB SATA 7200 RPM HDD

CD-DVD, RW Drive

4 Nos. USB Ports, 18" LED TFT Monitor

Multimedia Keyboard, Optical Scroll Mouse,

Operating System: Windows 7 Home Premium, Professional, or Ultimate Windows 8 or 8.1

Productivity Tools: Microsoft Office 2013

LAN facilities

7. Existing Specification:

Para: 11. Accessories and QC Utility :

33. One latest specifications laptop for teaching purposes.

Read as:

Para: 11. Accessories and QC Utility :

33. One latest specifications laptop for teaching purposes.

Laptop

Laptop PC with 15" TFT/LED display

Operating System: Windows 7 Home Premium, Professional, or Ultimate Windows 8 or 8.1

Productivity Tools: Microsoft Office 2013

Processor Type: Core i7 Processor

Memory: 4 GB RAM

Hard Drive: 500 GB or higher

Graphics Card: 512 MB Video Memory or higher

Added Para:

There has to be resolution recovery algorithm that allows reduction in the dose and/or reduction in acquisition time in SPECT atleast for Cardiac and Bone SPECT

Turnkey Details are added as under:

Draft specifications of Turnkey : GAMMA CAMERA / SPECT – CT

SCHEMATIC SITE PLAN GAMMA CAMERA / SPECT – CT ROOM.

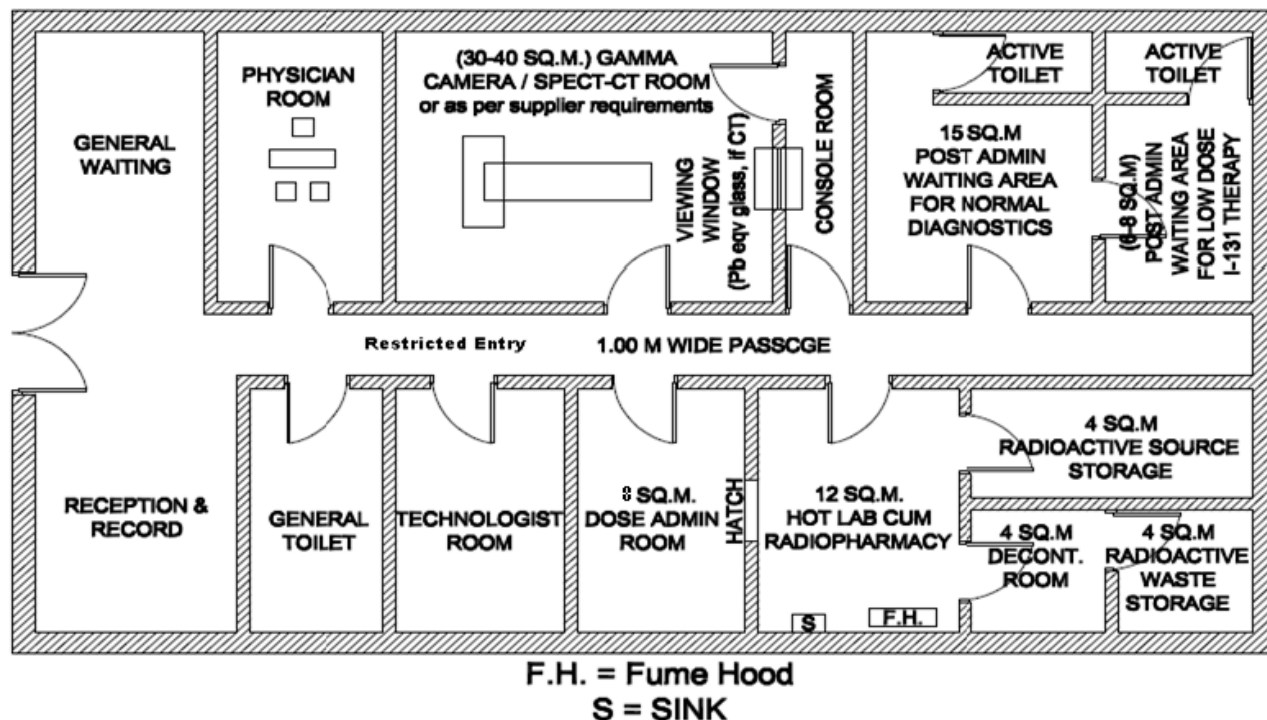

TOTAL AREA : 180m²

GAMMA CAMERA / SPECT CT: 7 m x 5 m ; CONSOLE ROOM : 2.5 m x 5m.

The scope of work consist installation, testing and commissioning of equipments, and integrated commissioning of GAMMA CAMERA / SPECT CT system in the Nuclear Medicine Dept. Necessary building modification is to be designed and executed as per relevant codes, Technical Specifications, conceptual / layout drawings and AERB regulations.

The Turnkey Scope of Work - GAMMA CAMERA / SPECT-CT

1. The Supplier should inspect the proposed site offered by the Consignee Institute in which the GAMMA CAMERA / SPECT-CT system has to be installed and they are required to submit the plan for the complete GAMMA CAMERA / SPECT-CT Centre on a turnkey basis. The scope of work includes complete Civil work, Electrical, Plumbing, Furnishing, Air-conditioning and Fire fighting for the construction of GAMMA CAMERA / SPECT-CT Centre.

2. While preparing the plan, the following aspects have to be addressed.

- a. Care should be taken to provide easy negotiation of the patient stretchers/ trolleys through corridors and doors.
- b. Radiation shielding for doors, walls, windows etc.
- c. Furniture like desk, chairs, shelves etc.
- d. Patient stretcher and other furniture/ accessory to make the centre functional.

3. *The cost of Turnkey for the area of 180 sq.M and Air-conditioning of Tonnage 20 TR will be considered for Ranking / Evaluation purpose.*

4. Moreover Bidders will have to quote the Unit Rates of the following components of turnkey work. a) Civil works b) Electrical work c) Public health (plumbing and sanitary fittings). d) Air Conditioning (HVAC) e) Interior Furnishing & Furniture f) Miscellaneous

Scope of work for turnkey GAMMA CAMERA / SPECT-CT unit works:-

The supplier should inspect the proposed site and submit all the detailed structural and architectural drawings; in accordance with relevant AERB regulations. The detailed BOQ for the proposed GAMMA CAMERA / SPECT-CT Centres should be submitted along with technical bid of the tender. The GAMMA CAMERA / SPECT-CT CENTRE shall consist of the following rooms.

1	General Waiting Room
2	Reception & Record Room
3	Physician Room
4	General Toilet Room
5	Gamma Camera Exam Room
6	Technologist / Consultant Room
7	Console Room
8	Dose Administration Room
9	Hot Lab & Radio Pharmacy Room
10	Post Administration waiting Rooms - 2 no.s
11	Active Toilet - 2 nos
12	Radioactive source storage Room
13	Decontamination Room
14	Radioactive waste storage Room

The actual area of turnkey works done will be considered for payment, based on the site measurements.

1. Civil work

- a) Civil construction work including construction of brick / concrete wall if any, plastering, flooring as per the approved plan and equipment layout plan.
- b) Concrete walls for Active areas if applicable ; Concrete bed at GAMMA CAMERA / SPECT-CT equipment area.
- c) Platform for unloading and shifting the GAMMA CAMERA / SPECT-CT should be provided if necessary.
- d) Cable tray, trench & channel – necessary trenches, cable tray and channels at required location would be provided.
- e) All the construction work to be done as per the final plan approved by the Consignee and AERB.

a) Flooring

1. 600 x 600 mm vitrified tiles with 100mm tile skirting to match in console room, lobby and patient preparation areas, Technologist / Consultant room etc.
2. 50 mm thick cement concrete flooring with Vinyl flooring in GAMMA CAMERA / SPECT-CT equipment / UPS room.

b) Painting

1. Two coats Plastic Emulsion Paint over 2 coats of wall putty including primer in areas where there is no wall cladding like patient preparation area, General waiting area, console room, Equipment room etc.

All Active Areas should be wall clad up to false ceiling height with vitrified tiles.

c) False Ceiling

1. Acoustical tile for ceiling with light weight insulating material of high quality supported on grid or finished seamless with support above ceiling. Finished with white paint or powder coated with white paint, if metallic. Ceiling height to suit the equipment mount and clearances.

2. Plumbing work

1. All water pipes and fittings shall be of high density polythene of approved and standard make. The gratings shall be brass chrome plated. All plumbing accessories should be of standard make.
2. Hot water service to be provided if required.

3. Electrical work

1. The supplier shall be required to specify the total load requirements for the GAMMA CAMERA / SPECT-CT centre including the load of air conditioning , room lighting and for the accessories if any. The supply line will be provided by the Institute up to one point within the GAMMA CAMERA / SPECT-CT centre area. The distribution panel shall be provided by the vendor. Few lights in each room shall be connected to the UPS to provide emergency lighting.
2. The electrical work shall include the following:
 - a. Wiring – All interior electrical wiring- with main distribution panel board, necessary MCBs, DB, joint box, switch box etc. the wires shall be of copper of different capacity as per the load and should be renowned make as listed below.
 - b. Switches light and power points should be of modular type and of standard make as listed below.
 - c. General lights – Mirror optical type 1X28 W or 2X28 W/CFL fittings 2X36, 3X36 W with electronic ballasts

3. AIR CONDITIONING:

Ductable package air conditioners and split AC units may be used according to room requirement and suitability. Humidity control should be effective to eliminate moisture condensation on equipment surface. The Air conditioning should be designed with standby provision to function 24 hours a day. The outdoor units of AC should have grill coverings to prevent theft and damage. Ventilation is required in toilet.

4. Environment specifications:

- a) Humidity range: Relative humidity 60% and 80% in all areas except equipment room which shall be as per requirement of the equipment.
- b) Temperature ranges: 22± 2° C in all areas except equipment room which shall be as per requirement of the equipment.
- c) Air conditioning load: The heat load calculations and maintaining the desired temperature and humidity shall be the responsibility of the bidder.

5. Furniture:

- a) Revolving chairs height adjustable, medium-back with hand-rest in the Control room, Consultant room and viewing area. – **4 NO.S**
- b) Chairs for patient waiting area – Three seater (chrome plated). - **10 NO.S**
- c) Cupboard with laminate door shutters for storage of spare parts and accessories and records as per requirement. – **3 NO.S**
- d) Drug trolleys 1 numbers for patient preparation area.
- e) Patient trolley with rubber foam mattress to be kept in the patient preparation room.
- f) Name boards for all rooms
- g) Tables for Workstation and Consultant in reporting room.-**2 NO.S**
- h) Changing rooms should have change lockers and dressing table.

i) Dustbins (plastic with lid) to be provided as required.

j) Any other furniture item as per requirement.

All furniture items should be of standard make as mentioned in the table below.

6. Miscellaneous:

1. Reporting room should have LED X-ray Film viewer with adjustable brightness ; capable of holding 3 films of 14"x17" size. – **2 no.s**

2. Cabling of Network (LAN) connectivity for camera system, console system, workstation and computers etc.

3. Broadband connection: for REMOTE SERVICE of GAMMA CAMERA / SPECT-CT system.

4. Fire extinguisher Dry CO2 type as required for the building safety.

LIST OF ITEMS AND SUGGESTED MANUFACTURERS

SL NO	ITEMS	PREFERRED MAKES
A	VITRIFIED TILES	Somany, Kajaria , H&R Johnson, RAK india
B	PAINT	Dulux, Asian Paints , Nerolac
C	PLUMBING	Kohler, Jaguar , Grohe , Roca
D	SANITARY ITEMS	CERA, Hindware, Parryware
E	ELECTRICAL	
1	CABLES	Finolex, Havells ,V-Guard
2	SWITCHES	Legrand, L&T, Crabtree , Roma
3	DISTRIBUTION BOX , MCB	Legrand, L&T, Siemens, Havels
4	LIGHT FITTINGS	Philips / Crompton / Kesselec-Schreder / Wipro.
F	AIR CONDINTIONING	Daikin, Hitachi, Blue Star, Voltas,
G	FURNITURE	Hermen Miller , Godrej , Featherlite

SECTION – XI PRICE SCHEDULE

For:

B) PRICE SCHEDULE FOR GOODS TO BE IMPORTED FROM ABROAD

Read as:

SECTION - XI PRICE SCHEDULE
B) PRICE SCHEDULE FOR GOODS TO BE IMPORTED FROM ABROAD

1	2	3	4	5									6		
Item S.No	Brief Description of Goods (With make and Model)	Country of Origin	Quantity (Nos.)	Price per unit (Currency) (PI see GIT clause 12 and 13 of SECTION II)									Unit price on DDP basis at consignee site		
				FOB price at port/airport of Lading (Inclusive of Agency Commission)	Amount and percentage of Agency Commission	FOB Price Excluding Agency Commission	Insurance & Freight)	CIP by Air/Sea at the port of Entry (e)=c+d	Custom Duty amount as % of CIP (HS Code and special exemption if any need to be quoted by the bidder) **	Custom Clearance & Handling charges. **	Loading/unloading inland transportation, insurance as per clause 11 of GCC & incidental cost till consignee site. **	Installation commissioning, supervision. Demonstration & training at consignee site. **	In foreign currency A= (e)	In Indian rupees B = (f)+ (g)+ (h) + (i)	Agency Commission in Indian rupees (C)
				(a)	(b)	(a)	(d)	(e)	(f)	(g)	(h)	(i)	(A)	(B)	(C)

** To be paid in Indian Currency (Rs.)

Total price at consignee site

(A) In foreign currency: Column (4xA) _____ (in figures and words) plus

(B) In Indian Rupees: Column (4xB) _____ (in figures and words)

(C) In Indian Rupees: Indian Agent Commission Column(4XC)

Note: -

- The tenderer will be fully responsible for the safe arrival of the goods at the consignee site in good condition as per terms of contract.
- The bidders breakup of prices under various columns are for comparison of prices up to delivery of goods at consignee's site for tender evaluation.
- The quoted price should be supported with original proforma invoice from the foreign manufacturers. The proforma invoice should indicate the percentage of agency commission included in the FOB prices. Indian agent to be paid in Indian Currency.
- All the components of the DDP price will be paid by the tenderer. The purchaser will make the payment of DDP price after receipt of goods at consignee's site in good condition as per payment terms in the contract.
- The price quoted in foreign currency in column (e) shall be converted in rupees at the rate of exchange applicable on the date of price tender opening. .

Place: _____

Name _____
 Business Address _____

Date: _____

Signature & Seal of the tenderer

All other terms and conditions of the tender enquiry remain unaltered.