

TENDER DOCUMENT

**CIVIL AND ELECTRICAL WORKS FOR RENOVATION &
UPGRADATION OF PRIMARY HEALTH CENTRES INTO
HEALTH & WELLNESS CENTRE AT PANCHKULA DISTRICT**

AT

4 locations IN HARYANA

**PROJECTS DIVISION,
HLL LIFECARE LTD,
CORPORATE HEAD OFFICE, POOJAPPURA,
THIRUVANANTHAPURAM – 695 012,
KERALA, INDIA
PHN: ++91 471 2354949, 2775588**

JULY 2018

HLL LIFECARE LIMITED

(A Government of India Enterprise)
 Projects Division
 Corporate Head Office, Poojappura.P.O,
 Thiruvananthapuram – 695012,
 Kerala, India
 Phone: 0471- 2354949, 2775588

INVITATION FOR BIDS (IFB)

IFB No : HLL/CHO/PROJ/HCD/HR-H&WC/C&E/2018-19/03

Date : 23-07-2018

HLL Lifecare Limited (HLL), a Government of India Enterprise is in the process of upgradation of Primary Health centres into HEALTH & WELLNESS CENTRES at Panchkula District at locations in the state of Haryana. For the said project, sealed and super scribed bids are invited from competent and experienced Suppliers/Contractors who are capable to do the following work meeting the requirements as per our tender.

Sl. No	Brief Description of Item/Work	Qty	EMD/Location in Rs
1	Civil & Electrical works for the renovation & upgradation of Primary Health centres into HEALTH & WELLNESS CENTRES at Panchkula District Schedule V enclosed.	4 locations	Rs 67,000/-

1. Qualification Criteria:

- a. Bidders should have minimum **Three years experience** in the relevant field. Documentary proof for the above eligibility criteria should be submitted along with the offer.
- b. Bidders, **for Health & Wellness centre**, should have experience of having successfully completed within a period of last 3 years ending 31/01/2018 at least
 - i. One Civil & Electrical work of value not less than Rs 16 Lakhs
Or
 - ii. Two Civil & Electrical works, each of value not less than Rs 12 Lakhs
Or
 - iii. Three Civil & Electrical works, each of value not less than Rs 8 Lakhs

Note:- Copies of Work orders and Completion certificates issued by the Client/Authority concerned shall be submitted in proof of the same.

- c. Bidder should have satisfactorily completed at least one work for any Central/State Government Departments or Central/State PSU's or local bodies in the last three years ending 31/01/2018.

Note:- Copies of Work orders and Completion certificates issued by the Client/Authority concerned shall be submitted in proof of the same.

2. The eligible bidder shall quote for all the Schedules as per the Schedule V. The work shall be awarded to the Qualified bidder, who quotes the lowest amount for the corresponding Wellness centre/s in total. If the bidder fails to quote for any of the schedule in the tender then their bid will be treated as non responsive.

3. The scheduled date for issue, receipt and opening of bids is as follows.

- a) Date of issue of tender document - 23-07-2018 onwards
- b) Last date and time for receipt of bids - 06-08-2018 up to 15.00 Hrs.
- c) Date and time of opening of bids - 06-08-2018, 15.30 Hrs.
- d) Address for communication, receipt and place of opening of bids:

SENIOR MANAGER (PROJECTS),

Projects Division,

HLL Lifecare Limited (A Government of India Enterprise)

Corporate Head Office, Poojappura.P.O,

Thiruvananthapuram – 695012,

Kerala, India

Phn: 0471- 2354949, 2775588

E-mail: harikrishnankp@lifecarehll.com, choprojects@lifecarehll.com

4. The completed and sealed bid documents should be submitted to Senior Manager (Projects), in the above address along with the EMD. The outer cover should bear the Enquiry No, closing date and General description of item tendered, and the words "DO NOT OPEN BEFORE" 15.30 Hrs (IST) on ----- (Indicate the Closing Date). EMD shall be submitted in the form of demand draft drawn from a nationalized bank in favor of HLL Lifecare Limited payable at Thiruvananthapuram. Bids received after due date and time will be rejected. Any bid not accompanied by EMD will be rejected.
5. Bids will be opened in the presence of Bidders representative(s) who choose to attend on the specified date and time, at the office of HLL at the address given in Clause 3 (d) above.
6. In the event of the date specified for bid receipt and opening being declared as a closed holiday for the above purchaser's office, the due date for submission of bids and opening of bids will be the following working day at the appointed times.
7. HLL may, at its discretion, extend this deadline for submission of bids by amending the Bid Documents or any other reasons, in which case all rights and obligations of HLL and Bidders previously subject to the deadline will thereafter be subject to the deadline as extended.

8. HLL will not be held responsible for the postal delay, if any, in the delivery of the bidding document or the non-receipt of the same. Bids sent by Telex/Fax/Telegraph will not be accepted.
9. The EMD should be enclosed in a separate envelope and super scribed as “EMD” and to be attached in the main cover.
10. SSI/MSME units interested in availing exemption from payment of EMD should submit a valid copy of their registration certificate issued by the concerned DIC or NSIC. But the party has to provide Security Deposit as per the tender conditions, if the work is awarded to them.
11. Even though the bidder meet the above qualifying criteria, they are subject to be disqualified if they have:

Record of poor performance such as abandoning the works, not properly completing the contract, inordinate delays in completion, litigation history, or financial failures etc...

12. The Bid must include the following information;
 - a. Enquiry No.
 - b. EMD
 - c. Promised Delivery/Completion Schedule
 - d. Price Schedule in Format For Quoting (Schedule V - for 4 locations)
 - e. All other documents/certificate/information as specified in the bid document.
13. In addition to the invitation for bids, the bidding documents include the following schedules.

Schedule I	-	Conditions of Contract
Schedule II	-	Acceptance Form
Schedule III	-	Capability Certificate
Schedule IV	-	Performance Statement
Schedule V	-	Schedule of Works (4 locations)
Schedule VI	-	Drawings
14. The company reserves the right to club or split the items of works, change the qualifying criteria at their discretion and to reject or cancel the Invitation for bids without assigning any reason thereof.

SENIOR MANAGER (PROJECTS)

SCHEDULE I

CONDITIONS OF CONTRACT

1) PRICE

The price quoted should be inclusive of all material cost, loading and unloading charges, all applicable taxes and other levies, insurance etc. The **Schedule of work** is enclosed as **Schedule V (for 4 locations)**.

Price quoted should be firm without any escalation till the order is completely executed.

2) TAXES/DUTIES/LEVIES

The contractor shall be entirely responsible for all applicable taxes including GST, duties, license fees etc. incurred until successful completion of contract.

3) ESCALATION

The rates quoted by the Contractor in the contract documents shall be final and shall not be subjected to any change due to the increase in works awarded or wages or inflation in the cost of materials or any other price variations due to any reason during the stipulated time period of the contract or during the extended time period of completion.

Rates quoted should be inclusive of all cost of materials, Tools/Equipments wellness centre or charges, conveyance to site, handling charges, loading and unloading charges, hiring charges, clearing of debris, statutory payments etc.

4) COMPLETION TIME

Time is the essence of the Contract. The total time allotted for completion of works in all respects for all the sites is 7 Days from the date of issue of the Letter Of Intent or Work Order. This stands clear irrespective of the number of wellness centres awarded to each Party.

5) PAYMENT TERMS

The contractor can submit two running account bills during the work period and payment made as below:

- a) 50% of the total value of work may be released upon the completion of 60 % of the work recommended by State In charge (P&S, HLL) and approved by Project Engineer (P&S, HLL)/ Manager (P&S, HLL).
- b) Balance 50% will be paid along with the final bill only after submission of Work Completion certificate issued by the concerned hospital and approved by Project Engineer (P&S, HLL)/ Manager (P&S, HLL).

5% amount of the Bill will be retained as retention money and will be released only after the Defect liability period of 12 months.

Final Bill to be submitted detailing the work description, quantity and rate as per the Work Order. Payment will be made against actual measurements recorded and certified jointly by State In Charge (P&S, HLL) and the Contractor 's representative, counter signed by Project Engineer (P&S, HLL)/ Manager (P&S, HLL). The work completion certificate will be issued by the concerned centres/hospitals and it is the responsibility of the contractor to collect the completion certificate certified by the concerned hospital authority & HLL authorities and submit to HLL for balance 50% payment

The running account bills are to be submitted detailing the work description, quantity and rate as per the Work Order. Payment will be made against actual measurements recorded and certified jointly by State in charge (P&S, HLL) and the Contractor's representative. For supply of capital items, duly certified delivery challan/supporting documents such as Warranty Certificates etc. shall be enclosed along with bill.

Tax Deduction: All statutory deductions like GST, Income Tax, Works Contract Tax, E.S.I., P.F. or any other government-imposed liabilities shall be borne by the Contractor (as applicable at the time of execution of job) and shall be deducted from each bill submitted by the Contractor.

6) SECURITY DEPOSIT

Simultaneously with the execution of the contract successful bidder shall furnish a Security deposit in the form of a Demand Draft from a nationalised bank drawn in favour of HLL Lifecare Limited, Thiruvananthapuram payable at Thiruvananthapuram or a Bank Guarantee from a nationalised bank, for an amount equal to 5% of the total contract value as Security Deposit for his faithful execution of contract. The Security deposit should be valid until successful completion of the contract and acceptance of the Equipment/works by the Purchaser/Owner and will be released after acceptance of the Equipment/works by the Purchaser/Owner. In case of a delay in the works the validity of security deposit shall be extended.

Within 10 days of the receipt of notification of award from the Purchaser/Owner; the successful Bidder shall furnish the security deposit in the form of a Demand Draft or Bank Guarantee in the security deposit form to be sent along with the Notification of Award.

Failure of the successful Bidder to accept the notification of award or submission of security deposit within the timeframe shall constitute sufficient grounds for the annulment of the award and forfeiture of the EMD, in which even the Purchaser/Owner may make the award to the next lowest evaluated bidder or call for new bids.

7) EARNEST MONEY

Each bid must be accompanied by E.M.D.

The EMD is required to protect the Purchaser/Owner against risk of Bidder's conduct, which would warrant the security's forfeiture.

- a. The EMD shall be in the form of cash deposit or demand draft from a nationalized bank drawn in favour of HLL Lifecare Limited, Thiruvananthapuram payable at Thiruvananthapuram.
- b. E.M.D. from unsuccessful bidders will be returned after the acceptance of order by the L1 party.
- c. In the case of successful bidder, the Earnest Money will be returned after signing the contract, and submission of Security Deposit, which they will have to offer for the faithful execution of the contract.

The EMD may be forfeited:

- (a) If a Bidder withdraws its bid during the period of bid validity specified by the Bidder on the Bidding Document; or
- (b) In case of the successful Bidder, if the Bidder fails:
 - (i) to sign the Contract
 - (ii) to furnish security deposit

SSI/MSME units interested in availing exemption from payment of EMD should submit a valid copy of their registration certificate issued by the concerned DIC or NSIC.

8) INDEMNIFICATION CLAUSE

The Bidder shall indemnify and hold harmless the Owner/Purchaser from and against the below mentioned:

- i. All claims, demands, action, proceedings, losses, damages, liabilities, cost, charges, expenses or obligations that are occasioned or may occasion to HLL as a result of our non-payment of any statutory dues levied/leviable on the Contractor or the Contractor committing breach of any the rules, regulations, orders, directives, instructions that may be issued by any authority under various Laws, PF, ESI Acts and all other applicable Laws/Acts/Rules or any other Statute or Laws for the time being in force
- ii. Any damages, loss or expenses due to or resulting from any negligence or breach of duty on our part or on the part of Sub-Contractor/s, if any, servants or agents of the Bidder.
- iii. Claims, if any, of the employee or the Contractor and its Sub Contractor/s, under the Workmen's Compensation Act, 1923 and Employer's Liability Act 1938 or any other Laws rules and regulations in force for the time being in India and any acts replacing and/or amending the same or any of the same as may be in force at the time and under any law in respect of injuries to persons or property arising out of and in the course of the execution of the contract work and / or arising out of and in the course of employment of any workmen / employee.
- iv. Any non - compliance or improper compliance of statutes, rules and regulations which are applicable to HLL and also to the Contractor and to the employees , in respect of (a) Employees' Provident Fund and Miscellaneous Provision Act, 1952, (b) Employees State Insurance Act, 1948, (c) Minimum Wages Act, 1948 (d) Payment of Wages Act, 1936 (e) Bonus Act, 1965 (f) Workmen's

Compensation Act, 1923 and / or any other laws which may become applicable in respect of the Contract/ Agreement between HLL and the Bidder.

- v. Any Act or omission by us or our Sub-contractor/s, if any, our /their servants or agents which may involve any loss, damages, liability, civil or criminal action.
- vi. To protect against all claims for damage caused due to non-obtaining of insurance policy during the project period.

9) DEFECT LIABILITY PERIOD:

The defect liability period of the work shall be 12 months from the date of completion of the work and this date will start from successful completion and handing over. If any damage or defect occurs in the work during this period then the Contractor shall rectify the damage or defect at his own expense to the satisfaction of the Purchaser/Owner. If the Contractor fails to do so, then the Purchaser/Owner shall have the authority to get the work done by other means and the expenditure incurred shall be recovered from the Contractor.

Even if Inspection and/or tests are fully carried out by Purchaser/Owner or their representatives, the Contractor is not absolved to any degree of his responsibility to ensure that all equipment fabricated comply strictly with the requirements as per specifications given in the order, and the Purchaser/Owner shall be free to point out any defect till the defect liability period is over.

10) FORCE MAJEURE

- a. Neither the Contractor nor the Purchaser/Owner shall be considered in default in the performance of their obligations as per the Contract so long as such performance is prevented or delayed because of strikes, war, hostilities, revolution, civil commotion, epidemics, accidents, fire, cyclone, flood or because of any law and order proclamation, regulation or ordinance of Government or subdivision thereof or because of any act of God. The proof of existence of force majeure shall be provided by the party claiming it to the satisfaction of the other.
- b. The Contractor shall advise Purchaser/Owner initially by a Fax, followed by post, the beginning and end of any of the above causes of delay, failing which Purchaser/Owner shall not be liable to consider delays due to the above reasons. Notice as stated above should be given even in case where only the Contractor's bids are under the consideration of the Purchaser/Owner and no acceptance of the same has been given and detailed order issued.
- c. In the event of definite delay even if arising out of reasons due to force majeure, Purchaser/Owner shall have the right at their discretion to cancel the Order or part of the Order without any liability on their part to make any payment to the Contractor while reserving the right to claim refund of and any payment if advanced or paid to Contractor.

11) DELAY IN WORK EXECUTION DUE TO REASONS BEYOND CONTRACTOR'S CONTROL

Force majeure: If the execution of work is delayed due to force majeure, then Purchaser/Owner as per the affected period may extend the time period.

In case work is delayed due to non-availability of stores supplied by Owner or any decision by Owner holding the progress of work, the contractor then upon any such happening causing delay shall immediately but not later than 10 days, give notice thereof in writing to the Owner, but nevertheless use constantly his best effort to prevent or make good delay. The Owner may in his discretion grant such extension of time as may appear reasonable to him and the same shall be communicated to the contractor in writing and shall be final and binding on him and the contractor shall be bound to complete the work within such extended time.

12) LIQUIDATED DAMAGES FOR DELAYS

If the work is not completed and handed over to the Purchaser/Owner within the time stipulated in the Order, Purchaser/Owner may at their option, either (1) recover from the Contractor liquidated damages at the rate of 0.5 % of the total contract value for every day of delay, subject to a maximum of 10 % of the total contract value, or (2) at the risk and cost of the Contractor and without prejudice to the other remedies/rights as per the Contract, terminate the order wholly or partially and complete it themselves or reassign it to other contractors.

13) SPECIAL INSTRUCTIONS

The bidder shall visit the site before quoting for the work and also take their own assessments before quoting of bids.

The bidders shall quote for all the locations & all schedules in the tender document as per the Schedule V and his/her own eligibility as per the pre qualification criteria. The work shall be awarded to the Qualified bidder, who quotes the lowest amount in total. If the bidder fails to quote any of the schedule in the tender then their bid will be treated as non responsive.

All pages of the bid, except for un-amended printed literature shall be signed by the person or persons signing the bid. The seal of the company shall be stamped in all pages.

Bids shall be made in English. The bid shall contain no interlineations, erasures or overwriting except as necessary to correct errors made by the Bidder, in which case such corrections shall be signed by the person or persons signing the bid.

To assist in the examination, evaluation and comparison of bids, the Owner may, at its discretion, ask the bidder for a clarification of its bid. The request for clarification and the response shall be in writing and no change in the rate or substance of the bid shall be sought, offered or permitted.

Arithmetical errors will be rectified on the following basis. If there is a discrepancy between the unit price and the total price that is obtained by multiplying the unit

price and quantity, the unit price shall prevail and the total price shall be calculated. If there is a discrepancy between the words and figures of unit price, the amount in words of unit price shall prevail.

Prior to the detailed evaluation, the Owner will determine the substantial responsiveness of each bid to the bidding documents. For purposes of these clauses, a substantially responsive bid is one, which conforms to specifications and all the terms and conditions of the bidding documents without material deviation. The Owner's determination of a bid's responsiveness is to be based on the contents of the bid itself without recourse to extrinsic evidence.

The Owner's determination as to the substantial responsiveness or otherwise of each bid or consideration of a minor informality or non-conformity or irregularity is final and conclusive.

The Owner reserves the right to negotiate with the lowest evaluated responsive bidder.

The Owner will award the Contract to the successful Bidder whose bid has been determined to be substantially responsive and has been determined as the lowest evaluated bid provided further that the Bidder is determined to be qualified to perform the Contract satisfactorily for the items offered.

Prior to the expiration of the period of bid validity, the Owner will notify the successful Bidder in writing by or cable or telex or fax, to be confirmed in writing by post, that its bid has been accepted. The notification of award may be sent in the form of Letter of Intent and/or Work order.

The signed acceptance of the notification of award by the Contractor will constitute a concluded contract.

The work should be carried out without causing any inconvenience to the public and shall ensure that no damages are caused to the existing site premises.

During the execution of work, the contractor or authorized representative should be present at site.

All Materials, Equipment's/ Tools required for the work should be arranged by the contractor and brought to site for the timely completion of the work.

The materials used shall be as per specification and of good quality.

The Contractor has to arrange necessary insurance coverage for the machine, workmen etc. deployed by him. He shall arrange all safety measures to protect his workmen and also the properties of HLL/Hospital Building. The work site safety of all employees, their ESI, PF etc will have to be borne by the contractor.

The work should be carried out in truly professional manner, neatly finished with proper line, level and plumb. Cleanliness and finishing of the job is of utmost importance. Hence the job should be done most carefully with best workmanship.

For all finishing jobs samples should be approved from the Purchaser/Owner before completely executing the work.

The Purchaser/Owner should be immediately informed for any discrepancy in drawings, specifications and instructions in the execution of job before actual execution of particular item having discrepancy.

Any item found to be having been executed with poor workmanship then the Contractor shall have to rectify /reconstruct the work as specified by Purchaser/Owner. No extra charge will be admissible in such case. If CONTRACTORS fails to do so, the Purchaser/Owner reserved the right to rectify/reconstruct the work through some other agency at the expenses of Contractor.

The schedule of activities as submitted by the Contractor shall have to be strictly adhered to. Regular progress reports shall have to be submitted by the Contractor giving all details for monitoring of the schedule.

The Contractor shall make initial drawings/layouts (as per site conditions) and get it approved by HLL before execution.

Special care is to be taken for cleanliness of the site. After the end of day's work, the site should be cleaned immediately.

The Contractor shall have to co-operate with the agencies executing other works in the same area.

While executing the work, the Contractor shall ensure safety and security of the property of the Purchaser/Owner so as to avoid theft etc.

Measurement & Payment terms:

The method of measurement of completed work shall be in accordance with the standard measurement. Payment will be made on satisfactorily completion of work as per the order. Interim or running account bills shall be submitted by the contractor for the work executed on the basis of such recorded measurements in the format of HLL. All such interim payments shall be regarded as payment by way of advances against final payment only, and shall not preclude the requiring of bad, unsound and imperfect or unskilled work to be rejected, removed, taken away and reconstructed or re erected. Any certificate given by the officer relating to the work done or materials delivered forming part of such payment, may be modified, or corrected by any subsequent such certificate(s) or by the final certificate and shall not by itself be conclusive evident that any work or material so which it relates is /are in accordance with the contract and certificate. Any such interim payment,/any part there of shall not in any respect conclude, determine or affect in any way powers of the engineer in charge under the contract or any of such payment s be treated as final settlement and adjustment of accounts or in any way vary or affect the contract.

If contractor is executing any extra items as per direction of Engineer in charge / Officer in charge, the rates shall be worked out as per the latest CPWD Schedule

of Rates and in case, the item is not included in the CPWD schedule, the rate shall be arrived as per prevailing Market rates.

The Quantity shown in the schedule is an approximate estimated quantity. No rate revision will be entertained if the quantity increases/decreases due to the site condition while executing the work.

Water and Electricity: The contractor shall make his own arrangement for water and electricity required for the works. HLL will not be responsible for the supply of either electricity or water.

During the execution of work, the contractor or authorized representative/s at least one person having technical qualification should be present at site.

The contractor shall comply with by-laws and regulation of local and statutory authorities having jurisdiction over the work and shall be responsible for payment of all statutory fees and other charges and the giving and receiving of all necessary notices and the Owner shall be kept informed of the said compliances with by-laws, payment made, notices issued and received.

Electrical

The work shall be carried out by a contractor holding valid licence issued by the State Government/Competent Authority for carrying out installation work of all voltage classes involved, under direct supervision of the persons holding valid certificates issued or recognized by the state government/competent authority.

Final payment shall be paid only after clearing the site as per direction of Engineer-in-charge/ Officer in charge.

14) CORRESPONDENCE

All correspondence relating to this Order shall be in English, to:

SENIOR MANAGER (PROJECTS),
PROJECTS DIVISION,
HLL LIFECARE LIMITED (A Government of India Enterprise)
Corporate Head Office, Poojappura.P.O,
Thiruvananthapuram – 695012, Kerala, India
Phn: 0471- 2354949, 2775588
E-mail: choprojects@lifecarehll.com, harikrishnankp@lifecarehll.com
hcdcmo@lifecarehll.com

For any technical clarifications please contact : Mr. Bhuvaneshwaran (Project Manager)
Mob: 9788905803. Arun Prasad: DM (Procurement) Mob: 7824001037

15) SETTLEMENT OF DISPUTES

Arbitration shall not be a means of settlement of any dispute or claim arising out of the contract relating to the work. Any disputes or difference arising between the parties with respect to the performance of any part of this agreement or anything connected therewith, etc shall as far as possible be mutually settled by the process of dialog and negotiation.

The Courts at Thiruvananthapuram alone shall have jurisdiction in respect of settlement of any matter arising out or in connection with the contract.

SCHEDULE II

ACCEPTANCE FORM

(To be submitted in the letter pad of the firm indicating full name and address, telephone & fax numbers etc.)

From

To

Senior Manager (Projects),
Projects Division,
HLL Lifecare Limited (A Government of India Enterprise)
Corporate Head Office, Poojappura.P.O,
Thiruvananthapuram – 695012,
Kerala, India
Phn: 0471- 2354949, 2775588
E-mail: harikrishnankp@lifecarehll.com, choprojects@lifecarehll.com

Dear Sir,

I / We, hereby offer to supply/construct/erect/install/commission the work as detailed in schedule/drawings hereto or such portion thereof as you may specify in the acceptance of Bid at the price given in the price bid and agree to hold this offer open till 90 days after the date of bid opening prescribed by the purchaser/Owner. I/We have understood the terms and conditions mentioned in the invitation for bid and Conditions of Contract furnished by you and have thoroughly examined the specifications quoted in the bid document/drawings hereto and are fully aware of the nature of the scope of work required and my/our offer is to comply strictly in accordance with the requirement and the terms and conditions mentioned above.

Yours faithfully,

SIGNATURE OF THE BIDDER

SCHEDULE III

CAPABILITY CERTIFICATE

(To be submitted in the letter pad of the firm indicating full name and address, telephone & fax numbers etc.)

I/We have the financial capability to execute the work and complete the same within the specified time period (6 weeks). The delay, if any, in taking measurements, certification of bills, submission of bills and release of payments will not affect the progress and completion of work. I have read all the terms and conditions of the tender document including payment terms and confirm my acceptance of the same.

SIGNATURE OF THE BIDDER WITH SEAL

SCHEDULE IV

PROFORMA FOR PERFORMANCE STATEMENT

Proforma for Performance Statement (for a period of last 3 years)

Name of the Tenderer:.....

Name & Address of the Tenderer / Service Provider:.....

Order placed by (Full Address of Company / Consignee)	Order No. and Date	Description and quantity of ordered work and service	Value of order	Date of Completion of Contract		Remarks indicating reasons for delay, if any	Have the works been satisfactorily completed? (Attach a documentary proof from the client)
				As per Contract	Actual		

We hereby certify that if at any time, information furnished by us is proved to be false or incorrect, we are liable for any action as deemed fit by the Company in addition to forfeiture of earnest money.

Signature and Seal of the Bidder

.....

SCHEDULE V

**RENOVATION OF CIVIL & ELECTRICAL WORKS FOR UPGRADATION OF PHCs IN
PANCHKULA DISTRICT IN THE STATE OF HARYANA**

ABSTRACT PRICE BID

Site. No.	Location	Details	Amount Quoted (Rs)
1	PHC Hangola	Civil Work	
		Electrical Work	
		GST___ %	
		Sub Total (a)	
2	PHC Kot	Civil Work	
		Electrical Work	
		GST___ %	
		Sub Total (b)	
3	PHC Nanakpur	Civil Work	
		Electrical Work	
		GST___ %	
		Sub Total (c)	
4	PHC Pinjore	Civil Work	
		Electrical Work	
		GST___ %	
		Sub Total (d)	
Total Rs = Sub total (a+b+c+d)			

Total words in Rupees:_____

Bidder has to quote as per the Make/Brand specified in the BOQ, proposed to use for the project, and has to marks the Make/Brand in the quote / price schedule.

SEAL OF THE BIDDER

Date:

**SIGNATURE
NAME AND ADDRESS OF BIDDER**

1) Primary Health Centre, Hangola – Panchkula District

PHC Hangola (Panchkula) - Civil works									
S. No	Description of work	Nos	L in M	B in M	D in M	Qty	Unit	Unit Rate in Rs.	Total Rate in Rs.
EARTH WORK									
3	Surface dressing of the ground including removing vegetation and in equalities not exceeding 15 cm deep and disposal of rubbish, lead up to 50 m and lift up to 1.5 m.								
	For Passage Area	1.000	12.000	5.000	1.000	60.000	M.SQ		
	For Nearby Waiting Area Side	1.000	12.000	3.000	1.000	36.000	M.SQ		
	TOTAL					96.000	M.SQ		
	Say					96.000	M.SQ		
4	Clearing jungle including uprooting of rank vegetation, grass, brush wood, trees and saplings of girth up to 30 cm measured at a height of 1 m above ground level and removal of rubbish up to a distance of 50 m outside the periphery of the area cleared.								
	For Passage Area	1.000	12.000	5.000	1.000	60.000	M.SQ		
	For Nearby Waiting Area Side	1.000	12.000	3.000	1.000	36.000	M.SQ		
	TOTAL					96.000	M.SQ		
	Say					96.000	M.SQ		
9	Half brick masonry with common burnt clay F.P.S. (non modular) bricks of class designation 7.5 in superstructure above plinth level up to floor V level. Cement mortar 1:3 (1 cement :3 coarse sand)								
	Labour Room Partition	6.000	2.000	1.200	1.000	14.400	M.SQ		
	TOTAL					14.400	M.SQ		
	Say					15.000	M.SQ		
FLOORING									

PHC Hangola (Panchkula) - Civil works

S. No	Description of work	Nos	L in M	B in M	D in M	Qty	Unit	Unit Rate in Rs.	Total Rate in Rs.
10	Providing and laying vitrified floor tiles in different sizes (thickness to be specified by the manufacturer) with water absorption less than 0.08% and conforming to IS: 15622, of approved make, in all colours and shades, laid on 20mm thick cement mortar 1:4 (1 cement : 4 coarse sand), jointing with grey cement slurry @ 3.3kg/sqm including grouting the joints with white cement and matching pigments etc., complete. Size of Tile 600x600 mm								
	Floor Tile	0.000	9.560	32.600	1.000	0.000	M.SQ		
	Dismantling Quantity	LS				10.000	M.SQ		
	Passage Floor	0.000	14.000	2.800	1.000	0.000	M.SQ		
	TOTAL					10.000	M.SQ		
	Say					10.000	M.SQ		
11	Providing and fixing 1st quality ceramic glazed floor tiles conforming to IS : 15622 (thickness to be specified by the manufacturer) of approved make in all colours, shades except burgundy, bottle green, black of any size as approved by Engineer-in-Charge in skirting, risers of steps and dados over 12 mm thick bed of cement Mortar 1:3 (1 cement: 3 coarse sand) and jointing with grey cement slurry @ 3.3kg per sqm including pointing in white cement mixed with pigment of matching shade complete.								
	Toilet	1.000	1.600	2.100	2.000	6.720	M.SQ		
	TOTAL					6.720	M.SQ		
	Say					8.000	M.SQ		

PHC Hangola (Panchkula) - Civil works

S. No	Description of work	Nos	L in M	B in M	D in M	Qty	Unit	Unit Rate in Rs.	Total Rate in Rs.
12	Providing and laying machine cut, mirror polished Marble stone flooring, in required design (Simple geometrical, abstract etc.) and in patterns in combination with Italian marble stones of different colours, shades and finished surface texture etc., in linear portions of the building, all complete as per the architectural drawings, with 18 mm thick stone slab laid over 20 mm (average) thick base of cement mortar 1:4 (1 cement : 4 coarse sand) laid and jointed with white cement slurry @ 4.4 kg/sqm including pointing with white cement slurry admixed with pigment to match the marble shade including rubbing, curing and polishing etc. all complete as specified and as directed by the Engineer-in-Charge. 18 mm thick Italian Marble stone slab, Perlato, Rosso verona, Fire Red or Dark Emperadore etc.								
	For Platform in Labour Room	1.000	5.000	0.600	1.000	3.000	M.SQ		
	TOTAL					3.000	M.SQ		
	Say					3.000	M.SQ		

PHC Hangola (Panchkula) - Civil works

S. No	Description of work	Nos	L in M	B in M	D in M	Qty	Unit	Unit Rate in Rs.	Total Rate in Rs.
	24 mm thick factory made PVC door shutters made of styles and rails of a uPVC hollow section of size 59x24 mm and wall thickness 2 mm (± 0.2 mm) with inbuilt edging on both sides. The styles and rails mitred and joint at the corners by means of M.S. galvanised/ plastic brackets of size 75x220 mm having wall thickness 1.0 mm and stainless steel screws. The styles of the shutter reinforced by inserting galvanised M.S. tube of size 20x20 mm and 1 mm (± 0.1 mm) wall thickness. The lock rail made up of 'H' section, a uPVC hollow section of size 100x24 mm and 2 mm (± 0.2 mm) wall thickness, fixed to the shutter styles by means of plastic/galvanised M.S. 'U' cleats. The shutter frame filled with a uPVC multi-chambered single panel of size not less than 620 mm, having over all thickness of 20 mm and 1 mm (± 0.1 mm) wall thickness. The panels filled vertically and tie bar at two places by inserting horizontally 6 mm galvanised M.S. rod and fastened with nuts and washers, complete as per manufacturer's specification and direction of Engineer-in-charge. (For W.C. and bathroom door shutter).								
	For Toilet Door	1.000	5.000	0.750	1.000	3.750	M.SQ		
	TOTAL					3.750	M.SQ		
	Say					5.000	M.SQ		
PLASTERING									
26	15 mm cement plaster on rough side of single or half brick wall finished with a floating coat of neat cement of mix : 1:3 (1 cement: 3 fine sand)								
	For OT Room Scrub Wall	8.000	2.800	2.000	1.000	44.800	M.SQ		
	TOTAL					44.800	M.SQ		
	SAY					45.000	M.SQ		

PHC Hangola (Panchkula) - Civil works

S. No	Description of work	Nos	L in M	B in M	D in M	Qty	Unit	Unit Rate in Rs.	Total Rate in Rs.
PAINTING									
27	Distempering with 1st quality acrylic washable distemper (ready made) of approved manufacturer and of required shade and colour complete. as per manufacturer's specification. One or more coats on old work								
	Existing Wall All around	4.000	30.000	2.100	1.000	252.000	M.SQ		
	Existing Wall All around	42.000	5.300	2.000	1.000	445.200	M.SQ		
	Existing Wall All around	1.000	92.000	5.300	1.000	487.600	M.SQ		
	Existing Wall All around	20.000	5.300	2.100	1.000	222.600	M.SQ		
	TOTAL					1407.400	M.SQ		
	Say					1408.000	M.SQ		
28	Painting wood work with Deluxe Multi Surface Paint of required shade. Two or more coat applied @ 0.90 ltr/10 sqm over an under coat of primer applied @0.75 ltr/10 sqm of approved brand and manufacture								
	Wooden Door	4.000	12.000	2.100	1.000	100.800	M.SQ		
	TOTAL					100.800	M.SQ		
	Say					101.000	M.SQ		
29	Painting Steel work with Deluxe Multi Surface Paint to give an even shade. Two or more coat applied @ 0.90 ltr/ 10 sqm over an under coat of primer applied @ 0.80 ltr/ 10 sqm of approved brand and manufacture								
	Steel Windows	1.000	7.000	6.000	1.000	42.000	M.SQ		
	Truss Work Painting	12.000	1.500	1.500	1.000	27.000	M.SQ		
	TOTAL					69.000	M.SQ		
	Say					69.000	M.SQ		
30	Providing and applying plaster of paris putty of 2 mm thickness over plastered surface to prepare the surface even and smooth complete.								
	Interior Qunatity	1.000	12.000	1.000	1.000	12.000	M.SQ		
	TOTAL					12.000	M.SQ		
	Say					12.000	M.SQ		

PHC Hangola (Panchkula) - Civil works

S. No	Description of work	Nos	L in M	B in M	D in M	Qty	Unit	Unit Rate in Rs.	Total Rate in Rs.
31	Removing white or colour wash by scrapping and sand papering and preparing the surface smooth including necessary repairs to scratches etc. complete								
	Existing Interior Quantity	1.000	1408.000	1.000	1.000	1408.000	M.SQ		
	Existing Exterior Quantity	1.000	1456.000	1.000	1.000	1456.000	M.SQ		
	TOTAL					2864.000	M.SQ		
	Say					2864.000	M.SQ		
32	Finishing walls with Acrylic Smooth exterior paint of required shade: Old work (Two or more coat applied @ 1.67 ltr/ 10 sqm) on existing cement paint surface								
	Existing Wall All around	4.000	31.770	5.000	1.000	635.400	M.SQ		
	Existing Wall All around	6.000	6.000	5.000	1.000	180.000	M.SQ		
	Existing Wall All around	4.000	17.300	5.000	1.000	346.000	M.SQ		
	Existing Wall All around	2.000	7.400	5.000	1.000	74.000	M.SQ		
	Existing Wall All around	2.000	6.000	5.000	1.000	60.000	M.SQ		
	Existing Wall All around	2.000	16.000	5.000	1.000	160.000	M.SQ		
	TOTAL					1455.400	M.SQ		
	Say					1456.000	M.SQ		
DISMANTLING									
33	Dismantling plastered brickwalls in cement mortar including cleaning, stacking the useful materials as directed by engineer-in-charge and dumping the dismantled debris as indicated at site, levelling, consolidating, all complete as directed and disposing the debris away from site all complete as directed.								
	In Existing Wall	12.000	0.300	0.300	1.000	1.080	M.CUBE		
	TOTAL					1.080	M.CUBE		
	Say					2.000	M.CUBE		
34	Dismantling the existing RCC concrete including cutting the reinforcement, stacking the useful materials as directed by engineer-in-charge, dumping the dismantled debris as indicated								

PHC Hangola (Panchkula) - Civil works

S. No	Description of work	Nos	L in M	B in M	D in M	Qty	Unit	Unit Rate in Rs.	Total Rate in Rs.
	at site, leveling, consolidating, all complete as directed and disposal of debris away from site all complete.								
	In Existing Wall	8.000	0.300	0.300	1.000	0.720	M.CUBE		
	TOTAL					0.720	M.CUBE		
	Say					1.000	M.CUBE		
35	Dismantling Aluminium partition including disposing the debris away from site as directed by engineer in charge all complete.								
	In Existing Building	1.000	2.000	1.800	1.000	3.600	SQM		
	TOTAL					3.600	SQM		
	Say					4.000	SQM		
36	Dismantling of flushing cistern of all types (C.I./PVC/Vitrious China) including stacking of useful materials near the site and disposal of unserviceable materials within 50 metres lead.	1.000	1.000	1.000	1.000	1.000	EACH		
	Repairs to plaster of thickness 12 mm to 20 mm in patches of area 2.5 sq. meters and under, including cutting the patch in proper shape, raking out joints and preparing and plastering the surface of the walls complete, including disposal of rubbish to the dumping ground, all complete as per directions of Engineer-In-Charge. With cement mortar 1:4 (1cement: 4 coarse sand)								
	In Existing Building	1.000	4.000	4.800	1.000	19.200	SQM		
	TOTAL					19.200	SQM		
	Say					20.000	SQM		
37	Providing and fixing plain jaffri door and window shutters including bright or/and black enamelled M.S. butt hinges with necessary screws 35x10 mm laths placed 35 mm apart (frames to be paid separately), including fixing 50x12 mm beading complete with : Second class teak wood								
	In Existing Building	0.000	2.100	1.200	1.000	0.000	M.SQ		
	TOTAL					0.000	M.SQ		
	Say					0.000	M.SQ		

PHC Hangola (Panchkula) - Civil works

S. No	Description of work	Nos	L in M	B in M	D in M	Qty	Unit	Unit Rate in Rs.	Total Rate in Rs.
38	Providing and laying water proofing treatment to vertical and horizontal surfaces of depressed portions of W.C., kitchen and the like consisting of: (i) 1st course of applying cement slurry @ 4.4 kg/sqm mixed with water proofing compound conforming to IS 2645 in recommended proportions including rounding off junction of vertical and horizontal surface. (ii) 2nd course of 20 mm cement plaster 1:3 (1 cement : 3 coarse sand) mixed with water proofing compound in recommended proportion including rounding off junction of vertical and horizontal surface. (iii) 3rd course of applying blown or residual bitumen applied hot at 1.7 kg. per sqm of area. (iv) 4th course of 400 micron thick PVC sheet. (Overlaps at joints of PVC sheet should be 100 mm wide and pasted to each other with bitumen @ 1.7 kg/ sqm).								
	In Existing Building	0.000	1.800	1.000	1.000	0.000	M.SQ		
	TOTAL					0.000	M.SQ		
	Say					0.000	M.SQ		
39	Dismantling Tile Flooring and Walls & Roof and disposing the debris away from site all complete as directed.								
	In Existing Building	1.000	8.600	4.000	1.000	34.400	M.SQ		
	In Existing Building	1.000	1.800	1.000	1.000	1.800	M.SQ		
	TOTAL					36.200	M.SQ		
	Say					42.000	M.SQ		
	DESIGN PRINTED TILES								

PHC Hangola (Panchkula) - Civil works

S. No	Description of work	Nos	L in M	B in M	D in M	Qty	Unit	Unit Rate in Rs.	Total Rate in Rs.
76	<p>Providing and laying 900MM*900MM or required size DESIGN PRINTED for display of Logo glazed tiles of printed series(Satin finish) in dado set in CM 1:3 with joints so as to form a true & even surface and joints finished neatly with white cement mixed with matching pigments all complete as directed. (Rate should include base plastering with CM 1:5 of required thickness.)</p> <p>The rate shall include cost of customized printing at top of the tile all complete as the details given by National Health Mission Haryana / HLL directed. (Kindly refer tender documents for Design details)</p>								
	NHM Writeup & Logo	1.000	4.000	0.750	1.000	3.000	SQM		
	Logo	6.000	0.900	0.900	1.000	4.860	SQM		
	TOTAL					7.860	SQM		
	Say					8.000	SQM		
77	<p>Providing and laying 300MM*900MM or required size DESIGN PRINTED for Windows & Door Borders glazed tiles of printed series(Satin finish) in dado set in CM 1:3 with joints so as to form a true & even surface and joints finished neatly with white cement mixed with matching pigments all complete as directed. (Rate should include base plastering with CM 1:5 of required thickness.)</p> <p>The rate shall include cost of customized printing at top of the tile all complete as the details given by National Health Mission Haryana / HLL directed. (Kindly refer tender documents for Design details)</p>								
	Window & Door Borders	6.000	2.400	0.230	4.000	13.248	SQM		
	Window & Door Borders	1.000	10.200	0.230	1.000	2.346	SQM		
	TOTAL					15.594	SQM		

PHC Hangola (Panchkula) - Civil works

S. No	Description of work	Nos	L in M	B in M	D in M	Qty	Unit	Unit Rate in Rs.	Total Rate in Rs.
	Say					16.000	SQM		
PLUMBING									
41	Providing and fixing gun metal gate valve with C.I. wheel of approved quality -25MM	1.000	1.000	1.000	1.000	1.000	EACH		
42	Providing and fixing C.P. brass angle valve for basin mixer and geyserpoints of approved quality conforming to IS:8931 a) 15 mm nominal bore: 15 mm nominal bore. Make:Hindware,Cera,Jaquar etc..	0.000	1.000	1.000	1.000	0.000	EACH		
43	Providing and fixing PTMT Bottle Trap for Wash basin and sink.Bottle trap 38mm single piece moulded with height of 270mm, effective length of tail pipe 260mm from the centre of the waste coupling 77mm breadth with 25mm minimum water seal, weighing not less than 263gms.	0.000	1.000	1.000	1.000	0.000	EACH		
44	Providing and fixing trap of self cleansing design with screwed down orhinged grating with or without vent arm complete, including cost of cuttingand making good the walls and floors :100 mm inlet and 100 mm outlet	1.000	1.000	1.000	1.000	1.000	EACH		
45	Constructing brick masonry manhole in cement mortar 1:4 (1 cement : 4 coarse sand) with R.C.C. top slab with 1:2:4 mix (1 cement : 2 coarse sand : 4 graded stone aggregate 20 mm nominal size), foundation concrete 1:4:8 mix (1 cement : 4 coarse sand : 8 graded stone aggregate 40 mm nominal size), inside plastering 12 mm thick with cement mortar 1:3 (1 cement : 3 coarse sand) finished with floating coat of neat cement and making channels in cement concrete 1:2:4 (1 cement : 2 coarse sand : 4 graded stone	QRO	1.000	1.000	1.000	0.000	EACH		

PHC Hangola (Panchkula) - Civil works

S. No	Description of work	Nos	L in M	B in M	D in M	Qty	Unit	Unit Rate in Rs.	Total Rate in Rs.
	aggregate 20 mm nominal size) finished with a floating coat of neat cement complete as per standard design : With common burnt clay F.P.S designation 7.5								
46	Providing and fixing square - mouth PVC. Gully trap grade "A" complete with CI grating brick masonry chamber with water tight tight CI cover with frame of 300 x 300mm size (inside) the weight of cover to be not less than 4.50 kg and frame to be not less than 2.70 kg as per standard design	1.000	1.000	1.000	1.000	1.000	EACH		
47	Providing and fixing white vitreous china pedestal type water closet(European type W.C. pan) with seat and lid, 10 litre low level white P.V.C.flushing cistern, including flush pipe, with manually controlled device(handle lever), conforming to IS : 7231, with all fittings and fixturescomplete, including cutting and making good the walls and floors wherever required :W.C. pan with ISI marked white solid plastic seat and lid	1.000	1.000	1.000	1.000	1.000	EACH		
48	Providing and fixing wash basin with C.I. brackets, 15 mm C.P. brasspillar taps, 32 mm C.P. brass waste of standard pattern, including paintingof fittings and brackets, cutting and making good the walls whereverrequire:White Vitreous China Wash basin size 630x450 mm with apair of 15 mm C.P. brass pillar taps	1.000	1.000	1.000	1.000	1.000	EACH		

PHC Hangola (Panchkula) - Civil works

S. No	Description of work	Nos	L in M	B in M	D in M	Qty	Unit	Unit Rate in Rs.	Total Rate in Rs.
	Providing and fixing Chlorinated Polyvinyl Chloride (CPVC) pipes, having thermal stability for hot & cold water supply including all CPVC plain & brass threaded fittings i/c fixing the pipe with clamps at 1.00 m spacing. This includes jointing of pipes & fittings with one step CPVC solvent cement and the cost of cutting chases and making good the same including testing of joints complete as per direction of Engineer in Charge. Concealed work including cutting chases and making good the walls etc								
49	20 mm nominal outer dia .Pipes	10.000	1.000	1.000	1.000	10.000	RM		
50	32 mm nominal outer dia Pipes	10.000	1.000	1.000	1.000	10.000	RM		
51	50 mm nominal outer dia Pipes	6.000	1.000	1.000	1.000	6.000	RM		
52	Providing and fixing Stainless Steel A ISI 304 (18/8) kitchen sink as per IS: 13983 with C.I. brackets and stainless steel plug 40 mm, including painting of fittings and brackets, cutting and making good the walls wherever required ::(Lowest retail price of sink not less than Rs. 3150)								
53	Kitchen sink without drain board, Size -610x510 mm bowl depth 200 mm	0.000	1.000	1.000	1.000	0.000	EACH		
54	Providing and fixing PVC Waste pipe for sink or wash basin including PVC waste fittings complete. :Semi rigid pipe 32mm dia	10.000	1.000	1.000	1.000	10.000	EACH		
55	Providing and fixing CP Waste coupling for wash basin and sink of approved quality, colour and make. Waste coupling 31mm of 79mm length and 62mm breadth, weighing not less than 45 gms. Make:Hindware, Jaquar etc.,	10.000	1.000	1.000	1.000	10.000	EACH		

PHC Hangola (Panchkula) - Civil works

S. No	Description of work	Nos	L in M	B in M	D in M	Qty	Unit	Unit Rate in Rs.	Total Rate in Rs.
56	Extra for providing opening of required size & shape for wash basin/ kitchen sink in kitchen platform, vanity counter and similar location in marble/ Granite/stone work, including necessary holes for pillar taps etc. including moulding, rubbing and polishing of cut edges etc. complete.	0.000	1.000	1.000	1.000	0.000	EACH		
57	Providing and fixing 600x450 mm beveled edge mirror of superior glass (of approved quality) complete with 6 mm thick hard board ground fixed to wooden cleats with C.P. brass screws and washers complete.	1.000	1.000	1.000	1.000	1.000	EACH		
58	Providing and fixing PTMT towel rail complete with brackets fixed to wooden cleats with CP brass screws with concealed fitting arrangement of approved quality and colour. 600mm long towel rail with total length of 645mm, width 78mm and effective height of 88mm, weighing not less than 190gms.	1.000	1.000	1.000	1.000	1.000	EACH		
59	Providing and fixing PTMT liquid soap container 109mm wide, 125mm high and 112mm distance from wall of standard shape with bracket of the same materials with snap fittings of approved quality and colour. weighing not less than 105 gms.	1.000	1.000	1.000	1.000	1.000	EACH		
60	Providing and fixing 8 mm dia C.P. / S.S. Jet with flexible tube upto 1 metre long with S.S. triangular plate to European type W.C. of quality and make as approved by Engineer - in - charge.	1.000	1.000	1.000	1.000	1.000	EACH		
61	Providing and fixing PTMT grating of approved quality and colour. Rectangular type with openable circular lid								

PHC Hangola (Panchkula) - Civil works

S. No	Description of work	Nos	L in M	B in M	D in M	Qty	Unit	Unit Rate in Rs.	Total Rate in Rs.
	150 mm nominal size square 100 mm diameter of the inner hinged round grating	1.000	1.000	1.000	1.000	1.000	EACH		
LMR ITEMS									
	STEEL ALMIRAH								
	1. Internal Size of Almirah: 1850 (H) X 900 (W) X 450 (D) mm								
	2. Leg Size of Almirah: 150 (H) X 120 (W) X 450 (D) mm								
	3. Rack with 5 Compartments of 4 no. of shelves. Distance between each shelf will be 360 mm. These 4 shelves should be hanging arrangement (adjustable).								
	4. Standard lock and 2 sets of keys.								
	5. The thickness of the Almirah sheet shall be 18 SWG.								
	6. The body of the Almirah shall be manufactured from cold rolled MS sheet (C. R. Sheet) with Antirust treatment and shall be finished with powder coating.								
	7. Color of paint: grey color (spray painting).								
	8. Paint Brand: Standard brand like Asian/Berger/Nerolac etc.								
	9. The quality of used M.S sheet for making Almirah shall be free from any pitting and corrosion etc.								
	10. H/D Rubber bushes shall be provided to the bottom of legs of Almirah.								
79	Supply of the steel almirah of make BADRA or India Steel or equivalent as per the manufacturer specifications . Size: 2000 (H) X 900 (W) X 450 (D) mm	1.000	1.000	1.000	1.000	1.000	EACH		
	Supply and fixing of 3 MM Sun board with digital vinyl printing Size: Required size as per the direction from Engineer incharge	26.000	1.000	1.000	1.000	26.000	MSQ		

PHC Hangola (Panchkula) - Civil works

S. No	Description of work	Nos	L in M	B in M	D in M	Qty	Unit	Unit Rate in Rs.	Total Rate in Rs.
	WHITE BOARD with glass box								
83	Supply and fixing of White Boards - Size 4' x 4' Ceramic steel magnetic white board with 0.4 mm ceramic steel writing surface having e3 ceramic steel engrave on the surface, 9mm MDF as core material, 0.25 galvanized steel sheets as a backing material. The board will have aluminum anodized frame with black ABS Moulded corner. Note, Quoted price inclusive of cover box made of aluminium openalble glass door cover box	1.000	1.000	1.000	1.000	1.000	EACH		
84	Supply and fixing of White Boards - Size 6' x 4' Ceramic steel magnetic white board with 0.4 mm ceramic steel writing surface having e3 ceramic steel engrave on the surface, 9mm MDF as core material, 0.25 galvanized steel sheets as a backing material. The board will have aluminum anodized frame with black ABS Moulded corner. Note, Quoted price inclusive of cover box made of aluminium openalble glass door cover box	1.000	1.000	1.000	1.000	1.000	EACH		
	CURTAIN								
	2. Both for doors, windows and partions.								
	3. Assorted colours plain & prints								
	4.Stitched as per site/ size requirement								
	5.Minor modifications in stitching as per site/ size requirement								
	6.Preferred colour (Brown, Cream, Beige)								
	7.Curtain price (including cloth & curtain rod) to be quoted in Squire metre								
	8.Stitching for each curtain to be absorb in the price of the cloth generally 2 meters.								
	9.Fast colours, water wash								
	10.Fabric density Non Transparent Composition								

PHC Hangola (Panchkula) - Civil works

S. No	Description of work	Nos	L in M	B in M	D in M	Qty	Unit	Unit Rate in Rs.	Total Rate in Rs.
	11.Fabric of curtain shall be soft texture, great shading, drape effect and nice doobby.								
	12.The bracket shall be side mounted and front mounted as required								
	13.First rod mount is 3.5 inches from the wall.								
	14.Where curtain used as a partition/ long length, sufficient support from ceiling should be provided to avoid sagging.								
	15.Rate quoted for fully stitched Curtain with top nepha with punch holes after lining bucramreinforced with SS / PVC islets and lower nepha 200mm double turned.								
	Type -I (Surgical Curtain)								
85	Curtain fabric weight shall be up to 275-300 (±5%) gsm Composition of fabric shall be polyester yarn I.E. 300 denier fast colour sink age shall be (±5%) Weft and warp shall be polyester / cotton polyester mix								
	OT Area	1.000	3.000	2.100	1.000	6.300	EACH		
	TOTAL					6.300	EACH		
	Say					7.000	EACH		
	Total Amt in Rs.								
	GST @ 18%								
	Grand Total in Rs.								

PHC Hangola (Panchkula) – Electrical works					
SL No.	Description of work	Qty	Unit	Unit Rate in Rs.	Total Rate in Rs.
1	Point wiring in PVC conduit with modular type switch.				
	Wiring for light point/ fan point/ exhaust fan point/ call bell point with 1.5 sq.mm FRLS PVC insulated copper conductor single core cable in surface / recessed medium class PVC conduit, with modular switch, modular plate, suitable GI box and earthing the point with 1.5 sq.mm FRLS PVC insulated copper conductor single core cable etc. as required. switch, modular plate, suitable GI box and earthing the point with 1.5 sq.mm FRLS PVC insulated copper conductor single core cable etc. as required.				
	Group C	0	Point		
2	Wiring through PVC conduit				
	Wiring for circuit/submain wiring along with earth wire with the following sizes of FR PVC insulated copper conductor, single core cable in surface/recessed medium class PVC conduit as required.(Make:Havells/Finolex/V-guard/Polycab)				
a	2X1.5 sq.mm + 1X1.5 sq.mm earth wire	20	Metre		
b	2X2.5 sq.mm + 1 X2.5 sq mm earth wire	0	Metre		
c	2X4 sq.mm + 1X4 sq.mm earth wire	0	Metre		
3	Telephone wiring in existing conduit:				
	Supplying and drawing following pair 0.5 sq mm FR PVC insulated annealed copper conductor, unarmored telephone cable in the existing surface/ recessed steel/ PVC conduit as required.				
a	2 Pair	0	Metre		
4	A/C point				
	S/F 20A SPN MCB industrial socket outlet: Supplying and fixing 20 amps, 240 volts, SPN industrial type, socket outlet, with 2 pole and earth, metal enclosed plug top alongwith 20 amps "C" curve, SP, MCB, in sheet steel enclosure, on surface or in recess, with chained metal cover for the socket out let and complete with connections, testing and commissioning etc. as required.(Make: Legrand/Havells/HPL)	0	Point		
5	Modular type blanking plate:				
	Supplying and fixing modular blanking plate on the existing modular plate & switch box excluding modular plate as required.(Make: Legrand/Havells/HPL)	0	Each		
6	Modular boxes, bases & cover plate:				
	Supplying and fixing following size/modules, GI box along with modular base & cover plate for modular switches in recess etc as required.(Make: Legrand/Havells/HPL)				
a	2 module	0	Each		
b	3 module	0	Each		
c	4 module	0	Each		
d	6 module	0	Each		
e	8 module	0	Each		
f	12 module	0	Each		
7	Modular type switch/socket:				
	Supplying and fixing following modular switch/socket on the existing modular plate & switch box including connections but excluding modular plate etc as required. (Make: Legrand/Havells/HPL)				
a	5/6 Amps switch	0	Each		

PHC Hangola (Panchkula) – Electrical works					
SL No.	Description of work	Qty	Unit	Unit Rate in Rs.	Total Rate in Rs.
b	3 pin 5/6 Amp socket outlet	0	Each		
c	15/16 Amps switch	0	Each		
d	6pin 15/16 Amps (universal) socket outlet	0	Each		
e	Telephone socket outlet	0	Each		
8	S/F PVC conduit:				
	Supplying and fixing of following sizes of medium class PVC conduit/Casing Cap along with accessories in surface/recess including cutting the wall and making good the same in case of recessed conduit as required.(ISI Make)				
a	20 mm	200	Metre		
b	25 mm	0	Metre		
	Installation Testing & Commissioning				
9	ITC Fluorescent fitting directly on surface: Installation, testing and commissioning of pre-wired, fluorescent fitting / compact fluorescent fitting/LED of all types, complete with all accessories and tube etc. directly on ceiling/ wall, including connection with 1.5 sq. mm FR PVC insulated, copper conductor, single core cable and earthing etc. as required.	6	Each		
10	ITC Ceiling fan/Wall fan: Installation, testing and commissioning of ceiling fan, including wiring the down rods of standard length (upto 30 cm) with 1.5 sq. mm FR PVC insulated, copper conductor, single core cable etc. as required.	0	Each		
11	Supplying and fixing two module stepped type electronic fan regulator on the existing modular plate switch box including connections but excluding modular plate etc. as required.	0	Each		
12	LAYING OF CABLES				
	CABLE LAYING				
	Wiring for circuit/ submain wiring alongwith earth wire with the following sizes of FRLS PVC insulated copper conductor, single core cable in surface/ recessed medium class PVC conduit as required.				
a	FROM Mains TO DB				
	2 X 4 sq. mm + 1 X 4 sq. mm earth wire	0	Metre		
13	END TERMINATION				
	Supply and making end termination with brass compression gland, earth clip and aluminium lugs for following size of PVC insulated and PVC sheathed/XLPE aluminium conductor cable fo 1.1KV grade as required.				
	2 X 4 sq. mm + 1 X 4 sq. mm earth wire	0	Each		
15	S/F of SPN MCB PDB				
	Supplying and fixing following way, single pole and neutral, sheet steel, MCB distribution board, 240 V, on surface/ recess, complete with tinned copper bus bar, neutral bus bar, earth bar, din bar, interconnections, powder painted including earthing etc. as required. (But without MCB/RCCB/Isolator)				
a	6 way Double door, horizontal type	0	Each		
b	16 way Double door ,horizontal type	0	Each		
C	12 way Double door ,horizontal type	0	Each		

PHC Hangola (Panchkula) – Electrical works					
SL No.	Description of work	Qty	Unit	Unit Rate in Rs.	Total Rate in Rs.
16	S/F OF SP MCB				
	Supplying and fixing 5 A to 32 A rating, 240/415 V, 10 kA, “C” curve, miniature circuit breaker suitable for inductive load of following poles in the existing MCB DB complete with connections, testing and commissioning etc. as required.				
	6/32 A SP MCB	0	Each		
17	S/F DP ISOLATOR				
	Supplying and fixing following rating, double pole, (single phase and neutral), 240 volts, ISOLATOR having a sensitivity current upto 100 to 300 milliamperes in the existing MCB DB complete with connections, testing and commissioning etc, as required.(Make: Legrand/Havells/HPL)				
	40 A	0	Each		
18	S/F DP RCCB				
	Supplying and fixing following rating, double pole, (single phase and neutral), 240 V, residual current circuit breaker (RCCB), having a sensitivity current 30 mA in the existing MCB DB complete with connections, testing and commissioning etc. as required.				
	25 A	0	Each		
SUB TOTAL A @ SR 2016					
NDSR ITEMS					
1.1	Supply of 15W LED tube fitting sleek with decorative end cap, powder coated CRCA steel channel complete with all electrical accessories like electronic ballast, lamp holder, 28W LED lamp etc complete as required. (Philips / Wipro /HAVELLS)	3	Each		
1.2	Supply and installation of 18 W CFL with its all accessories.[ISI MAKE]	3	Each		
1.3	Supply and installation of wall fan, white colour, 5 star rated as per BEE complete with blades, casing , wall mounting accessories etc(Make Havells/bajaj/usha/V-guard/crompton)	0	Each		
1.4	Supply and installation EXHAUST FAN,SHUTTER TYPE white colour, 9" OR 10" star rated as per BEE complete with its all accessories(Make Havells/bajaj/usha/V-guard)	0	Each		
2	Miscellaneous Items				
3	CABLE SUPPLY				
	Supplying the following PVC insulated and PVC sheathed/XLPE power cable of 1.1 KV grade as per CPWD standards as required. (Make:Havells/ Glostar/Nicco/Finolex/Polycab)				
	2 X 4 sq. mm + 1 X 4 sq. mm earth wire (3 Nos. of 4 Sq.mm wire)	0	Metre		
Total Amt in Rs.					
GST @ 18%					
Grand Total in Rs.					

2) Primary Health Centre, Kot – Pachkula District

PHC Kot (Panchkula) - Civil works									
S. No	Description of work	Nos	L in M	B in M	D in M	Qty	Unit	Unit Rate in Rs.	Total Rate in Rs.
EARTH WORK									
3	Surface dressing of the ground including removing vegetation and in equalities not exceeding 15 cm deep and disposal of rubbish, lead up to 50 m and lift up to 1.5 m.								
	For Passage Area	1.000	12.000	5.000	1.000	60.000	M.SQ		
	For Nearby Waiting Area Side	1.000	12.000	3.000	1.000	36.000	M.SQ		
	TOTAL					96.000	M.SQ		
	Say					96.000	M.SQ		
4	Clearing jungle including uprooting of rank vegetation, grass, brush wood, trees and saplings of girth up to 30 cm measured at a height of 1 m above ground level and removal of rubbish up to a distance of 50 m outside the periphery of the area cleared.								
	For Passage Area	1.000	12.000	5.000	1.000	60.000	M.SQ		
	For Nearby Waiting Area Side	1.000	12.000	3.000	1.000	36.000	M.SQ		
	TOTAL					96.000	M.SQ		
	Say					96.000	M.SQ		
9	Half brick masonry with common burnt clay F.P.S. (non modular) bricks of class designation 7.5 in superstructure above plinth level up to floor V level. Cement mortar 1:3 (1 cement :3 coarse sand)								
	Labour Room Partition	1.000	5.000	2.100	1.000	10.500	M.SQ		
	TOTAL					10.500	M.SQ		
	Say					11.000	M.SQ		
FLOORING									

PHC Kot (Panchkula) - Civil works

S. No	Description of work	Nos	L in M	B in M	D in M	Qty	Unit	Unit Rate in Rs.	Total Rate in Rs.
10	Providing and laying vitrified floor tiles in different sizes (thickness to be specified by the manufacturer) with water absorption less than 0.08% and conforming to IS: 15622, of approved make, in all colours and shades, laid on 20mm thick cement mortar 1:4 (1 cement : 4 coarse sand), jointing with grey cement slurry @ 3.3kg/sqm including grouting the joints with white cement and matching pigments etc., complete. Size of Tile 600x600 mm								
	Floor Tile	1.000	3.000	6.000	1.000	18.000	M.SQ		
	Dismantling Quantity	LS				0.000	M.SQ		
	Passage Floor	0.000	14.000	2.800	1.000	0.000	M.SQ		
	TOTAL					18.000	M.SQ		
	Say					18.000	M.SQ		
11	Providing and fixing 1st quality ceramic glazed floor tiles conforming to IS : 15622 (thickness to be specified by the manufacturer) of approved make in all colours, shades except burgundy, bottle green, black of any size as approved by Engineer-in-Charge in skirting, risers of steps and dados over 12 mm thick bed of cement Mortar 1:3 (1 cement: 3 coarse sand) and jointing with grey cement slurry @ 3.3kg per sqm including pointing in white cement mixed with pigment of matching shade complete.								
	Toilet	3.000	1.600	2.100	3.000	30.240	M.SQ		
	TOTAL					30.240	M.SQ		
	Say					31.000	M.SQ		

PHC Kot (Panchkula) - Civil works

S. No	Description of work	Nos	L in M	B in M	D in M	Qty	Unit	Unit Rate in Rs.	Total Rate in Rs.
	Existing Wall All around	8.000	6.000	3.600	1.000	172.800	M.SQ		
	TOTAL					172.800	M.SQ		
	Say					173.000	M.SQ		
28	Painting wood work with Deluxe Multi Surface Paint of required shade. Two or more coat applied @ 0.90 ltr/10 sqm over an under coat of primer applied @0.75 ltr/10 sqm of approved brand and manufacture								
	Wooden Door	4.000	12.000	2.100	1.000	100.800	M.SQ		
	TOTAL					100.800	M.SQ		
	Say					101.000	M.SQ		
29	Painting Steel work with Deluxe Multi Surface Paint to give an even shade. Two or more coat applied @ 0.90 ltr/ 10 sqm over an under coat of primer applied @ 0.80 ltr/ 10 sqm of approved brand and manufacture								
	Steel Windows	1.000	7.000	6.000	1.000	42.000	M.SQ		
	Truss Work Painting	12.000	1.500	1.500	1.000	27.000	M.SQ		
	TOTAL					69.000	M.SQ		
	Say					69.000	M.SQ		
30	Providing and applying plaster of paris putty of 2 mm thickness over plastered surface to prepare the surface even and smooth complete.								
	Interior Qunatity	1.000	175.000	1.000	1.000	175.000	M.SQ		
	TOTAL					175.000	M.SQ		
	Say					175.000	M.SQ		
31	Removing white or colour wash by scrapping and sand papering and preparing the surface smooth including necessary repairs to scratches etc. complete								
	Existing Interior Quantity	1.000	173.000	1.000	1.000	173.000	M.SQ		
	Existing Exterior Quantity	1.000	634.000	1.000	1.000	634.000	M.SQ		
	TOTAL					807.000	M.SQ		
	Say					807.000	M.SQ		

PHC Kot (Panchkula) - Civil works

S. No	Description of work	Nos	L in M	B in M	D in M	Qty	Unit	Unit Rate in Rs.	Total Rate in Rs.
	In Existing Building	1.000	2.000	1.800	1.000	3.600	SQM		
	TOTAL					3.600	SQM		
	Say					4.000	SQM		
36	Dismantling of flushing cistern of all types (C.I./PVC/Vitrious China) including stacking of useful materials near the site and disposal of unserviceable materials within 50 metres lead.	1.000	1.000	1.000	1.000	1.000	EACH		
	Repairs to plaster of thickness 12 mm to 20 mm in patches of area 2.5 sq. meters and under, including cutting the patch in proper shape, raking out joints and preparing and plastering the surface of the walls complete, including disposal of rubbish to the dumping ground, all complete as per directions of Engineer-In-Charge. With cement mortar 1:4 (1cement: 4 coarse sand)								
	In Existing Building	0.000	4.000	4.800	1.000	0.000	SQM		
	TOTAL					0.000	SQM		
	Say					0.000	SQM		
37	Providing and fixing plain jaffri door and window shutters including bright or/and black enamelled M.S. butt hinges with necessary screws 35x10 mm laths placed 35 mm apart (frames to be paid separately), including fixing 50x12 mm beading complete with : Second class teak wood								
	In Existing Building	0.000	2.100	1.200	1.000	0.000	M.SQ		
	TOTAL					0.000	M.SQ		
	Say					0.000	M.SQ		

PHC Kot (Panchkula) - Civil works

S. No	Description of work	Nos	L in M	B in M	D in M	Qty	Unit	Unit Rate in Rs.	Total Rate in Rs.
	Window & Door Borders	16.000	2.100	0.230	4.000	30.912	SQM		
	Window & Door Borders	1.000	10.200	0.230	1.000	2.346	SQM		
	TOTAL					33.258	SQM		
	Say					34.000	SQM		
PLUMBING									
41	Providing and fixing gun metal gate valve with C.I. wheel of approved quality - 25MM	1.000	1.000	1.000	1.000	1.000	EACH		
42	Providing and fixing C.P. brass angle valve for basin mixer and geyserpoints of approved quality conforming to IS:8931 a) 15 mm nominal bore: 15 mm nominal bore.Make:Hindware,Cera,Ja quar etc..	0.000	1.000	1.000	1.000	0.000	EACH		
43	Providing and fixing PTMT Bottle Trap for Wash basin and sink.Bottle trap 38mm single piece moulded with height of 270mm, effective length of tail pipe 260mm from the centre of the waste coupling 77mm breadth with 25mm minimum water seal, weighing not less than 263gms.	0.000	1.000	1.000	1.000	0.000	EACH		
44	Providing and fixing trap of self cleansing design with screwed down orhinged grating with or without vent arm complete, including cost of cuttingand making good the walls and floors :100 mm inlet and 100 mm outlet	1.000	1.000	1.000	1.000	1.000	EACH		

PHC Kot (Panchkula) - Civil works

S. No	Description of work	Nos	L in M	B in M	D in M	Qty	Unit	Unit Rate in Rs.	Total Rate in Rs.
45	Constructing brick masonry manhole in cement mortar 1:4 (1 cement : 4 coarse sand) with R.C.C. top slab with 1:2:4 mix (1 cement : 2 coarse sand : 4 graded stone aggregate 20 mm nominal size), foundation concrete 1:4:8 mix (1 cement : 4 coarse sand : 8 graded stone aggregate 40 mm nominal size), inside plastering 12 mm thick with cement mortar 1:3 (1 cement : 3 coarse sand) finished with floating coat of neat cement and making channels in cement concrete 1:2:4 (1 cement : 2 coarse sand : 4 graded stone aggregate 20 mm nominal size) finished with a floating coat of neat cement complete as per standard design : With common burnt clay F.P.S designation 7.5	QRO	1.000	1.000	1.000	0.000	EACH		
46	Providing and fixing square - mouth PVC. Gully trap grade "A" complete with CI grating brick masonry chamber with water tight tight CI cover with frame of 300 x 300mm size (inside) the weight of cover to be not less than 4.50 kg and frame to be not less than 2.70 kg as per standard design	5.000	1.000	1.000	1.000	5.000	EACH		
47	Providing and fixing white vitreous china pedestal type water closet(European type W.C. pan) with seat and lid, 10 litre low level white P.V.C.flushing cistern, including flush pipe, with manually controlled device(handle lever), conforming to IS : 7231, with all fittings and fixturescomplete, including cutting and making good the walls and floors wherever required :W.C. pan with ISI marked white solid plastic seat and lid	5.000	1.000	1.000	1.000	5.000	EACH		

PHC Kot (Panchkula) - Civil works

S. No	Description of work	Nos	L in M	B in M	D in M	Qty	Unit	Unit Rate in Rs.	Total Rate in Rs.
52	Providing and fixing Stainless Steel A ISI 304 (18/8) kitchen sink as per IS: 13983 with C.I. brackets and stainless steel plug 40 mm, including painting of fittings and brackets, cutting and making good the walls wherever required ::(Lowest retail price of sink not less than Rs. 3150)								
53	Kitchen sink without drain board, Size -610x510 mm bowl depth 200 mm	0.000	1.000	1.000	1.000	0.000	EACH		
54	Providing and fixing PVC Waste pipe for sink or wash basin including PVC waste fittings complete.:Semi rigid pipe 32mm dia	2.000	1.000	1.000	1.000	2.000	EACH		
55	Providing and fixing CP Waste coupling for wash basin and sink of approved quality, colour and make. Waste coupling 31mm of 79mm length and 62mm breadth, weighing not less than 45 gms. Make:Hindware, Jaquar etc.,	0.000	1.000	1.000	1.000	0.000	EACH		
56	Extra for providing opening of required size & shape for wash basin/ kitchen sink in kitchen platform, vanity counter and similar location in marble/ Granite/stone work, including necessary holes for pillar taps etc. including moulding, rubbing and polishing of cut edges etc. complete.	0.000	1.000	1.000	1.000	0.000	EACH		
57	Providing and fixing 600x450 mm beveled edge mirror of superior glass (of approved quality) complete with 6 mm thick hard board ground fixed to wooden cleats with C.P. brass screws and washers complete.	1.000	1.000	1.000	1.000	1.000	EACH		

PHC Kot (Panchkula) - Civil works

S. No	Description of work	Nos	L in M	B in M	D in M	Qty	Unit	Unit Rate in Rs.	Total Rate in Rs.
	4. Standard lock and 2 sets of keys.								
	5. The thickness of the Almirah sheet shall be 18 SWG.								
	6. The body of the Almirah shall be manufactured from cold rolled MS sheet (C. R. Sheet) with Antirust treatment and shall be finished with powder coating.								
	7. Color of paint: grey color (spray painting).								
	8. Paint Brand: Standard brand like Asian/Berger/Nerolac etc.								
	9. The quality of used M.S sheet for making Almirah shall be free from any pitting and corrosion etc.								
	10. H/D Rubber bushes shall be provided to the bottom of legs of Almirah.								
79	Supply of the steel almirah of make BADRA or India Steel or equivalent as per the manufacturer specifications . Size: 2000 (H) X 900 (W) X 450 (D) mm	1.000	1.000	1.000	1.000	1.000	EACH		
	Supply and fixing of 3 MM Sun board with digital vinyl printing Size: Required size as per the direction from Engineer incharge	26.00 0	1.000	1.000	1.000	26.000	MSQ		
	WHITE BOARD with glass box								
83	Supply and fixing of White Boards - Size 4' x 4' Ceramic steel magnetic white board with 0.4 mm ceramic steel writing surface having e3 ceramic steel engrave on the surface, 9mm MDF as core material, 0.25 galvanized steel sheets as a backing material. The board will have aluminum anodized frame with black ABS Moulded corner. Note, Quoted price inclusive of cover box made of aluminium openable glass door cover box	1.000	1.000	1.000	1.000	1.000	EACH		

PHC Kot (Panchkula) – Electrical works					
SL No.	Description of work	Qty	Unit	Unit Rate in Rs.	Total Rate in Rs.
1	Point wiring in PVC conduit with modular type switch.				
	Wiring for light point/ fan point/ exhaust fan point/ call bell point with 1.5 sq.mm FRLS PVC insulated copper conductor single core cable in surface / recessed medium class PVC conduit, with modular switch, modular plate, suitable GI box and earthing the point with 1.5 sq.mm FRLS PVC insulated copper conductor single core cable etc. as required. switch, modular plate, suitable GI box and earthing the point with 1.5 sq.mm FRLS PVC insulated copper conductor single core cable etc. as required.				
	Group C	0	Point		
2	Wiring through PVC conduit				
	Wiring for circuit/submain wiring along with earth wire with the following sizes of FR PVC insulated copper conductor, single core cable in surface/recessed medium class PVC conduit as required.(Make:Havells/Finox/V-guard/Polycab)				
a	2X1.5 sq.mm + 1X1.5 sq.mm earth wire	0	Metre		
b	2X2.5 sq.mm + 1 X2.5 sq mm earth wire	0	Metre		
c	2X4 sq.mm + 1X4 sq.mm earth wire	0	Metre		
3	Telephone wiring in existing conduit:				
	Supplying and drawing following pair 0.5 sq mm FR PVC insulated annealed copper conductor, unarmored telephone cable in the existing surface/ recessed steel/ PVC conduit as required.				
a	2 Pair	0	Metre		
4	A/C point				
	S/F 20A SPN MCB industrial socket outlet: Supplying and fixing 20 amps, 240 volts, SPN industrial type, socket outlet, with 2 pole and earth, metal enclosed plug top alongwith 20 amps "C" curve, SP, MCB, in sheet steel enclosure, on surface or in recess, with chained metal cover for the socket out let and complete with connections, testing and commissioning etc. as required.(Make: Legrand/Havells/HPL)	0	Point		
5	Modular type blanking plate:				
	Supplying and fixing modular blanking plate on the existing modular plate & switch box excluding modular plate as required.(Make: Legrand/Havells/HPL)	0	Each		
6	Modular boxes, bases & cover plate:				
	Supplying and fixing following size/modules, GI box along with modular base & cover plate for modular switches in recess etc as required.(Make: Legrand/Havells/HPL)				
a	2 module	0	Each		
b	3 module	0	Each		
c	4 module	0	Each		
d	6 module	0	Each		
e	8 module	0	Each		
f	12 module	0	Each		
7	Modular type switch/socket:				

PHC Kot (Panchkula) – Electrical works					
SL No.	Description of work	Qty	Unit	Unit Rate in Rs.	Total Rate in Rs.
	Supplying and fixing following modular switch/socket on the existing modular plate & switch box including connections but excluding modular plate etc as required. (Make: Legrand/Havells/HPL)				
a	5/6 Amps switch	0	Each		
b	3 pin 5/6 Amp socket outlet	0	Each		
c	15/16 Amps switch	0	Each		
d	6pin 15/16 Amps (universal) socket outlet	0	Each		
e	Telephone socket outlet	0	Each		
8	S/F PVC conduit:				
	Supplying and fixing of following sizes of medium class PVC conduit along with accessories in surface/recess including cutting the wall and making good the same in case of recessed conduit as required.(ISI Make)				
a	20 mm	0	Metre		
b	25 mm	0	Metre		
	Installation Testing & Commissioning				
9	ITC Fluorescent fitting directly on surface: Installation, testing and commissioning of pre-wired, fluorescent fitting / compact fluorescent fitting/LED of all types, complete with all accessories and tube etc. directly on ceiling/ wall, including connection with 1.5 sq. mm FR PVC insulated, copper conductor, single core cable and earthing etc. as required.	0	Each		
10	ITC Ceiling fan/Wall fan: Installation, testing and commissioning of ceiling fan, including wiring the down rods of standard length (upto 30 cm) with 1.5 sq. mm FR PVC insulated, copper conductor, single core cable etc. as required.	0	Each		
11	Supplying and fixing two module stepped type electronic fan regulator on the existing modular plate switch box including connections but excluding modular plate etc. as required.	0	Each		
12	LAYING OF CABLES				
	CABLE LAYING				
	Wiring for circuit/ submain wiring alongwith earth wire with the following sizes of FRLS PVC insulated copper conductor, single core cable in surface/ recessed medium class PVC conduit as required.				
a	FROM Mains TO DB				
	2 X 4 sq. mm + 1 X 4 sq. mm earth wire	0	Metre		
13	END TERMINATION				
	Supply and making end termination with brass compression gland, earth clip and aluminium lugs for following size of PVC insulated and PVC sheathed/XLPE aluminium conductor cable fo 1.1KV grade as required.				
	2 X 4 sq. mm + 1 X 4 sq. mm earth wire	0	Each		
15	S/F of SPN MCB PDB				
	Supplying and fixing following way, single pole and neutral, sheet steel, MCB distribution board, 240 V, on surface/ recess, complete with tinned copper bus bar, neutral bus bar, earth bar, din bar, interconnections, powder painted including earthing etc. as required. (But without MCB/RCCB/Isolator)				
a	6 way Double door, horizontal type	0	Each		

PHC Kot (Panchkula) – Electrical works					
SL No.	Description of work	Qty	Unit	Unit Rate in Rs.	Total Rate in Rs.
b	16 way Double door ,horizontal type	0	Each		
C	12 way Double door ,horizontal type	0	Each		
16	S/F OF SP MCB				
	Supplying and fixing 5 A to 32 A rating, 240/415 V, 10 kA, “C” curve, miniature circuit breaker suitable for inductive load of following poles in the existing MCB DB complete with connections, testing and commissioning etc. as required.				
	6/32 A SP MCB	0	Each		
17	S/F DP ISOLATOR				
	Supplying and fixing following rating, double pole, (single phase and neutral), 240 volts, ISOLATOR having a sensitivity current upto 100 to 300 milliamperes in the existing MCB DB complete with connections, testing and commissioning etc, as required.(Make: Legrand/Havells/HPL)				
	40 A	0	Each		
18	S/F DP RCCB				
	Supplying and fixing following rating, double pole, (single phase and neutral), 240 V, residual current circuit breaker (RCCB), having a sensitivity current 30 mA in the existing MCB DB complete with connections, testing and commissioning etc. as required.				
	25 A	0	Each		
NDSR ITEMS					
1.1	Supply of 15W LED tube fitting sleek with decorative end cap, powder coated CRCA steel channel complete with all electrical accessories like electronic ballast, lamp holder, 28W LED lamp etc complete as required. (Philips / Wipro /HAVELLS)	0	Each		
1.2	Supply and installation of 18 W CFL with its all accessories.[ISI MAKE]	0	Each		
1.3	Supply and installation of wall fan, white colour, 5 star rated as per BEE complete with blades, casing , wall mounting accessories etc(Make Havells/bajaj/usha/V-guard/crompton)	0	Each		
1.4	Supply and installation EXHAUST FAN,SHUTTER TYPE white colour, 9" OR 10" star rated as per BEE complete with its all accessories (Make Havells/bajaj/usha/V-guard)	0	Each		
2	Miscellaneous Items				
3	CABLE SUPPLY				
	Supplying the following PVC insulated and PVC sheathed/XLPE power cable of 1.1 KV grade as per CPWD standards as required. (Make:Havells/ Glostar/Nicco/Finolex/Polycab)				
	2 X 4 sq. mm + 1 X 4 sq. mm earth wire (3 Nos. of 4 Sq.mm wire)	0	Metre		
Total Amt in Rs.					
GST @ 18%					
Grand Total in Rs.					

3) Primary Health Centre, Nanakpur - Panchkula District

PHC Nanakpur (Panchkula) – Civil works									
S.No	Description of work	Nos	L in M	B in M	D in M	Qty	Unit	Unit Rate in Rs.	Total Rate in Rs.
EARTH WORK									
3	Surface dressing of the ground including removing vegetation and in equalities not exceeding 15 cm deep and disposal of rubbish, lead up to 50 m and lift up to 1.5 m.								
	For Passage Area	1.000	12.000	5.000	1.000	60.000	M.SQ		
	For Nearby Waiting Area Side	1.000	12.000	3.000	1.000	36.000	M.SQ		
	TOTAL					96.000	M.SQ		
	Say					96.000	M.SQ		
4	Clearing jungle including uprooting of rank vegetation, grass, brush wood, trees and saplings of girth up to 30 cm measured at a height of 1 m above ground level and removal of rubbish up to a distance of 50 m outside the periphery of the area cleared.								
	For Passage Area	1.000	12.000	5.000	1.000	60.000	M.SQ		
	For Nearby Waiting Area Side	1.000	12.000	3.000	1.000	36.000	M.SQ		
	TOTAL					96.000	M.SQ		
	Say					96.000	M.SQ		
FLOORING									
10	Providing and laying vitrified floor tiles in different sizes (thickness to be specified by the manufacturer) with water absorption less than 0.08% and conforming to IS: 15622, of approved make, in all colours and shades, laid on 20mm thick cement mortar 1:4 (1 cement : 4 coarse sand), jointing with grey cement slurry @ 3.3kg/sqm including grouting the joints with white cement and matching pigments etc., complete. Size of Tile 600x600 mm								
	Floor Tile	0.000	9.560	32.600	1.000	0.000	M.SQ		
	Dismanling Quantity	LS				10.000	M.SQ		
	Passage Floor	0.000	14.000	2.800	1.000	0.000	M.SQ		
	TOTAL					10.000	M.SQ		
	Say					10.000	M.SQ		

PHC Nanakpur (Panchkula) – Civil works

S.No	Description of work	Nos	L in M	B in M	D in M	Qty	Unit	Unit Rate in Rs.	Total Rate in Rs.
11	Providing and fixing 1st quality ceramic glazed floor tiles conforming to IS : 15622 (thickness to be specified by the manufacturer) of approved make in all colours, shades except burgundy, bottle green, black of any size as approved by Engineer-in-Charge in skirting, risers of steps and dados over 12 mm thick bed of cement Mortar 1:3 (1 cement: 3 coarse sand) and jointing with grey cement slurry @ 3.3kg per sqm including pointing in white cement mixed with pigment of matching shade complete.								
	Toilet	0.000	1.600	2.100	1.000	0.000	M.SQ		
	TOTAL					0.000	M.SQ		
	Say					0.000	M.SQ		
12	Providing and laying machine cut, mirror polished Marble stone flooring, in required design (Simple geometrical, abstract etc.) and in patterns in combination with Italian marble stones of different colours, shades and finished surface texture etc., in linear portions of the building, all complete as per the architectural drawings, with 18 mm thick stone slab laid over 20 mm (average) thick base of cement mortar 1:4 (1 cement : 4 coarse sand) laid and jointed with white cement slurry @ 4.4 kg/sqm including pointing with white cement slurry admixed with pigment to match the marble shade including rubbing, curing and polishing etc. all complete as specified and as directed by the Engineer-in-Charge. 18 mm thick Italian Marble stone slab, Perlato, Rosso verona, Fire Red or Dark Emperadore etc.								
	For Platform in Labour Room	0.000	3.600	0.600	1.000	0.000	M.SQ		
	TOTAL					0.000	M.SQ		
	Say					0.000	M.SQ		
PLASTERING									

PHC Nanakpur (Panchkula) – Civil works

S.No	Description of work	Nos	L in M	B in M	D in M	Qty	Unit	Unit Rate in Rs.	Total Rate in Rs.
26	15 mm cement plaster on rough side of single or half brick wall finished with a floating coat of neat cement of mix : 1:3 (1 cement: 3 fine sand)								
	For OT Room Scrub Wall	2.000	2.600	1.100	1.000	5.720	M.SQ		
	TOTAL					5.720	M.SQ		
	SAY					6.000	M.SQ		
PAINTING									
27	Distemping with 1st quality acrylic washable distemper (ready made) of approved manufacturer and of required shade and colour complete. as per manufacturer's specification. One or more coats on old work								
	Existing Wall All around	4.000	30.000	2.100	1.000	252.000	M.SQ		
	Existing Wall All around	34.000	5.300	2.100	1.000	378.420	M.SQ		
	Existing Wall All around	1.000	92.000	5.300	1.000	487.600	M.SQ		
	Existing Wall All around	16.000	5.300	2.100	1.000	178.080	M.SQ		
	TOTAL					1296.100	M.SQ		
	Say					1297.000	M.SQ		
28	Painting wood work with Deluxe Multi Surface Paint of required shade. Two or more coat applied @ 0.90 ltr/10 sqm over an under coat of primer applied @0.75 ltr/10 sqm of approved brand and manufacture								
	Wooden Door	4.000	4.000	2.100	1.000	33.600	M.SQ		
	TOTAL					33.600	M.SQ		
	Say					34.000	M.SQ		
29	Painting Steel work with Deluxe Multi Surface Paint to give an even shade. Two or more coat applied @ 0.90 ltr/ 10 sqm over an under coat of primer applied @ 0.80 ltr/ 10 sqm of approved brand and manufacture								
	Steel Windows	1.000	4.000	6.000	1.000	24.000	M.SQ		
	Truss Work Painting	1.000	1.500	1.500	1.000	2.250	M.SQ		
	TOTAL					26.250	M.SQ		
	Say					27.000	M.SQ		

PHC Nanakpur (Panchkula) – Civil works

S.No	Description of work	Nos	L in M	B in M	D in M	Qty	Unit	Unit Rate in Rs.	Total Rate in Rs.
30	Providing and applying plaster of paris putty of 2 mm thickness over plastered surface to prepare the surface even and smooth complete.								
	Interior Qunatity	1.000	12.000	1.000	1.000	12.000	M.SQ		
	TOTAL					12.000	M.SQ		
	Say					12.000	M.SQ		
31	Removing white or colour wash by scrapping and sand papering and preparing the surface smooth including necessary repairs to scratches etc. complete								
	Existing Interior Quantity	1.000	1297.000	1.000	1.000	1297.000	M.SQ		
	Existing Exterior Quantity	1.000	1276.000	1.000	1.000	1276.000	M.SQ		
	TOTAL					2573.000	M.SQ		
	Say					3150.000	M.SQ		
32	Finishing walls with Acrylic Smooth exterior paint of required shade: Old work (Two or more coat applied @ 1.67 ltr/ 10 sqm) on existing cement paint surface								
	Existing Wall All around	4.000	31.770	5.000	1.000	635.400	M.SQ		
	Existing Wall All around	0.000	6.000	5.000	1.000	0.000	M.SQ		
	Existing Wall All around	4.000	17.300	5.000	1.000	346.000	M.SQ		
	Existing Wall All around	2.000	7.400	5.000	1.000	74.000	M.SQ		
	Existing Wall All around	2.000	6.000	5.000	1.000	60.000	M.SQ		
	Existing Wall All around	2.000	16.000	5.000	1.000	160.000	M.SQ		
	TOTAL					1275.400	M.SQ		
	Say					1276.000	M.SQ		
DISMANTLING									
33	Dismantling plastered brickwalls in cement mortar including cleaning, stacking the useful materials as directed by engineer-in-charge and dumping the dismantled debris as indicated at site, levelling, consolidating, all complete as directed and disposing the debris away from site all complete as directed.								
	In Existing Wall	12.000	0.300	0.300	1.000	1.080	M.CUBE		
	TOTAL					1.080	M.CUBE		
	Say					2.000	M.CUBE		

PHC Nanakpur (Panchkula) – Civil works

S.No	Description of work	Nos	L in M	B in M	D in M	Qty	Unit	Unit Rate in Rs.	Total Rate in Rs.
41	Providing and fixing gun metal gate valve with C.I. wheel of approved quality -25MM	1.000	1.000	1.000	1.000	1.000	EACH		
42	Providing and fixing C.P. brass angle valve for basin mixer and geyserpoints of approved quality conforming to IS:8931 a) 15 mm nominal bore: 15 mm nominal bore.Make:Hindware,Cera,Jaquar etc..	0.000	1.000	1.000	1.000	0.000	EACH		
43	Providing and fixing PTMT Bottle Trap for Wash basin and sink.Bottle trap 38mm single piece moulded with height of 270mm, effective length of tail pipe 260mm from the centre of the waste coupling 77mm breadth with 25mm minimum water seal, weighing not less than 263gms.	0.000	1.000	1.000	1.000	0.000	EACH		
44	Providing and fixing trap of self cleansing design with screwed down orhinged grating with or without vent arm complete, including cost of cuttingand making good the walls and floors :100 mm inlet and 100 mm outlet	1.000	1.000	1.000	1.000	1.000	EACH		
45	Constructing brick masonry manhole in cement mortar 1:4 (1 cement : 4 coarse sand) with R.C.C. top slab with 1:2:4 mix (1 cement : 2 coarse sand : 4 graded stone aggregate 20 mm nominal size), foundation concrete 1:4:8 mix (1 cement : 4 coarse sand : 8 graded stone aggregate 40 mm nominal size), inside plastering 12 mm thick with cement mortar 1:3 (1 cement : 3 coarse sand) finished with floating coat of neat cement and making channels in cement concrete 1:2:4 (1 cement : 2 coarse sand : 4 graded stone aggregate 20 mm nominal size) finished with a floating coat of neat cement complete as per standard design : With common burnt clay F.P.S designation 7.5	QRO	1.000	1.000	1.000	0.000	EACH		

PHC Nanakpur (Panchkula) – Civil works

S.No	Description of work	Nos	L in M	B in M	D in M	Qty	Unit	Unit Rate in Rs.	Total Rate in Rs.
46	Providing and fixing square – mouth PVC. Gully trap grade “A” complete with CI grating brick masonry chamber with water tight tight CI cover with frame of 300 x 300mm size (inside) the weight of cover to be not less than 4.50 kg and frame to be not less than 2.70 kg as per standard design	2.000	1.000	1.000	1.000	2.000	EACH		
47	Providing and fixing white vitreous china pedestal type water closet(European type W.C. pan) with seat and lid, 10 litre low level white P.V.C.flushing cistern, including flush pipe, with manually controlled device(handle lever), conforming to IS : 7231, with all fittings and fixturescomplete, including cutting and making good the walls and floors wherever required :W.C. pan with ISI marked white solid plastic seat and lid	2.000	1.000	1.000	1.000	2.000	EACH		
48	Providing and fixing wash basin with C.I. brackets, 15 mm C.P. brasspillar taps, 32 mm C.P. brass waste of standard pattern, including paintingof fittings and brackets, cutting and making good the walls whereverrequire:White Vitreous China Wash basin size 630x450 mm with apair of 15 mm C.P. brass pillar taps	1.000	1.000	1.000	1.000	1.000	EACH		
49	Providing and fixing Chlorinated Polyvinyl Chloride (CPVC) pipes, having thermal stability for hot & cold water supply including all CPVC plain & brass threaded fittings i/c fixing the pipe with clamps at 1.00 m spacing. This includes jointing of pipes & fittings with one step CPVC solvent cement and the cost of cutting chases and making good the same including testing of joints complete as per direction of Engineer in Charge.Concealed work including cutting chases and making good the walls etc	10.000	1.000	1.000	1.000	10.000	RM		

PHC Nanakpur (Panchkula) – Civil works

S.No	Description of work	Nos	L in M	B in M	D in M	Qty	Unit	Unit Rate in Rs.	Total Rate in Rs.
50	32 mm nominal outer dia Pipes	10.000	1.000	1.000	1.000	10.000	RM		
51	50 mm nominal outer dia Pipes	6.000	1.000	1.000	1.000	6.000	RM		
52	Providing and fixing Stainless Steel A ISI 304 (18/8) kitchen sink as per IS: 13983 with C.I. brackets and stainless steel plug 40 mm, including painting of fittings and brackets, cutting and making good the walls wherever required ::(Lowest retail price of sink not less than Rs. 3150)								
53	Kitchen sink without drain board, Size -610x510 mm bowl depth 200 mm	0.000	1.000	1.000	1.000	0.000	EACH		
54	Providing and fixing PVC Waste pipe for sink or wash basin including PVC waste fittings complete.::Semi rigid pipe 32mm dia	4.000	1.000	1.000	1.000	4.000	EACH		
55	Providing and fixing CP Waste coupling for wash basin and sink of approved quality, colour and make. Waste coupling 31mm of 79mm length and 62mm breadth, weighing not less than 45 gms. Make:Hindware,Jaquar etc.,	4.000	1.000	1.000	1.000	4.000	EACH		
56	Extra for providing opening of required size & shape for wash basin/ kitchen sink in kitchen platform, vanity counter and similar location in marble/ Granite/stone work, including necessary holes for pillar taps etc. including moulding, rubbing and polishing of cut edges etc. complete.	0.000	1.000	1.000	1.000	0.000	EACH		
57	Providing and fixing 600x450 mm beveled edge mirror of superior glass (of approved quality) complete with 6 mm thick hard board ground fixed to wooden cleats with C.P. brass screws and washers complete.	1.000	1.000	1.000	1.000	1.000	EACH		

PHC Nanakpur (Panchkula) – Electrical works

SL No.	Description of work	Qty	Unit	Unit Rate in Rs.	Total Rate in Rs.
1	Point wiring in PVC conduit with modular type switch.				
	Wiring for light point/ fan point/ exhaust fan point/ call bell point with 1.5 sq.mm FRLS PVC insulated copper conductor single core cable in surface / recessed medium class PVC conduit, with modular switch, modular plate, suitable GI box and earthing the point with 1.5 sq.mm FRLS PVC insulated copper conductor single core cable etc. as required. switch, modular plate, suitable GI box and earthing the point with 1.5 sq.mm FRLS PVC insulated copper conductor single core cable etc. as required.				
	Group C	3	Point		
2	Wiring through PVC conduit				
	Wiring for circuit/submain wiring along with earth wire with the following sizes of FR PVC insulated copper conductor, single core cable in surface/recessed medium class PVC conduit as required.(Make:Havells/Finolex/V-guard/Polycab)				
a	2X1.5 sq.mm + 1X1.5 sq.mm earth wire	20	Metre		
b	2X2.5 sq.mm + 1 X2.5 sq mm earth wire	0	Metre		
c	2X4 sq.mm + 1X4 sq.mm earth wire	0	Metre		
3	Telephone wiring in existing conduit:				
	Supplying and drawing following pair 0.5 sq mm FR PVC insulated annealed copper conductor, unarmored telephone cable in the existing surface/ recessed steel/ PVC conduit as required.				
a	2 Pair	0	Metre		
4	A/C point				
	S/F 20A SPN MCB industrial socket outlet: Supplying and fixing 20 amps, 240 volts, SPN industrial type, socket outlet, with 2 pole and earth, metal enclosed plug top alongwith 20 amps "C" curve, SP, MCB, in sheet steel enclosure, on surface or in recess, with chained metal cover for the socket out let and complete with connections, testing and commissioning etc. as required.(Make: Legrand/Havells/HPL)	0	Point		
5	Modular type blanking plate:				
	Supplying and fixing modular blanking plate on the existing modular plate & switch box excluding modular plate as required.(Make: Legrand/Havells/HPL)	0	Each		
6	Modular boxes, bases & cover plate:				
	Supplying and fixing following size/modules, GI box along with modular base & cover plate for modular switches in recess etc as required.(Make: Legrand/Havells/HPL)				
a	2 module	0	Each		
b	3 module	0	Each		
c	4 module	0	Each		
d	6 module	0	Each		

PHC Nanakpur (Panchkula) – Electrical works

SL No.	Description of work	Qty	Unit	Unit Rate in Rs.	Total Rate in Rs.
e	8 module	0	Each		
f	12 module	0	Each		
7	Modular type switch/socket:				
	Supplying and fixing following modular switch/socket on the existing modular plate & switch box including connections but excluding modular plate etc as required. (Make: Legrand/Havells/HPL)				
a	5/6 Amps switch	0	Each		
b	3 pin 5/6 Amp socket outlet	0	Each		
c	15/16 Amps switch	0	Each		
d	6pin 15/16 Amps (universal) socket outlet	0	Each		
e	Telephone socket outlet	0	Each		
8	S/F PVC conduit:				
	Supplying and fixing of following sizes of medium class PVC conduit/Casing Cap along with accessories in surface/recess including cutting the wall and making good the same in case of recessed conduit as required.(ISI Make)				
a	20 mm	200	Metre		
b	25 mm	0	Metre		
	Installation Testing & Commissioning				
9	ITC Fluorescent fitting directly on surface: Installation, testing and commissioning of pre-wired, fluorescent fitting / compact fluorescent fitting/LED of all types, complete with all accessories and tube etc. directly on ceiling/ wall, including connection with 1.5 sq. mm FR PVC insulated, copper conductor, single core cable and earthing etc. as required.	6	Each		
10	ITC Ceiling fan/Wall fan: Installation, testing and commissioning of ceiling fan, including wiring the down rods of standard length (upto 30 cm) with 1.5 sq. mm FR PVC insulated, copper conductor, single core cable etc. as required.		Each		
11	Supplying and fixing two module stepped type electronic fan regulator on the existing modular plate switch box including connections but excluding modular plate etc. as required.	0	Each		
12	LAYING OF CABLES				
	CABLE LAYING				
	Wiring for circuit/ submain wiring alongwith earth wire with the following sizes of FRLS PVC insulated copper conductor, single core cable in surface/ recessed medium class PVC conduit as required.				
a	FROM Mains TO DB				
	2 X 4 sq. mm + 1 X 4 sq. mm earth wire	0	Metre		
13	END TERMINATION				

PHC Nanakpur (Panchkula) – Electrical works

SL No.	Description of work	Qty	Unit	Unit Rate in Rs.	Total Rate in Rs.
	Supply and making end termination with brass compression gland, earth clip and aluminium lugs for following size of PVC insulated and PVC sheathed/XLPE aluminium conductor cable fo 1.1KV grade as required.				
	2 X 4 sq. mm + 1 X 4 sq. mm earth wire	0	Each		
15	S/F of SPN MCB PDB				
	Supplying and fixing following way, single pole and neutral, sheet steel, MCB distribution board, 240 V, on surface/ recess, complete with tinned copper bus bar, neutral bus bar, earth bar, din bar, interconnections, powder painted including earthing etc. as required. (But without MCB/RCCB/Isolator)				
a	6 way Double door, horizontal type	0	Each		
b	16 way Double door ,horizontal type	0	Each		
C	12 way Double door ,horizontal type	0	Each		
16	S/F OF SP MCB				
	Supplying and fixing 5 A to 32 A rating, 240/415 V, 10 kA, “C” curve, miniature circuit breaker suitable for inductive load of following poles in the existing MCB DB complete with connections, testing and commissioning etc. as required.				
	6/32 A SP MCB	0	Each		
17	S/F DP ISOLATOR				
	Supplying and fixing following rating, double pole, (single phase and neutral), 240 volts, ISOLATOR having a sensitivity current upto 100 to 300 milliamperes in the existing MCB DB complete with connections, testing and commissioning etc, as required.(Make: Legrand/Havells/HPL)				
	40 A	0	Each		
18	S/F DP RCCB				
	Supplying and fixing following rating, double pole, (single phase and neutral), 240 V, residual current circuit breaker (RCCB), having a sensitivity current 30 mA in the existing MCB DB complete with connections, testing and commissioning etc. as required.				
	25 A	0	Each		
NDSR ITEMS					
1.1	Supply of 15W LED tube fitting sleek with decorative end cap, powder coated CRCA steel channel complete with all electrical accessories like electronic ballast, lamp holder, 28W LED lamp etc complete as required. (Philips / Wipro /HAVELLS)	3	Each		

PHC Nanakpur (Panchkula) – Electrical works

SL No.	Description of work	Qty	Unit	Unit Rate in Rs.	Total Rate in Rs.
1.2	Supply and installation of 18 W CFL with its all accessories.[ISI MAKE]	3	Each		
1.3	Supply and installation of wall fan, white colour, 5 star rated as per BEE complete with blades, casing , wall mounting accessories etc(Make Havells/bajaj/usha/V-guard/crompton)	0	Each		
1.4	Supply and installation EXHAUST FAN,SHUTTER TYPE white colour, 9" OR 10" star rated as per BEE complete with its all accessories(Make Havells/bajaj/usha/V-guard)	0	Each		
2	Miscellaneous Items				
3	CABLE SUPPLY				
	Supplying the following PVC insulated and PVC sheathed/XLPE power cable of 1.1 KV grade as per CPWD standards as required. (Make:Havells/ Glostar/Nicco/Finolex/Polycab)				
	2 X 4 sq. mm + 1 X 4 sq. mm earth wire (3 Nos. of 4 Sq.mm wire)	0	Metre		
	Total Amt in Rs.				
	GST @ 18%				
	Grand Total in Rs.				

PHC Pinjore (Panchkula) – Civil works

S.No	Description of work	Nos	L in M	B in M	D in M	Qty	Unit	Unit Rate in Rs.	Total Rate in Rs.
	includes providing PU sealent in both inside and outside								
	OP Partition								
	Single Groove 63.5*38.1*1.85	2.000	3.600	1.000	1.092	7.862	KG		
	Single Groove 63.5*38.1*1.85	1.000	3.600	1.000	1.092	3.931	KG		
	Single Groove 63.5*38.1*1.85	1.000	3.200	1.000	1.092	3.494	KG		
	Double Groove 63.5*38.1*1.95	3.000	3.600	1.000	1.095	11.826	KG		
	Double Groove 63.5*38.1*1.95	3.000	3.600	1.000	1.095	11.826	KG		
	Glazing Clip 0.7	4.000	3.200	1.000	0.096	1.229	KG		
	Glazing Clip 0.7	16.000	3.600	1.000	0.096	5.530	KG		
	TOTAL					45.698	KG		
	Say					46.000	KG		
17	S/F 100mm brass lock for aluminium door including necessary cutting and making good etc. complete	1.000	1.000	1.000	1.000	1.000	EACH		
18	Providing and fixing aluminium tower bolts (100*10mm) ISI marked anodised (anodic coating not less than grade AC 10 as per IS : 1868) transparent or dyed to required colour or shade with necessary screws etc. complete :	2.000	1.000	1.000	1.000	2.000	EACH		
19	Providing and fixing glazing in aluminum door, window, ventilator shutters and partitions etc. with EPDM rubber / neoprene gasket etc. complete as per the architectural drawings and the directions of Engineer-in- Charge. (Cost of aluminum snap beading shall be paid in basic item): With float glass panes of 5.5 mm thickness.								
	For Partition	1.000	3.600	1.490	1.000	5.364	M.SQ		
	For Passage Partition	1.000	1.200	0.890	1.000	1.068	M.SQ		
	TOTAL					6.432	M.SQ		
	Say					7.000	M.SQ		
20	Providing and fixing aluminum tubular handle bar 32 mm outer dia, 3.0 mm thick & 2100 mm long with SS screws etc. complete as per direction of Engineerin-Charge. Anodized (AC 15) aluminum tubular handle bar	2.000	1.000	1.000	1.000	2.000	EACH		

PHC Pinjore (Panchkula) – Civil works

S.No	Description of work	Nos	L in M	B in M	D in M	Qty	Unit	Unit Rate in Rs.	Total Rate in Rs.
21	Providing and fixing aluminium hanging floor door stopper ISI marked anodised (anodic coating not less than grade AC 10 as per IS : 1868) transparent or dyed to required colour and shade with necessary screws etc. complete. With twin rubber stopper	1.000	1.000	1.000	1.000	1.000	EACH		
22	Providing and fixing double action hydraulic floor spring of approved brand and manufacture IS : 6315 marked, for doors including cost of cutting floors as required, embedding in floors and cover plates with brass pivot and single piece M.S. sheet outer box with slide plate etc. complete as per the direction of Engineer-in-charge. With Brass cover Plate	1.000	1.000	1.000	1.000	1.000	EACH		
23	Providing and fixing 12 mm thick pre laminated particle board flat pressed three layer or graded wood particle board conforming to IS: 12823 Grade I Type II, in paneling fixed in aluminum doors, windows shutters and partition frames with C.P. brass / stainless steel screws etc. complete as per architectural drawings and directions of Engineer-inCharge. Pre-laminated particle board with decorative lamination on both sides								
	For Partition	1.000	3.600	1.800	1.000	6.480	M.SQ		
	For Cellar Floor Partition	3.000	1.200	0.890	1.000	3.204	M.SQ		
	TOTAL					9.684	M.SQ		
	Say					10.000	M.SQ		

PHC Pinjore (Panchkula) – Civil works

S.No	Description of work	Nos	L in M	B in M	D in M	Qty	Unit	Unit Rate in Rs.	Total Rate in Rs.
24	24 mm thick factory made PVC door shutters made of styles and rails of a uPVC hollow section of size 59x24 mm and wall thickness 2 mm (± 0.2 mm) with inbuilt edging on both sides. The styles and rails mitred and joint at the corners by means of M.S. galvanised/ plastic brackets of size 75x220 mm having wall thickness 1.0 mm and stainless steel screws. The styles of the shutter reinforced by inserting galvanised M.S. tube of size 20x20 mm and 1 mm (± 0.1 mm) wall thickness. The lock rail made up of 'H' section, a uPVC hollow section of size 100x24 mm and 2 mm (± 0.2 mm) wall thickness, fixed to the shutter styles by means of plastic/galvanised M.S. 'U' cleats. The shutter frame filled with a uPVC multi-chambered single panel of size not less than 620 mm, having over all thickness of 20 mm and 1 mm (± 0.1 mm) wall thickness. The panels filled vertically and tie bar at two places by inserting horizontally 6 mm galvanised M.S. rod and fastened with nuts and washers, complete as per manufacturer's specification and direction of Engineer-in-charge. (For W.C. and bathroom door shutter).								
	For Toilet Door	1.000	0.900	2.100	1.000	1.890	M.SQ		
	TOTAL					1.890	M.SQ		
	Say					2.000	M.SQ		
PLASTERING									
26	15 mm cement plaster on rough side of single or half brick wall finished with a floating coat of neat cement of mix : 1:3 (1 cement: 3 fine sand)								
	For OT Room Scrub Wall	1.000	13.000	1.100	2.000	28.600	M.SQ		
	TOTAL					28.600	M.SQ		
	SAY					29.000	M.SQ		
PAINTING									
27	Finishing with Deluxe Multi surface paint system for interiors and exteriors using Primer as per manufacturers specifications : Two or more coats applied on walls @ 1.25 ltr/10 sqm								
	Existing Wall All around	4.000	16.000	2.100	1.000	134.400	M.SQ		
	Existing Wall All around	6.000	7.400	2.100	1.000	93.240	M.SQ		

PHC Pinjore (Panchkula) – Civil works

S.No	Description of work	Nos	L in M	B in M	D in M	Qty	Unit	Unit Rate in Rs.	Total Rate in Rs.
	Existing Wall All around	4.000	26.000	2.100	2.000	436.800	M.SQ		
	Existing Wall All around	14.000	7.400	2.100	1.000	217.560	M.SQ		
	Existing Wall All around	14.000	18.000	2.100	2.000	1058.400	M.SQ		
	Existing Wall All around	6.000	21.000	2.100	1.000	264.600	M.SQ		
	TOTAL					2205.000	M.SQ		
	Say					2205.000	M.SQ		
28	Painting wood work with Deluxe Multi Surface Paint of required shade. Two or more coat applied @ 0.90 ltr/10 sqm over an under coat of primer applied @0.75 ltr/10 sqm of approved brand and manufacture								
	Wooden Door	1.000	12.000	2.100	1.000	25.200	M.SQ		
	TOTAL					25.200	M.SQ		
	Say					26.000	M.SQ		
29	Painting Steel work with Deluxe Multi Surface Paint to give an even shade. Two or more coat applied @ 0.90 ltr/ 10 sqm over an under coat of primer applied @ 0.80 ltr/ 10 sqm of approved brand and manufacture								
	Steel Windows	1.000	7.000	6.000	1.000	42.000	M.SQ		
	Truss Work Painting	12.000	1.500	1.500	1.000	27.000	M.SQ		
	TOTAL					69.000	M.SQ		
	Say					69.000	M.SQ		
30	Providing and applying plaster of paris putty of 2 mm thickness over plastered surface to prepare the surface even and smooth complete.								
	Interior Quantity	1.000	2205.000	1.000	1.000	2205.000	M.SQ		
	TOTAL					2205.000	M.SQ		
	Say					2205.000	M.SQ		
31	Removing white or colour wash by scrapping and sand papering and preparing the surface smooth including necessary repairs to scratches etc. complete								
	Existing Interior Quantity	1.000	2205.000	1.000	1.000	2205.000	M.SQ		
	Existing Exterior Quantity	1.000	1046.000	1.000	2.000	1046.000	M.SQ		
	TOTAL					3251.000	M.SQ		
	Say					3251.000	M.SQ		
32	Finishing walls with Acrylic Smooth exterior paint of required shade : New work (Two or more coat applied @ 1.67 ltr/10 sqm over and including priming coat of exterior primer applied @ 2.20 kg/10 sqm)								
	Existing Wall All around	2.000	16.000	6.000	1.000	192.000	M.SQ		

PHC Pinjore (Panchkula) – Civil works

S.No	Description of work	Nos	L in M	B in M	D in M	Qty	Unit	Unit Rate in Rs.	Total Rate in Rs.
	Existing Wall All around	2.000	7.400	6.000	1.000	88.800	M.SQ		
	Existing Wall All around	2.000	26.000	5.000	1.000	260.000	M.SQ		
	Existing Wall All around	2.000	7.400	5.000	1.000	74.000	M.SQ		
	Existing Wall All around	2.000	18.000	6.000	1.000	216.000	M.SQ		
	Existing Wall All around	2.000	5.000	21.500	1.000	215.000	M.SQ		
	TOTAL					1045.800	M.SQ		
	Say					1046.000	M.SQ		
DISMANTLING									
33	Dismantling plastered brickwalls in cement mortar including cleaning, stacking the useful materials as directed by engineer-in-charge and dumping the dismantled debris as indicated at site, levelling, consolidating, all complete as directed and disposing the debris away from site all complete as directed.								
	In Existing Wall	12.000	0.300	0.300	1.000	1.080	M.CUBE		
	TOTAL					1.080	M.CUBE		
	Say					2.000	M.CUBE		
34	Dismantling the existing RCC concrete including cutting the reinforcement, stacking the useful materials as directed by engineer-in-charge, dumping the dismantled debris as indicated at site, leveling, consolidating, all complete as directed and disposal of debris away from site all complete.								
	In Existing Wall	8.000	0.300	0.300	1.000	0.720	M.CUBE		
	TOTAL					0.720	M.CUBE		
	Say					1.000	M.CUBE		
35	Dismantling Aluminium partition including disposing the debris away from site as directed by engineer in charge all complete.								
	In Existing Building	1.000	2.000	1.800	1.000	3.600	SQM		
	TOTAL					3.600	SQM		
	Say					4.000	SQM		
36	Dismantling of flushing cistern of all types (C.I./PVC/Vitrious China) including stacking of useful materials near the site and disposal of unserviceable materials within 50 metres lead.	2.000	1.000	1.000	1.000	2.000	EACH		

PHC Pinjore (Panchkula) – Civil works

S.No	Description of work	Nos	L in M	B in M	D in M	Qty	Unit	Unit Rate in Rs.	Total Rate in Rs.
	<p>Providing and laying 900MM*900MM or required size DESIGN PRINTED for display of Logo glazed tiles of printed series(Satin finish) in dado set in CM 1:3 with joints so as to form a true & even surface and joints finished neatly with white cement mixed with matching pigments all complete as directed. (Rate should include base plastering with CM 1:5 of required thickness.)</p> <p>The rate shall include cost of customized printing at top of the tile all complete as the details given by National Health Mission Haryana / HLL directed. (Kindly refer tender documents for Design details)</p>								
	NHM Writeup & Logo	1.000	4.000	0.750	1.000	3.000	SQM		
	Logo	6.000	0.900	0.900	1.000	4.860	SQM		
	TOTAL					7.860	SQM		
	Say					8.000	SQM		
	<p>Providing and laying 300MM*900MM or required size DESIGN PRINTED for Windows & Door Borders glazed tiles of printed series(Satin finish) in dado set in CM 1:3 with joints so as to form a true & even surface and joints finished neatly with white cement mixed with matching pigments all complete as directed. (Rate should include base plastering with CM 1:5 of required thickness.)</p> <p>The rate shall include cost of customized printing at top of the tile all complete as the details given by National Health Mission Haryana / HLL directed. (Kindly refer tender documents for Design details)</p>								
	Window & Door Borders	4.000	2.400	0.230	4.000	8.832	SQM		
	Window & Door Borders	1.000	10.200	0.230	1.000	2.346	SQM		
	TOTAL					11.178	SQM		
	Say					12.000	SQM		
PLUMBING									
41	Providing and fixing gun metal gate valve with C.I. wheel of approved quality -25MM	1.000	1.000	1.000	1.000	1.000	EACH		

PHC Pinjore (Panchkula) – Civil works

S.No	Description of work	Nos	L in M	B in M	D in M	Qty	Unit	Unit Rate in Rs.	Total Rate in Rs.
42	Providing and fixing C.P. brass angle valve for basin mixer and geyserpoints of approved quality conforming to IS:8931 a) 15 mm nominal bore: 15 mm nominal bore.Make:Hindware,Cera,Jaquar etc..	0.000	1.000	1.000	1.000	0.000	EACH		
43	Providing and fixing PTMT Bottle Trap for Wash basin and sink.Bottle trap 38mm single piece moulded with height of 270mm, effective length of tail pipe 260mm from the centre of the waste coupling 77mm breadth with 25mm minimum water seal, weighing not less than 263gms.	0.000	1.000	1.000	1.000	0.000	EACH		
44	Providing and fixing trap of self cleansing design with screwed down orhinged grating with or without vent arm complete, including cost of cuttingand making good the walls and floors :100 mm inlet and 100 mm outlet	1.000	1.000	1.000	1.000	1.000	EACH		
45	Constructing brick masonry manhole in cement mortar 1:4 (1 cement : 4 coarse sand) with R.C.C. top slab with 1:2:4 mix (1 cement : 2 coarse sand : 4 graded stone aggregate 20 mm nominal size), foundation concrete 1:4:8 mix (1 cement : 4 coarse sand : 8 graded stone aggregate 40 mm nominal size), inside plastering 12 mm thick with cement mortar 1:3 (1 cement : 3 coarse sand) finished with floating coat of neat cement and making channels in cement concrete 1:2:4 (1 cement : 2 coarse sand : 4 graded stone aggregate 20 mm nominal size) finished with a floating coat of neat cement complete as per standard design : With common burnt clay F.P.S designation 7.5	QRO	1.000	1.000	1.000	0.000	EACH		
46	Providing and fixing square – mouth PVC. Gully trap grade “A” complete with CI grating brick masonry chamber with water tight tight CI cover with frame of 300 x 300mm size (inside) the weight of cover to be not less than 4.50 kg and frame to be not less than 2.70 kg as per standard design	1.000	1.000	1.000	1.000	1.000	EACH		

PHC Pinjore (Panchkula) – Civil works

S.No	Description of work	Nos	L in M	B in M	D in M	Qty	Unit	Unit Rate in Rs.	Total Rate in Rs.
47	Providing and fixing white vitreous china pedestal type water closet(European type W.C. pan) with seat and lid, 10 litre low level white P.V.C.flushing cistern, including flush pipe, with manually controlled device(handle lever), conforming to IS : 7231, with all fittings and fixturescomplete, including cutting and making good the walls and floors wherever required :W.C. pan with ISI marked white solid plastic seat and lid	1.000	1.000	1.000	1.000	1.000	EACH		
48	Providing and fixing wash basin with C.I. brackets, 15 mm C.P. brass pillar taps, 32 mm C.P. brass waste of standard pattern, including paintingof fittings and brackets, cutting and making good the walls whereverrequire:White Vitreous China Wash basin size 630x450 mm with a pair of 15 mm C.P. brass pillar taps	1.000	1.000	1.000	1.000	1.000	EACH		
	Providing and fixing Chlorinated Polyvinyl Chloride (CPVC) pipes, having thermal stability for hot & cold water supply including all CPVC plain & brass threaded fittings i/c fixing the pipe with clamps at 1.00 m spacing. This includes jointing of pipes & fittings with one step CPVC solvent cement and the cost of cutting chases and making good the same including testing of joints complete as per direction of Engineer in Charge.Concealed work including cutting chases and making good the walls etc								
49	20 mm nominal outer dia .Pipes	20.000	1.000	1.000	1.000	20.000	RM		
50	32 mm nominal outer dia Pipes	10.000	1.000	1.000	1.000	10.000	RM		
51	50 mm nominal outer dia Pipes	6.000	1.000	1.000	1.000	6.000	RM		
52	Providing and fixing Stainless Steel AISI 304 (18/8) kitchen sink as perIS: 13983 with C.I. brackets and stainless steel plug 40 mm, includingpainting of fittings and brackets, cutting and making good the wallswherever required ::(Lowest retail price of sink not less than Rs. 3150)								
53	Kitchen sink without drain board,Size -610x510 mm bowl depth 200 mm	0.000	1.000	1.000	1.000	0.000	EACH		

PHC Pinjore (Panchkula) – Civil works

S.No	Description of work	Nos	L in M	B in M	D in M	Qty	Unit	Unit Rate in Rs.	Total Rate in Rs.
54	Providing and fixing PVC Waste pipe for sink or wash basin including PVC waste fittings complete.:Semi rigid pipe 32mm dia	1.000	1.000	1.000	1.000	1.000	EACH		
55	Providing and fixing CP Waste coupling for wash basin and sink of approved quality, colour and make. Waste coupling 31mm of 79mm length and 62mm breadth, weighing not less than 45 gms. Make:Hindware,Jaquar etc.,	0.000	1.000	1.000	1.000	0.000	EACH		
56	Extra for providing opening of required size & shape for wash basin/ kitchen sink in kitchen platform, vanity counter and similar location in marble/ Granite/stone work, including necessary holes for pillar taps etc. including moulding, rubbing and polishing of cut edges etc. complete.	0.000	1.000	1.000	1.000	0.000	EACH		
57	Providing and fixing 600x450 mm beveled edge mirror of superior glass (of approved quality) complete with 6 mm thick hard board ground fixed to wooden cleats with C.P. brass screws and washers complete.	0.000	1.000	1.000	1.000	0.000	EACH		
58	Providing and fixing PTMT towel rail complete with brackets fixed to wooden cleats with CP brass screws with concealed fitting arrangement of approved quality and colour. 600mm long towel rail with total length of 645mm, width 78mm and effective height of 88mm, weighing not less than 190gms.	0.000	1.000	1.000	1.000	0.000	EACH		
59	Providing and fixing PTMT liquid soap container 109mm wide, 125mm high and 112mm distance from wall of standard shape with bracket of the same materials with snap fittings of approved quality and colour. weighing not less than 105 gms.	0.000	1.000	1.000	1.000	0.000	EACH		
60	Providing and fixing 8 mm dia C.P. / S.S. Jet with flexible tube upto 1 metre long with S.S. triangular plate to European type W.C. of quality and make as approved by Engineer - in - charge.	1.000	1.000	1.000	1.000	1.000	EACH		

PHC Pinjore (Panchkula) – Civil works

S.No	Description of work	Nos	L in M	B in M	D in M	Qty	Unit	Unit Rate in Rs.	Total Rate in Rs.
61	Providing and fixing PTMT grating of approved quality and colour. Rectangular type with openable circular lid								
	150 mm nominal size square 100 mm diameter of the inner hinged round grating	1.000	1.000	1.000	1.000	1.000	EACH		
LMR ITEMS									
STEEL ALMIRAH									
	1. Internal Size of Almirah: 1850 (H) X 900 (W) X 450 (D) mm								
	2. Leg Size of Almirah: 150 (H) X 120 (W) X 450 (D) mm								
	3. Rack with 5 Compartments of 4 no. of shelves. Distance between each shelf will be 360 mm. These 4 shelves should be hanging arrangement (adjustable).								
	4. Standard lock and 2 sets of keys.								
	5. The thickness of the Almirah sheet shall be 18 SWG.								
	6. The body of the Almirah shall be manufactured from cold rolled MS sheet (C. R. Sheet) with Antirust treatment and shall be finished with powder coating.								
	7. Color of paint: grey color (spray painting).								
	8. Paint Brand: Standard brand like Asian/Berger/Nerolac etc.								
	9. The quality of used M.S sheet for making Almirah shall be free from any pitting and corrosion etc.								
	10. H/D Rubber bushes shall be provided to the bottom of legs of Almirah.								
79	Supply of the steel almirah of make BADRA or India Steel or equivalent as per the manufacturer specifications . Size: 2000 (H) X 900 (W) X 450 (D) mm	1.000	1.000	1.000	1.000	1.000	EACH		
	Supply and fixing of 3 MM Sun board with digital vinyl printing Size: Required size as per the direction from Engineer incharge	26.000	1.000	1.000	1.000	26.000	MSQ		
WHITE BOARD with glass box									

PHC Pinjore (Panchkula) – Electrical works					
SL No.	Description of work	Qty	Unit	Unit Rate in Rs.	Total Rate in Rs.
1	Point wiring in PVC conduit with modular type switch.				
	Wiring for light point/ fan point/ exhaust fan point/ call bell point with 1.5 sq.mm FRLS PVC insulated copper conductor single core cable in surface / recessed medium class PVC conduit, with modular switch, modular plate, suitable GI box and earthing the point with 1.5 sq.mm FRLS PVC insulated copper conductor single core cable etc. as required. switch, modular plate, suitable GI box and earthing the point with 1.5 sq.mm FRLS PVC insulated copper conductor single core cable etc. as required.				
	Group C	6	Point		
2	Wiring through PVC conduit				
	Wiring for circuit/submain wiring along with earth wire with the following sizes of FR PVC insulated copper conductor, single core cable in surface/recessed medium class PVC conduit as required.(Make:Havells/Finolex/V-guard/Polycab)				
a	2X1.5 sq.mm + 1X1.5 sq.mm earth wire	10	Metre		
b	2X2.5 sq.mm + 1 X2.5 sq mm earth wire	0	Metre		
c	2X4 sq.mm + 1X4 sq.mm earth wire	0	Metre		
3	Telephone wiring in existing conduit:				
	Supplying and drawing following pair 0.5 sq mm FR PVC insulated annealed copper conductor, unarmored telephone cable in the existing surface/ recessed steel/ PVC conduit as required.				
a	2 Pair	0	Metre		
4	A/C point				
	S/F 20A SPN MCB industrial socket outlet: Supplying and fixing 20 amps, 240 volts, SPN industrial type, socket outlet, with 2 pole and earth, metal enclosed plug top alongwith 20 amps "C" curve, SP, MCB, in sheet steel enclosure, on surface or in recess, with chained metal cover for the socket out let and complete with connections, testing and commissioning etc. as required.(Make: Legrand/Havells/HPL)	0	Point		
5	Modular type blanking plate:				
	Supplying and fixing modular blanking plate on the existing modular plate & switch box excluding modular plate as required.(Make: Legrand/Havells/HPL)	3	Each		
6	Modular boxes, bases & cover plate:				
	Supplying and fixing following size/modules, GI box along with modular base & cover plate for modular switches in recess etc as required.(Make: Legrand/Havells/HPL)				
a	2 module	0	Each		
b	3 module	12	Each		
c	4 module	0	Each		
d	6 module	0	Each		
e	8 module	0	Each		
f	12 module	0	Each		
7	Modular type switch/socket:				

PHC Pinjore (Panchkula) – Electrical works					
SL No.	Description of work	Qty	Unit	Unit Rate in Rs.	Total Rate in Rs.
	Supplying and fixing following modular switch/socket on the existing modular plate & switch box including connections but excluding modular plate etc as required. (Make: Legrand/Havells/HPL)				
a	5/6 Amps switch	6	Each		
b	3 pin 5/6 Amp socket outlet	6	Each		
c	15/16 Amps switch	0	Each		
d	6pin 15/16 Amps (universal) socket outlet	0	Each		
e	Telephone socket outlet	0	Each		
8	S/F PVC conduit:				
	Supplying and fixing of following sizes of medium class PVC conduit along with accessories in surface/recess including cutting the wall and making good the same in case of recessed conduit as required.(ISI Make)				
a	20 mm	200	Metre		
b	25 mm	0	Metre		
	Installation Testing & Commissioning				
9	ITC Fluorescent fitting directly on surface: Installation, testing and commissioning of pre-wired, fluorescent fitting / compact fluorescent fitting/LED of all types, complete with all accessories and tube etc. directly on ceiling/ wall, including connection with 1.5 sq. mm FR PVC insulated, copper conductor, single core cable and earthing etc. as required.	3	Each		
10	ITC Ceiling fan/Wall fan: Installation, testing and commissioning of ceiling fan, including wiring the down rods of standard length (upto 30 cm) with 1.5 sq. mm FR PVC insulated, copper conductor, single core cable etc. as required.	0	Each		
11	Supplying and fixing two module stepped type electronic fan regulator on the existing modular plate switch box including connections but excluding modular plate etc. as required.	0	Each		
12	LAYING OF CABLES				
	CABLE LAYING				
	Wiring for circuit/ submain wiring alongwith earth wire with the following sizes of FRLS PVC insulated copper conductor, single core cable in surface/ recessed medium class PVC conduit as required.				
a	FROM Mains TO DB				
	2 X 4 sq. mm + 1 X 4 sq. mm earth wire	0	Metre		
13	END TERMINATION				
	Supply and making end termination with brass compression gland, earth clip and aluminium lugs for following size of PVC insulated and PVC sheathed/XLPE aluminium conductor cable fo 1.1KV grade as required.				
	2 X 4 sq. mm + 1 X 4 sq. mm earth wire	0	Each		
15	S/F of SPN MCB PDB				

PHC Pinjore (Panchkula) – Electrical works					
SL No.	Description of work	Qty	Unit	Unit Rate in Rs.	Total Rate in Rs.
	Supplying and fixing following way, single pole and neutral, sheet steel, MCB distribution board, 240 V, on surface/ recess, complete with tinned copper bus bar, neutral bus bar, earth bar, din bar, interconnections, powder painted including earthing etc. as required. (But without MCB/RCCB/Isolator)				
a	6 way Double door, horizontal type	0	Each		
b	16 way Double door ,horizontal type	0	Each		
C	12 way Double door ,horizontal type	0	Each		
16	S/F OF SP MCB				
	Supplying and fixing 5 A to 32 A rating, 240/415 V, 10 kA, “C” curve, miniature circuit breaker suitable for inductive load of following poles in the existing MCB DB complete with connections, testing and commissioning etc. as required.				
	6/32 A SP MCB	2	Each		
17	S/F DP ISOLATOR				
	Supplying and fixing following rating, double pole, (single phase and neutral), 240 volts, ISOLATOR having a sensitivity current upto 100 to 300 milliamperes in the existing MCB DB complete with connections, testing and commissioning etc, as required.(Make: Legrand/Havells/HPL)				
	40 A	0	Each		
18	S/F DP RCCB				
	Supplying and fixing following rating, double pole, (single phase and neutral), 240 V, residual current circuit breaker (RCCB), having a sensitivity current 30 mA in the existing MCB DB complete with connections, testing and commissioning etc. as required.				
	25 A	0	Each		
NDSR ITEMS					
1.1	Supply of 15W LED tube fitting sleek with decorative end cap, powder coated CRCA steel channel complete with all electrical accessories like electronic ballast, lamp holder, 28W LED lamp etc complete as required. (Philips / Wipro /HAVELLS)	6	Each		
1.2	Supply and installation of 18 W CFL with its all accessories.[ISI MAKE]	3	Each		
1.3	Supply and installation of wall fan, white colour, 5 star rated as per BEE complete with blades, casing , wall mounting accessories etc(Make Havells/bajaj/usha/V-guard/crompton)	0	Each		
1.4	Supply and installation EXHAUST FAN,SHUTTER TYPE white colour, 9" OR 10" star rated as per BEE complete with its all accessories(Make Havells/bajaj/usha/V-guard)	0	Each		
2	Miscellaneous Items				
3	CABLE SUPPLY				
	Supplying the following PVC insulated and PVC sheathed/XLPE power cable of 1.1 KV grade as per CPWD standards as required. (Make:Havells/ Glostar/Nicco/Finolex/Polycab)				
	2 X 4 sq. mm + 1 X 4 sq. mm earth wire (3 Nos. of 4 Sq.mm wire)	0	Metre		
	Total Amt in Rs.				
	GST @ 18%				
	Grand Total in Rs.				

SCHEDULE VI
ARCHITECTURAL DRAWING
EXISTING SITE – PHC HANGOLA

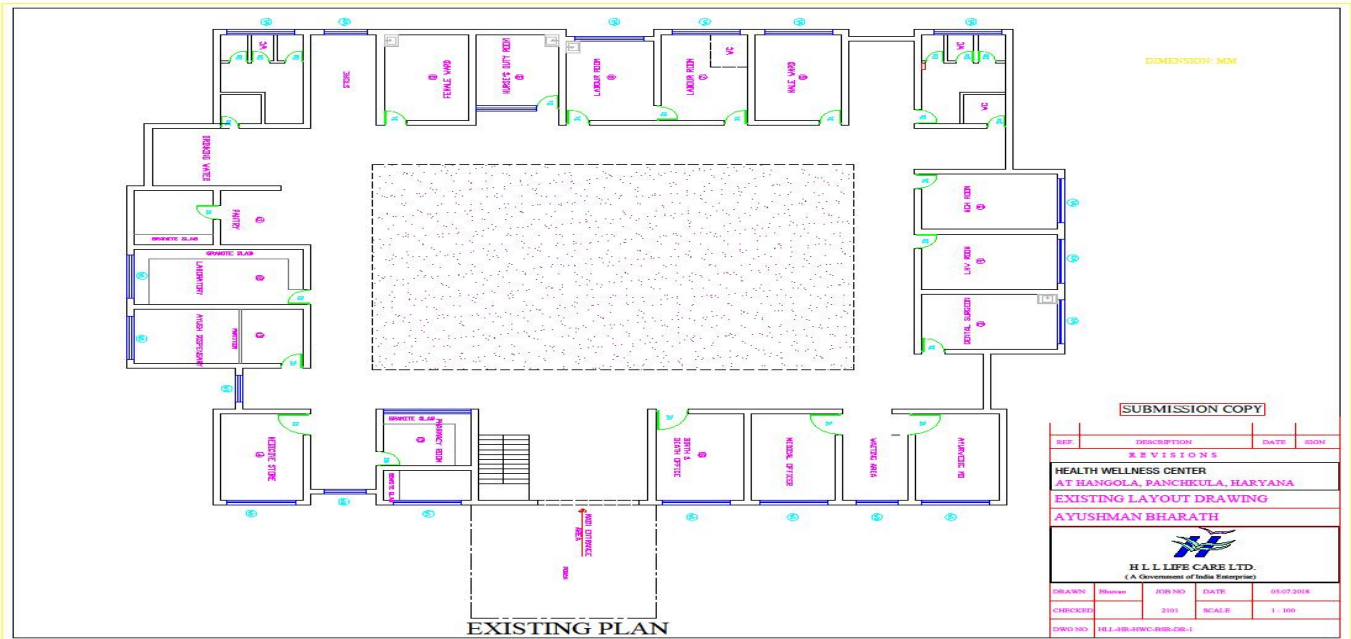

PROPOSED SITE



EXISTING SITE – KOT

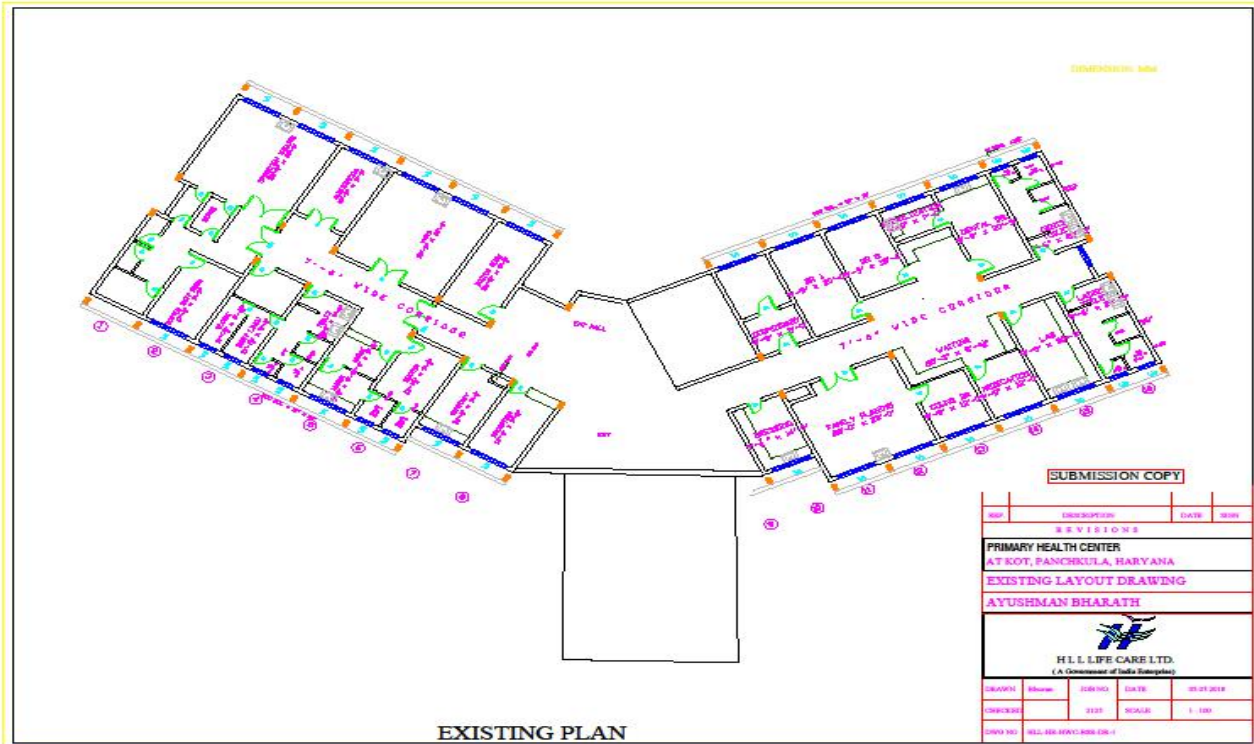

SUBMISSION COPY			
NO.	DESCRIPTION	DATE	BY
REVISIONS			
PRIMARY HEALTH CENTER			
AT KOT, PANCHKULA, HARYANA			
EXISTING LAYOUT DRAWING			
AYUSHMAN BHARATH			
 H.L.L. LIFE CARE LTD. (A Government of India Enterprise)			
DESIGN	BY	DATE	BY
CHECKED	BY	SCALE	1 : 100
DWG NO.	HLL-001-000-000-00-1		

PROPOSED SITE

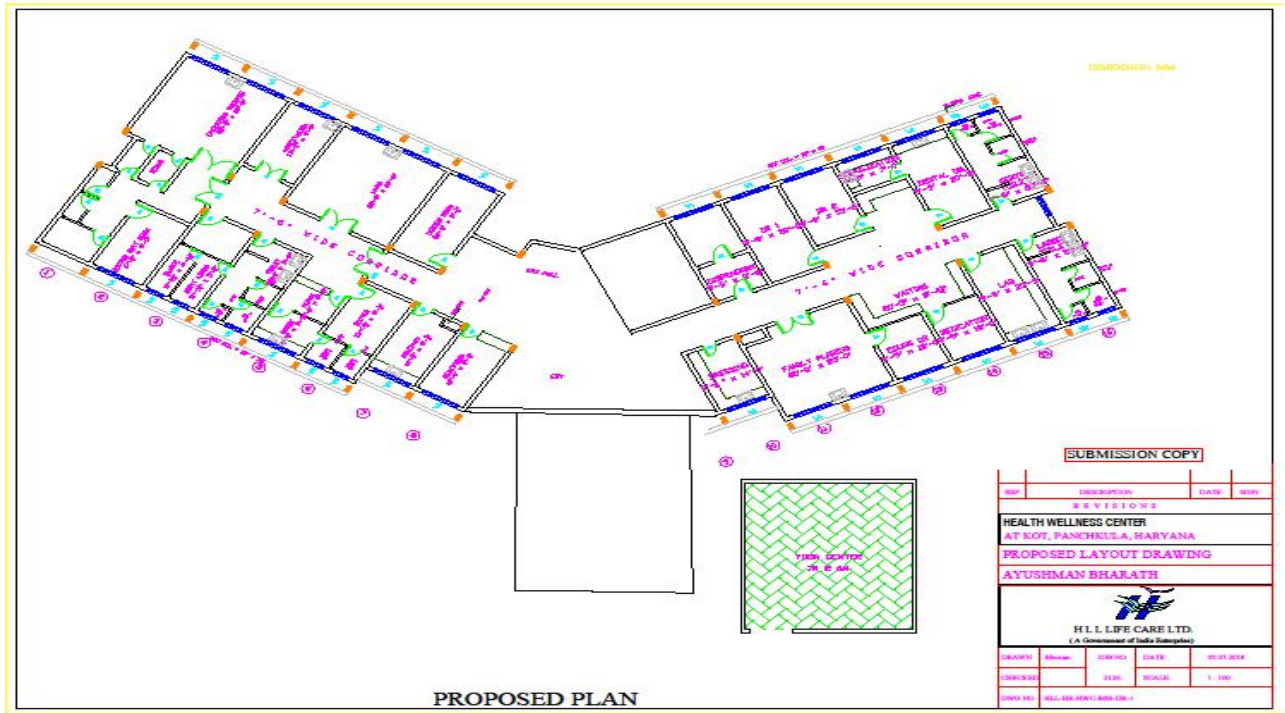

SUBMISSION COPY			
NO.	DESCRIPTION	DATE	BY
REVISIONS			
HEALTH WELLNESS CENTER			
AT KOT, PANCHKULA, HARYANA			
PROPOSED LAYOUT DRAWING			
AYUSHMAN BHARATH			
 H.L.L. LIFE CARE LTD. (A Government of India Enterprise)			
DESIGN	BY	DATE	BY
CHECKED	BY	SCALE	1 : 100
DWG NO.	HLL-001-000-000-00-1		

EXISTING SITE – NANAKPUR

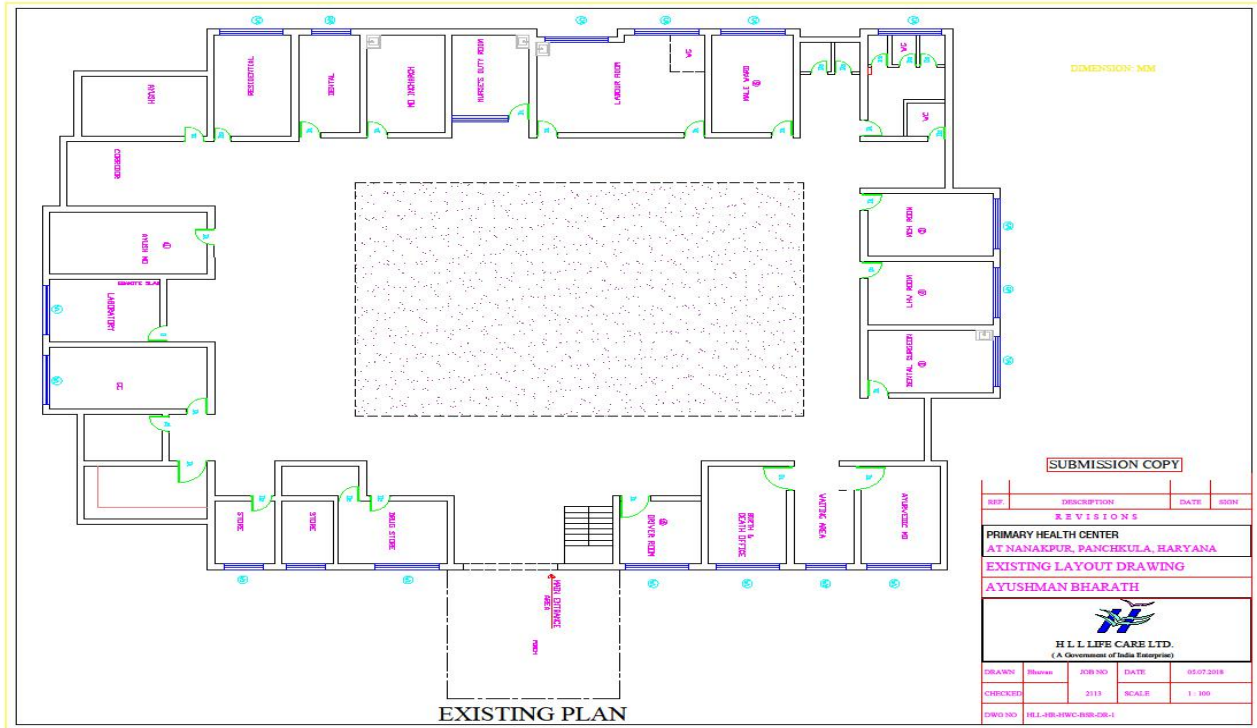

PROPOSED SITE

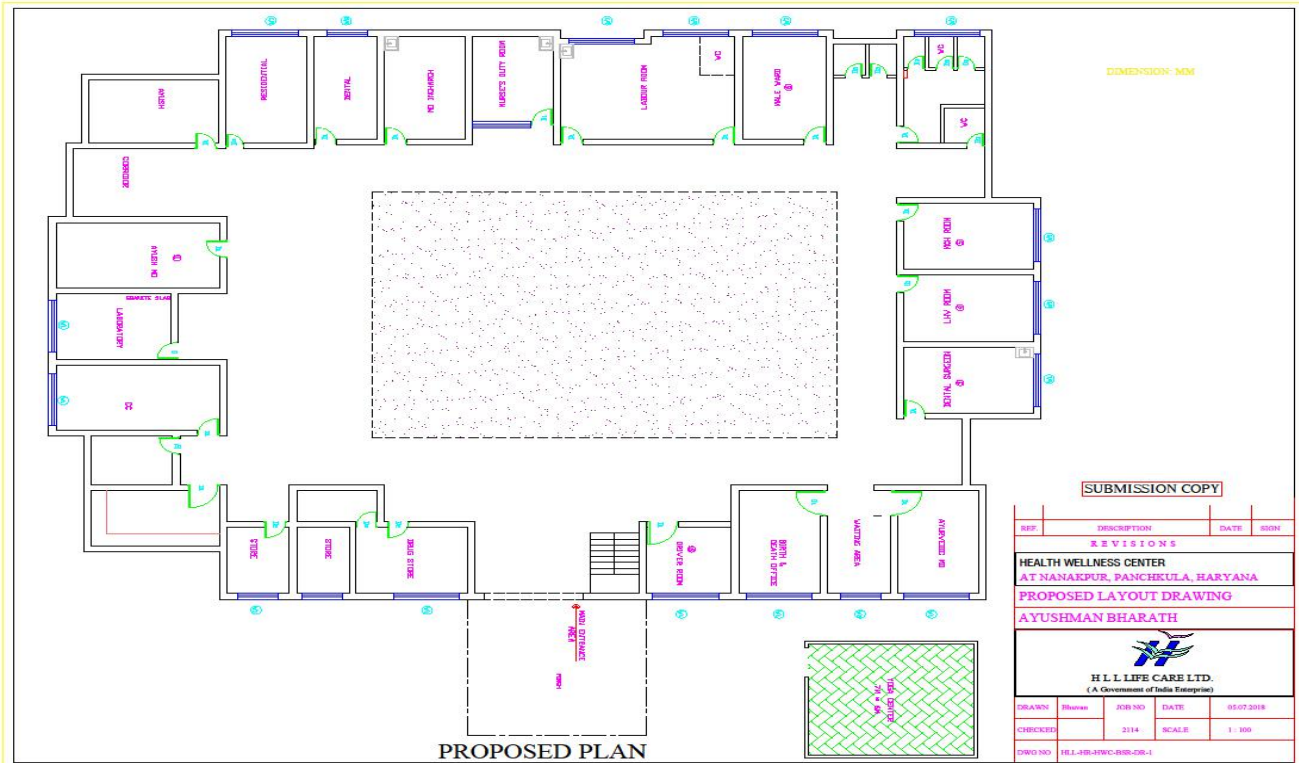

EXISTING SITE – PINJORE

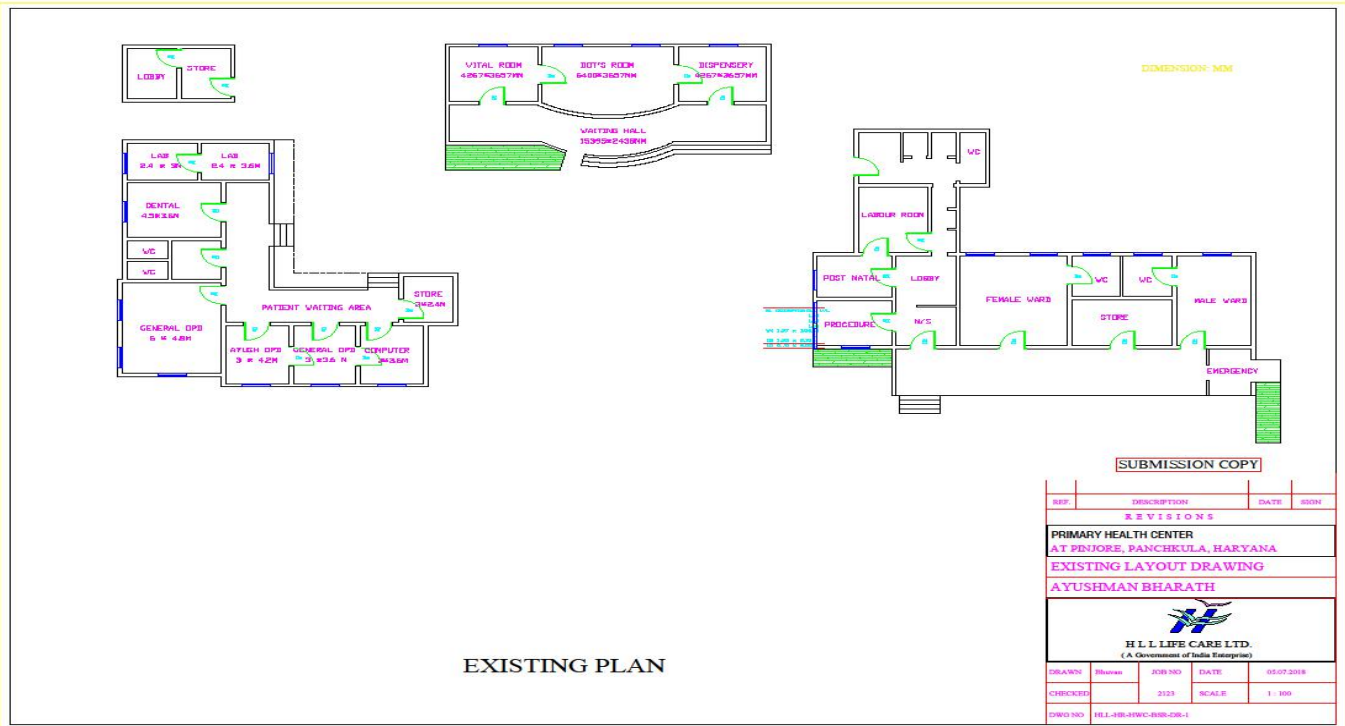

PROPOSED SITE

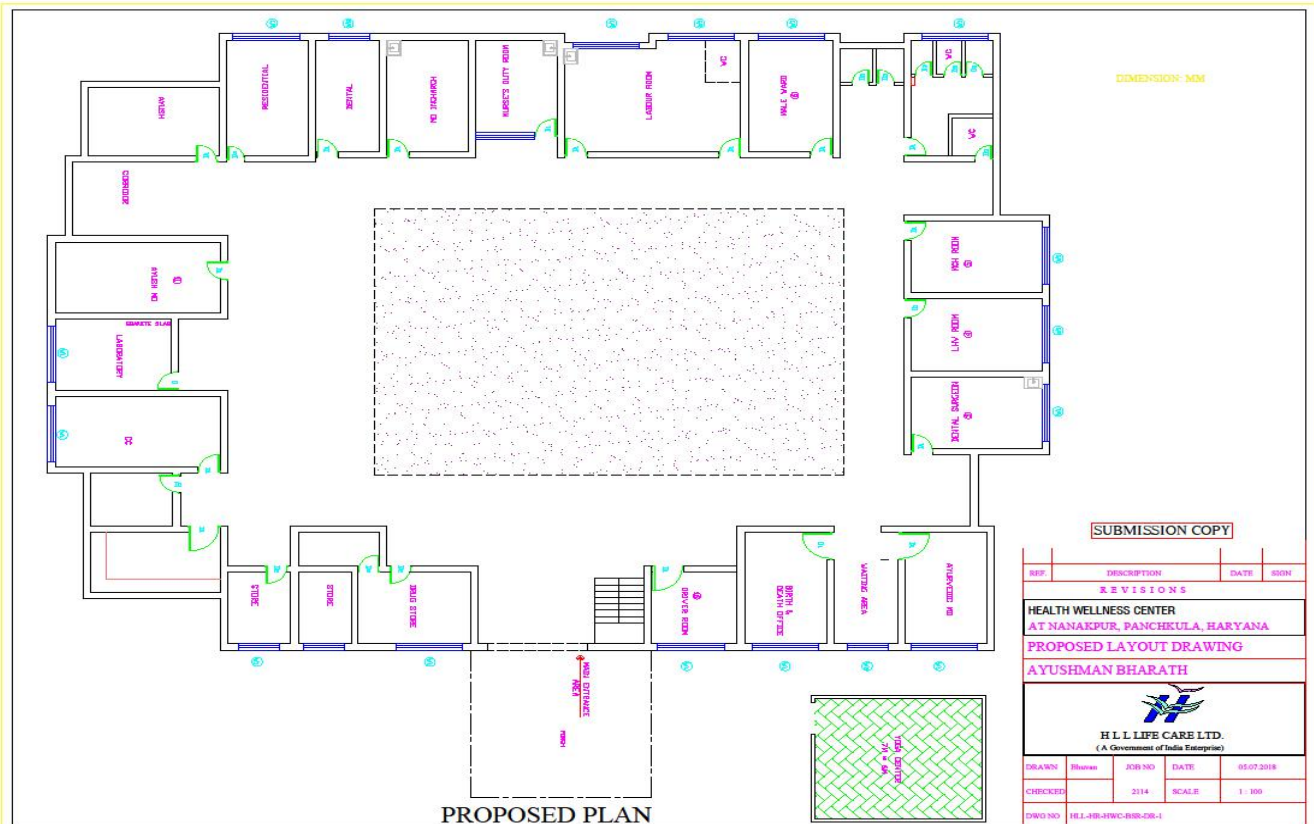

DESIGN

1) **BORDER**

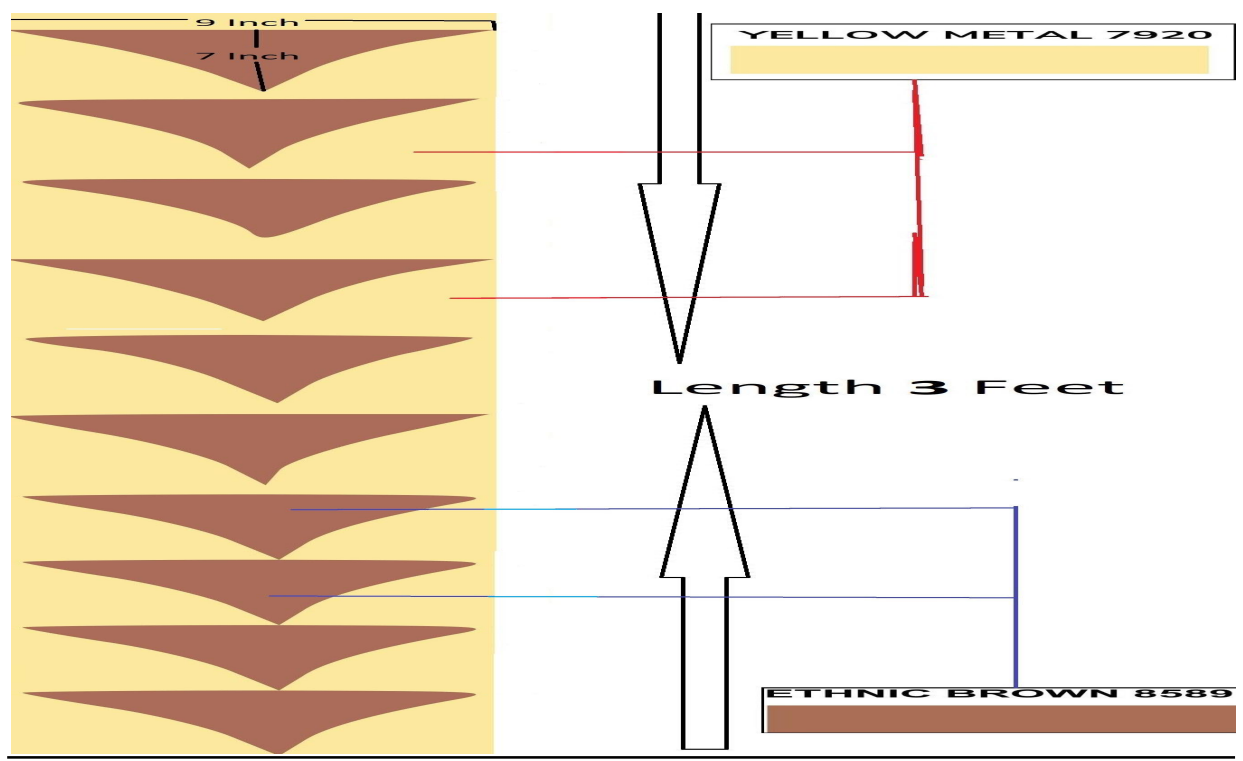
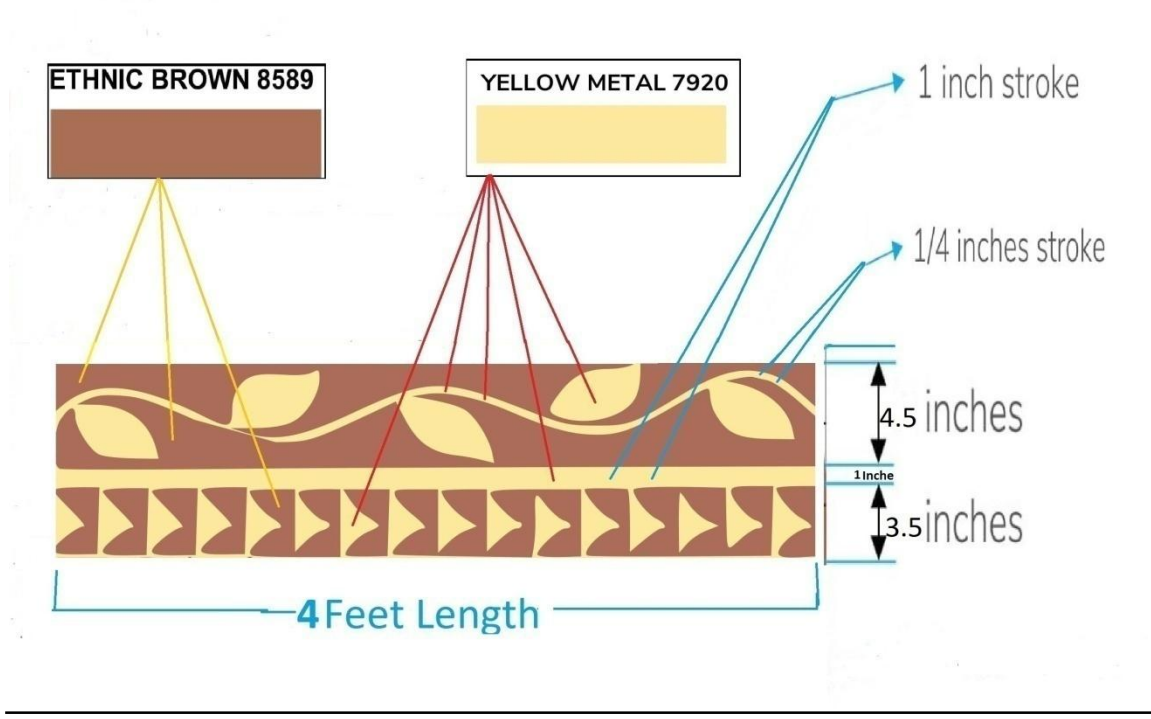

2) **NHM LOGO**

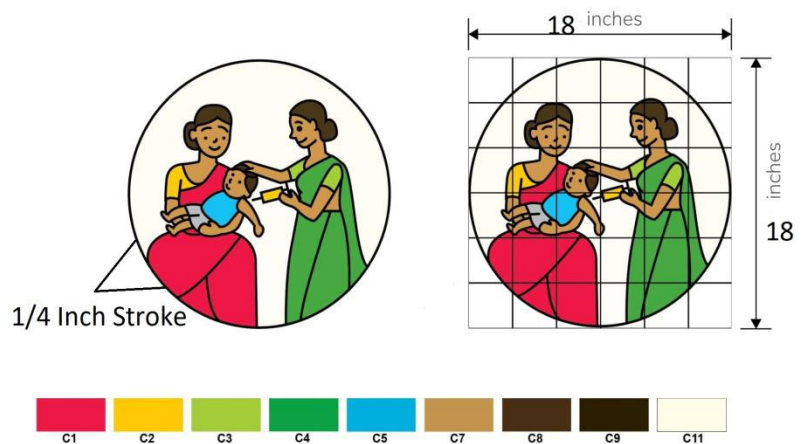
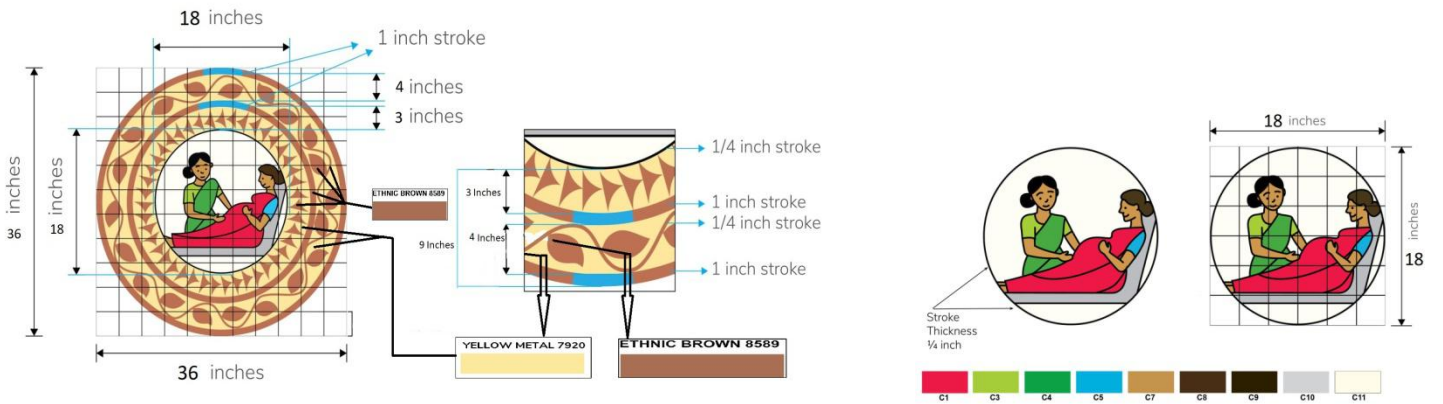
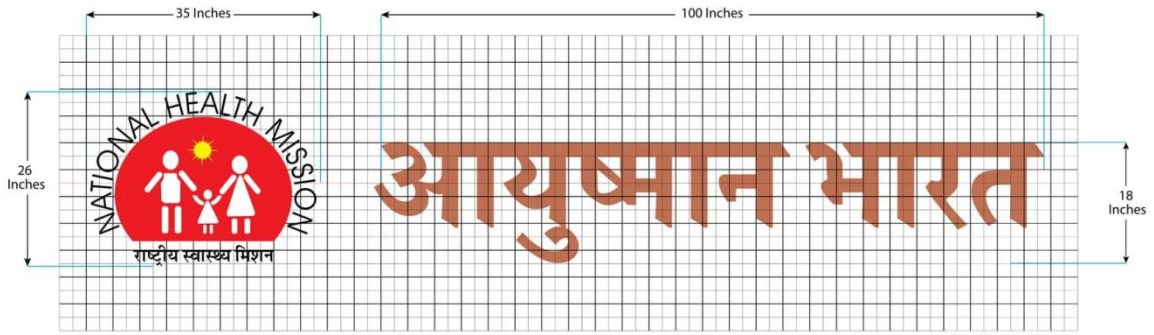

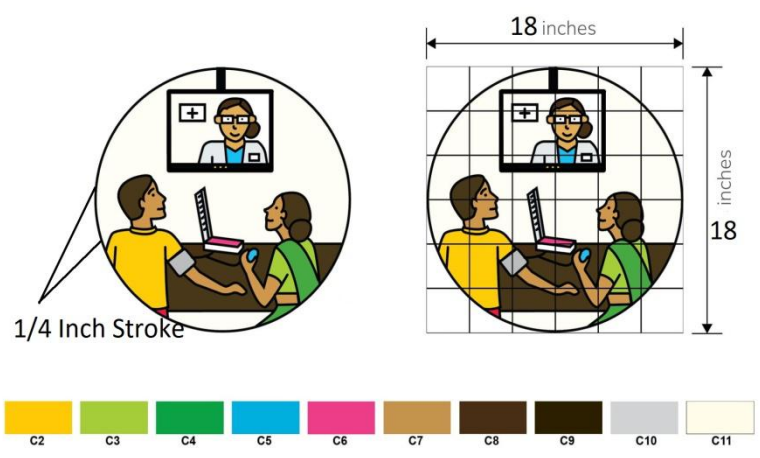
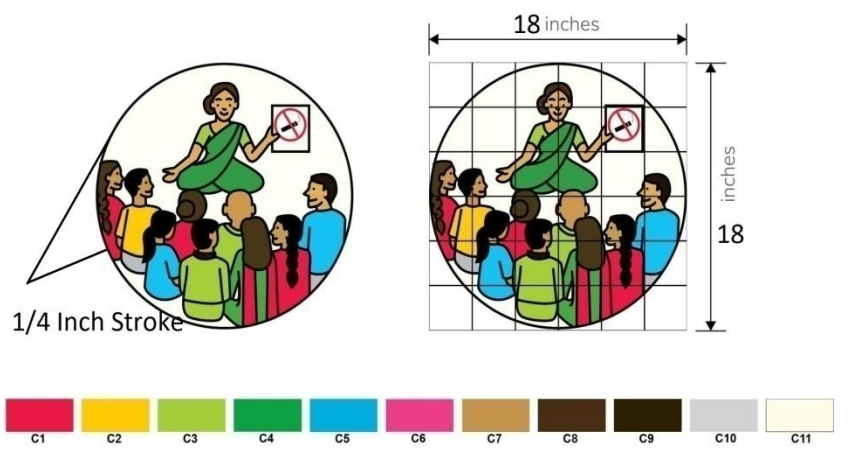
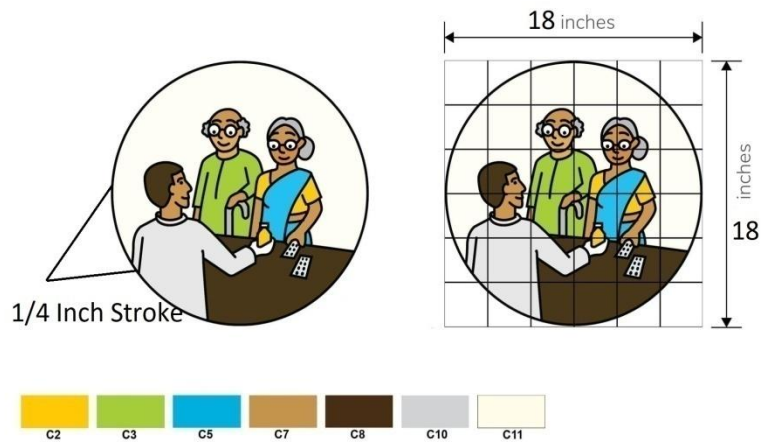

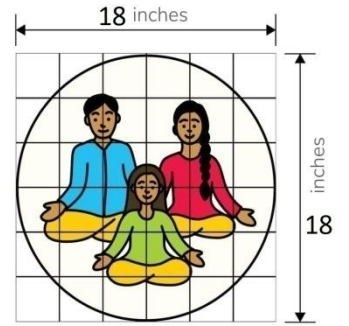
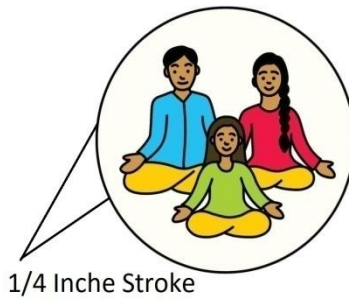

C1: Pure Red 8093



C2: Mango 7909



C3: Lemon Blast 9365



C4: Forest Glade X158



C5: Azure Sky 7407



C6: Shocking Pink 8126



C7: Peanut Butter 8559

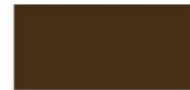

C8: Cafe Latte 8549



C9: Bravo 8429



C10: Silver Trinket 8298



C11: Blank Canvas 7932



Example of how the design works on different building facade layout & sizes

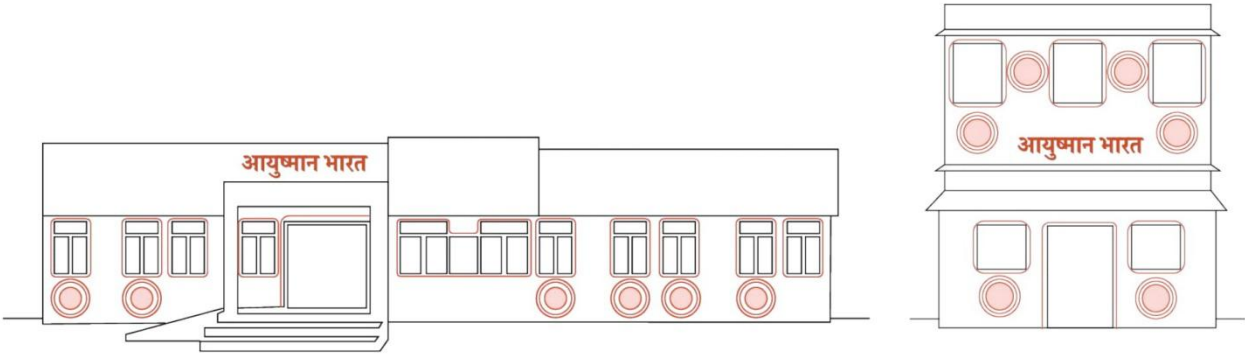

Example of how the design works on different building facade layout & sizes

