

PROPOSED FLOOR PLAN

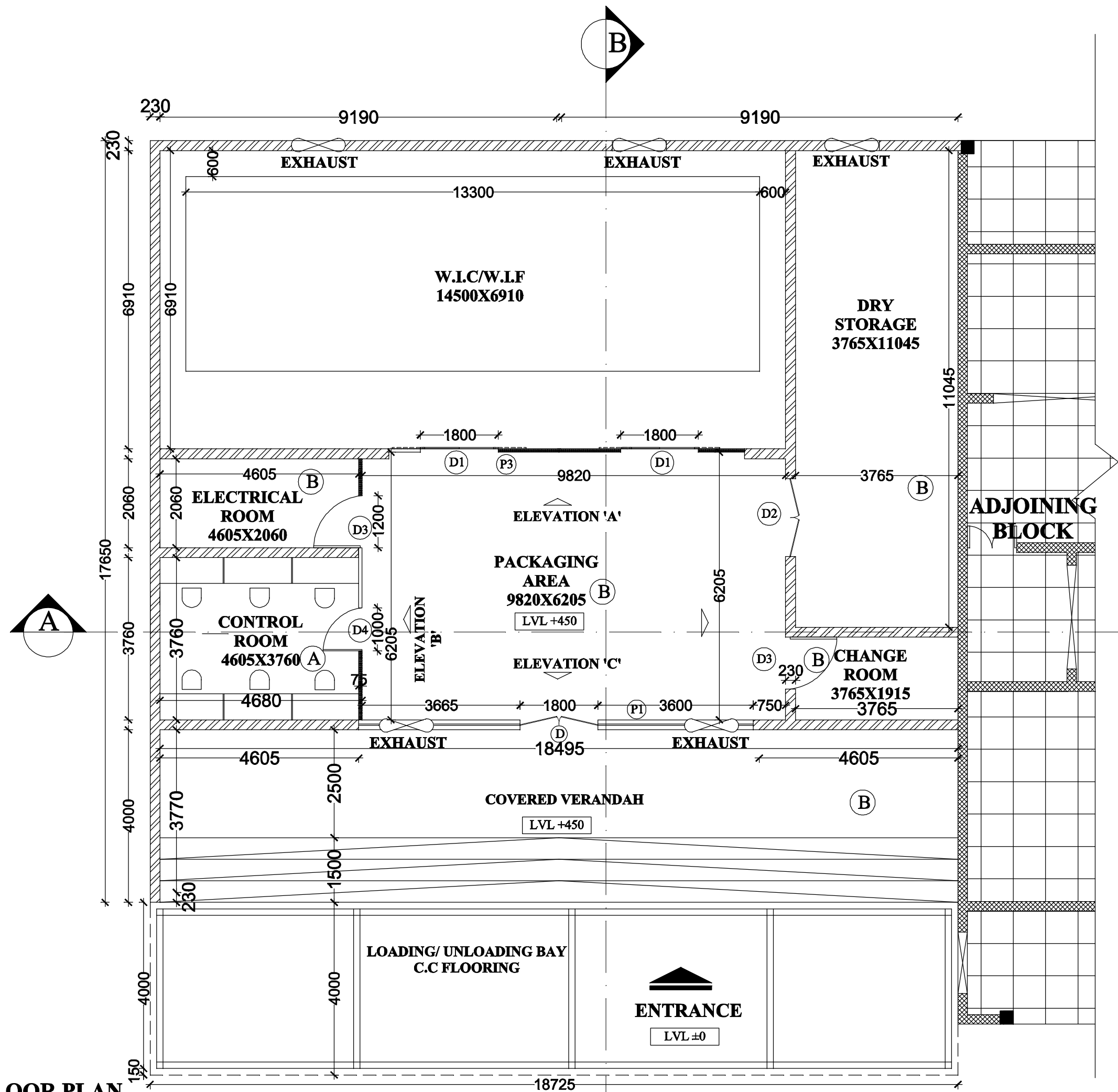

GMSD - KARNAL

DRAWING

KEY PLAN

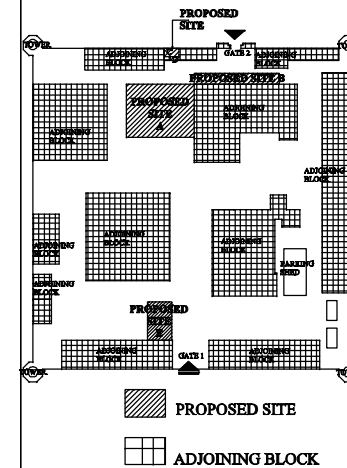

- NOTES:
1. This drawing is copyright.
 2. This drawing should not be reproduced or handed over to third party without consent of competent authority.
 3. Do not scale from this drawing.
 4. All dimensions are in millimetres unless noted otherwise.
 5. These drawings are only indicative and not to be used for construction on site.
 6. Do not make any structural changes on site. The same are not recommended.

S.NO.	REVISION (READ DOWNWARD)	DATE
1.		
2.		
1.	FOR TENDER	18-01-10
S.NO.	ISSUED TO (READ UPWARD)	DATE

PROJECT

UPGRADATION OF COLD CHAIN FACILITIES IN THE GOVERNMENT MEDICAL STORE DEPOTS AT DELHI KARNAL, HYDERABAD, MUMBAI, CHENNAI KOLKATA & GUWAHATI.

FLOOR PLAN	SCALE
(KARNAL)	JAN'2010
TITLE	DATE

OWNER:-

ARCHITECT:-

AR	DWG.NO.: GMSD/KAR/AR/02
	DEALT BY:

ARCHITECT :

SURINDER SAWHNEY ASSOCIATES

ARCHITECTS & DESIGN CONSULTANTS

571, SECTOR-18-B, CHANDIGARH

E-MAIL: surindersawhney@sify.com

PH:0172-2780535, FAX : 0172-2726627.