

TENDER DOCUMENT

RENOVATION WORKS FOR HINDLABS MRI CENTRE AT GOVT MEDICAL COLLEGE HOSPITAL ,THRISSUR

**PROJECTS DIVISION,
HLL LIFECARE LTD,
CORPORATE HEAD OFFICE, POOJAPPURA,
THIRUVANANTHAPURAM – 695 012,
KERALA, INDIA
PHN: ++91 471 2354949, 2775588**

DECEMBER 2017

HLL LIFECARE LIMITED

(A Government of India Enterprise)
 Projects Division
 Corporate Head Office, Poojappura.P.O,
 Thiruvananthapuram – 695012,
 Kerala, India
 Phn: 0471- 2354949, 2775588

INVITATION FOR BIDS (IFB)

IFB No : HLL/CHO/PROJ/HCS/TCR-MRI/C&E/2017-18

Date : 11-12-2017

HLL Lifecare Limited (HLL), a Government of India Enterprise is in the process of renovation of HINDLABS MRI Centre at Thrissur. For the said project, sealed and super scribed bids are invited from competent and experienced Suppliers/Contractors who are capable to do the following work meeting the requirements as per our tender.

Sl. No	Brief Description of Item/Work	Qty	EMD in Rs
1	Renovation Works for HINDLABS MRI Centre at Govt. Medical College Hospital, Thrissur.	As per Schedule V	Rs 6,000/-

2. The bid documents will be available up to 15.00 Hrs. on the previous working day of the opening of the bids. The scheduled date for issue, receipt and opening of bids is as follows.

- a) Date of issue of tender document - 11-12-2017 onwards
- b) Last date and time for receipt of bids - 28-12-2017 up to 15.00 Hrs.
- c) Date and time of opening of bids - 28-12-2017, 15.30 Hrs.
- d) Address for communication, receipt and place of opening of bids:

SENIOR MANAGER (PROJECTS),

Projects Division,
 HLL Lifecare Limited (A Government of India Enterprise)
 Corporate Head Office, Poojappura.P.O,
 Thiruvananthapuram – 695012,
 Kerala, India
 Phn: 0471- 2354949, 2775588
 E-mail: harikrishnankp@lifecarehll.com, choprojects@lifecarehll.com

3. The completed and sealed bid documents should be submitted to Senior Manager (Projects), in the above address along with the EMD. The outer cover should bear the Enquiry No, closing date and General description of item tendered, and the words "DO NOT OPEN BEFORE" 15.30 Hrs (IST) on ----- (Indicate the Closing Date). EMD shall be submitted in the form of demand draft drawn from a

nationalized bank in favor of HLL Lifecare Limited payable at Thiruvananthapuram. Bids received after due date and time will be rejected. Any bid not accompanied by EMD will be rejected.

4. Bids will be opened in the presence of Bidders representative(s) who choose to attend on the specified date and time, at the office of HLL at the address given in Clause 2 (d) above.
5. In the event of the date specified for bid receipt and opening being declared as a closed holiday for the above purchaser's office, the due date for submission of bids and opening of bids will be the following working day at the appointed times.
6. HLL may, at its discretion, extend this deadline for submission of bids by amending the Bid Documents or any other reasons, in which case all rights and obligations of HLL and Bidders previously subject to the deadline will thereafter be subject to the deadline as extended.
7. HLL will not be held responsible for the postal delay, if any, in the delivery of the bidding document or the non-receipt of the same. Bids sent by Telex/Fax/Telegraph will not be accepted.
8. The EMD should be enclosed in a separate envelope and super scribed as "EMD" and to be attached in the main cover.
9. SSI units interested in availing exemption from payment of EMD should submit a valid copy of their registration certificate issued by the concerned DIC or NSIC.
10. The company reserves the right to club or split the items of works, change the qualifying criteria at their discretion and to reject or cancel the Invitation for bids without assigning any reason thereof.
11. The Bid must include the following information;
 - a. Enquiry No.
 - b. EMD
 - c. Promised Delivery/Completion Schedule
 - d. Price Schedule in Format For Quoting (Schedule V)
 - e. All other documents/certificate/information as specified in the bid document.
12. In addition to the invitation for bids, the bidding documents include the following schedules.

Schedule II	-	Conditions of Contract
Schedule III	-	Acceptance Form
Schedule IV	-	Drawings
Schedule V	-	Schedule of Work

SENIOR MANAGER (PROJECTS)

SCHEDULE II

CONDITIONS OF CONTRACT

1) PRICE

The price quoted should be inclusive of all material cost, loading and unloading charges, all applicable taxes and other levies, labor charges, insurance etc. The **Schedule of Work** is enclosed as **Schedule V**.

Price quoted should be firm without any escalation till the order is completely executed.

2) TAXES/DUTIES/LEVIES

The contractor shall be entirely responsible for all taxes including sales tax, service tax, entry tax, duties, license fees etc. incurred until successful completion of contract.

3) ESCALATION

The rates quoted by the Contractor in the contract documents shall be final and shall not be subjected to any change due to the increase in labour wages or inflation in the cost of materials or any other price variations due to any reason during the stipulated time period of the contract or during the extended time period of completion.

Rates quoted should be inclusive of all cost of materials, Tools/Equipments labor charges, conveyance to site, handling charges, loading and unloading charges, hiring charges, clearing of debris, statutory payments etc.

4) COMPLETION TIME

Work should be completed within **4 WEEKS** from the date of issuing the Letter Of Intent or Work Order.

5) PAYMENT TERMS

The contractor can submit two running account bills during the work period and payment made as below:

- a) 80% of the bill value will be paid on each running account bill submitted by the contractor.
- b) Balance 20% will be paid along with the final bill only after issue of Work Completion certificate by Engineer In Charge/Officer In Charge of HLL Lifecare Ltd.

5% amount of the Bill will be retained as retention money and will be released only after the Defect liability period of 12 months.

The running account bills are to be submitted detailing the work description, quantity and rate as per the Work Order. Payment will be made against actual measurements

recorded and certified jointly by HLL Engineer in charge and the Contractor's representative.

Tax Deduction: All statutory deductions like Income Tax, Works Contract Tax, E.S.I., P.F. or any other government-imposed liabilities shall be borne by the Contractor (as applicable at the time of execution of job) and shall be deducted from each bill submitted by the Contractor.

6) SECURITY DEPOSIT

- 6.1 Simultaneously with the execution of the contract successful bidder shall furnish a Security deposit in the form of a Demand Draft from a nationalised bank drawn in favour of HLL Lifecare Limited, Peroorkada Factory, Thiruvananthapuram payable at Thiruvananthapuram or a Bank Guarantee from a nationalized bank, for an amount equal to 10% of the total contract value as Security Deposit for his faithful execution of contract. The Security deposit should be valid until successful completion of the contract and acceptance of the Equipment/works by the Purchaser/Owner and will be released after acceptance of the Equipment/works by the Purchaser/Owner. In case of a delay in the works the validity of security deposit shall be extended.
- 6.2 Within 10 days of the receipt of notification of award from the Purchaser/Owner; the successful Bidder shall furnish the security deposit in the form of a Demand Draft or Bank Guarantee in the security deposit form to be sent along with the Notification Of Award.
- 6.3 Failure of the successful Bidder to accept the notification of award or submission of security deposit within the timeframe shall constitute sufficient grounds for the annulment of the award and forfeiture of the EMD, in which even the Purchaser/Owner may make the award to the next lowest evaluated bidder or call for new bids.

7) EARNEST MONEY

- 7.1 Each bid must be accompanied by E.M.D.
- 7.2 The EMD is required to protect the Purchaser/Owner against risk of Bidder's conduct, which would warrant the security's forfeiture.
 - a. The EMD shall be in the form of cash deposit or demand draft from a nationalized bank drawn in favour of HLL Lifecare Limited, Registered and Corporate Office, Poojappura, Thiruvananthapuram payable at Thiruvananthapuram.
 - b. E.M.D. from unsuccessful bidders will be returned after the acceptance of order by the L1 party.
 - c. In the case of successful bidder, the Earnest Money will be returned after signing the contract, and submission of Security Deposit, which they will have to offer for the faithful execution of the contract.

7.3 The EMD may be forfeited:

- (a) If a Bidder withdraws its bid during the period of bid validity specified by the Bidder on the Bidding Document; or
- (b) In case of the successful Bidder, if the Bidder fails:
 - (i) to sign the Contract
 - (ii) to furnish security deposit

8) INDEMNIFICATION CLAUSE

The Bidder shall indemnify and hold harmless the Owner/Purchaser from and against the below mentioned:

- i. All claims, demands, action, proceedings, losses, damages, liabilities, cost, charges, expenses or obligations that are occasioned or may occasion to HLL as a result of our non-payment of any statutory dues levied/leviable on the Contractor or the Contractor committing breach of any the rules, regulations, orders, directives, instructions that may be issued by any authority under various Labor Laws, PF, ESI Acts and all other applicable Laws/Acts/Rules or any other Statue or Laws for the time being in force
- ii. Any damages, loss or expenses due to or resulting from any negligence or breach of duty on our part or on the part of Sub-Contractor/s, if any, servants or agents of the Bidder.
- iii. Claims, if any, of the employee or the Contractor and its Sub Contractor/s, under the Workmen's Compensation Act, 1923 and Employer's Liability Act 1938 or Various Labor Laws or any other Laws rules and regulations in force for the time being in India and any acts replacing and/or amending the same or any of the same as may be in force at the time and under any law in respect of injuries to persons or property arising out of and in the course of the execution of the contract work and / or arising out of and in the course of employment of any workmen / employee.
- iv. Any non - compliance or improper compliance of statues, rules and regulations which are applicable to HLL and also to the Contractor and to the employees , in respect of (a) Employees' Provident Fund and Miscellaneous Provision Act, 1952, (b) Employees State Insurance Act, 1948, © Contract Labor (R&A) Act, 1970 (d) Minimum Wages Act, 1948 (e) Payment of Wages Act,1936 (f) Bonus Act, 1965 (g) Workmen's Compensation Act, 1923 and / or any other laws which may become applicable in respect of the Contract/ Agreement between HLL and the Bidder.
- v. Any Act or omission by us or our Sub-contractor/s, if any, our /their servants or agents which may involve any loss, damages, liability, civil or criminal action.
- vi. To protect against all claims for damage caused due to non-obtaining of insurance policy during the project period.

9) DEFECT LIABILITY PERIOD:

The defect liability period of the work shall be 12 months from the date of completion of the work and this date will start from successful completion and handing over. If any damage or defect occurs in the work during this period then the Contractor shall rectify the damage or defect at his own expense to the satisfaction of the Purchaser/Owner. If the Contractor fails to do so, then the Purchaser/Owner shall have the authority to get the work done by other means and the expenditure incurred shall be recovered from the Contractor.

Even if Inspection and/or tests are fully carried out by Purchaser/Owner or their representatives, the Contractor is not absolved to any degree of his responsibility to ensure that all equipment fabricated comply strictly with the requirements as per specifications given in the order, and the Purchaser/Owner shall be free to point out any defect till the defect liability period is over.

10) FORCE MAJEURE

- a. Neither the Contractor nor the Purchaser/Owner shall be considered in default in the performance of their obligations as per the Contract so long as such performance is prevented or delayed because of strikes, war, hostilities, revolution, civil commotion, epidemics, accidents, fire, cyclone, flood or because of any law and order proclamation, regulation or ordinance of Government or subdivision thereof or because of any act of God. The proof of existence of force majeure shall be provided by the party claiming it to the satisfaction of the other.
- b. The Contractor shall advise Purchaser/Owner initially by a Fax, followed by post, the beginning and end of any of the above causes of delay, failing which Purchaser/Owner shall not be liable to consider delays due to the above reasons. Notice as stated above should be given even in case where only the Contractor's bids are under the consideration of the Purchaser/Owner and no acceptance of the same has been given and detailed order issued.
- c. In the event of definite delay even if arising out of reasons due to force majeure, Purchaser/Owner shall have the right at their discretion to cancel the Order or part of the Order without any liability on their part to make any payment to the Contractor while reserving the right to claim refund of and any payment if advanced or paid to Contractor.

11) DELAY IN WORK EXECUTION DUE TO REASONS BEYOND CONTRACTOR'S CONTROL

- 11.1) Force majeure: If the execution of work is delayed due to force majeure, then Purchaser/Owner as per the affected period may extend the time period.
- 11.2) In case work is delayed due to non-availability of stores supplied by Owner or any decision by Owner holding the progress of work, the contractor then upon any such happening causing delay shall immediately but not later than 10 days, give notice thereof in writing to the Owner, but nevertheless use constantly his best effort to prevent or make good delay. The Owner may in his discretion grant such extension of time as may appear reasonable to him and the same shall be communicated to the contractor in writing and shall be final and binding on him

and the contractor shall be bound to complete the work within such extended time.

12) LIQUIDATED DAMAGES FOR DELAYS

If the work is not completed and handed over to the Purchaser/Owner within the time stipulated in the Order, Purchaser/Owner may at their option, either (1) recover from the Contractor liquidated damages at the rate of 0.5 % of the total contract value for every week of delay, subject to a maximum of 7.5 % of the total contract value, or (2) at the risk and cost of the Contractor and without prejudice to the other remedies/rights as per the Contract, terminate the order wholly or partially and complete it themselves or reassign it to other contractors.

13) SPECIAL INSTRUCTIONS

- 1. The bidder shall visit the site before quoting for the work and also take their own assessments before quoting of bids.**
2. All pages of the bid, except for un-amended printed literature shall be signed by the person or persons signing the bid. The seal of the company shall be stamped in all pages.
3. Bids shall be made in English. The bid shall contain no interlineations, erasures or overwriting except as necessary to correct errors made by the Bidder, in which case such corrections shall be signed by the person or persons signing the bid.
4. To assist in the examination, evaluation and comparison of bids, the Owner may, at its discretion, ask the bidder for a clarification of its bid. The request for clarification and the response shall be in writing and no change in the rate or substance of the bid shall be sought, offered or permitted.
5. Arithmetical errors will be rectified on the following basis. If there is a discrepancy between the unit price and the total price that is obtained by multiplying the unit price and quantity, the unit price shall prevail and the total price shall be calculated. If there is a discrepancy between the words and figures of unit price, the amount in words of unit price shall prevail.
6. Prior to the detailed evaluation, the Owner will determine the substantial responsiveness of each bid to the bidding documents. For purposes of these clauses, a substantially responsive bid is one, which conforms to specifications and all the terms and conditions of the bidding documents without material deviation. The Owner's determination of a bid's responsiveness is to be based on the contents of the bid itself without recourse to extrinsic evidence.
7. The Owner's determination as to the substantial responsiveness or otherwise of each bid or consideration of a minor informality or non-conformity or irregularity is final and conclusive.
8. The Owner reserves the right to negotiate with the lowest evaluated responsive bidder.

9. The Owner will award the Contract to the successful Bidder whose bid has been determined to be substantially responsive and has been determined as the lowest evaluated bid provided further that the Bidder is determined to be qualified to perform the Contract satisfactorily for the items offered.
10. Prior to the expiration of the period of bid validity, the Owner will notify the successful Bidder in writing by or cable or telex or fax, to be confirmed in writing by post, that its bid has been accepted. The notification of award may be sent in the form of Letter of Intent and/or Work order.
11. The signed acceptance of the notification of award by the Contractor will constitute a concluded contract.
12. The work should be carried out without causing any inconvenience to the public and shall ensure that no damages are caused to the existing site premises.
13. During the execution of work, the contractor or authorized representative should be present at site.
14. All Materials, Equipment's/ Tools required for the work should be arranged by the contractor and brought to site for the timely completion of the work.
15. The materials used shall be as per specification and of good quality.
16. The Contractor has to arrange necessary insurance coverage for the machine, workmen etc. deployed by him. He shall arrange all safety measures to protect his workmen and also the properties of HLL/MCG Office Building. The work site safety of all employees, their ESI, PF etc will have to be borne by the contractor.
17. The work should be carried out in truly professional manner, neatly finished with proper line, level and plumb. Cleanliness and finishing of the job is of utmost importance. Hence the job should be done most carefully with best workmanship. For all finishing jobs samples should be approved from the Purchaser/Owner before completely executing the work.
18. The Purchaser/Owner should be immediately informed for any discrepancy in drawings, specifications and instructions in the execution of job before actual execution of particular item having discrepancy.
19. Any item found to be having been executed with poor workmanship then the Contractor shall have to rectify /reconstruct the work as specified by Purchaser/Owner. No extra charge will be admissible in such case. If CONTRACTORS fails to do so, the Purchaser/Owner reserved the right to rectify/reconstruct the work through some other agency at the expenses of Contractor.
20. The schedule of activities as submitted by the Contractor shall have to be strictly adhered to. Regular progress reports shall have to be submitted by the Contractor giving all details for monitoring of the schedule.

21. The Contractor shall make initial drawings/layouts (as per site conditions) and get it approved by HLL before execution.
22. Special care is to be taken for cleanliness of the site. After the end of day's work, the site should be cleaned immediately.
23. The Contractor shall have to co-operate with the agencies executing other works in the same area.
24. While executing the work, the Contractor shall ensure safety and security of the property of the Purchaser/Owner so as to avoid theft etc.

25. Measurement & Payment terms:

The method of measurement of completed work shall be in accordance with the standard measurement. Payment will be made on satisfactorily completion of work as per the order. Interim or running account bills shall be submitted by the contractor for the work executed on the basis of such recorded measurements in the format of HLL. All such interim payments shall be regarded as payment by way of advances against final payment only, and shall not preclude the requiring of bad, unsound and imperfect or unskilled work to be rejected, removed, taken away and reconstructed or re erected. Any certificate given by the officer relating to the work done or materials delivered forming part of such payment, may be modified, or corrected by any subsequent such certificate(s) or by the final certificate and shall not by itself be conclusive evidence that any work or material so which it relates is /are in accordance with the contract and certificate. Any such interim payment,/any part there of shall not in any respect conclude, determine or affect in any way powers of the engineer in charge under the contract or any of such payment s be treated as final settlement and adjustment of accounts or in any way vary or affect the contract.

26. If contractor is executing any extra items as per direction of Engineer in charge / Officer in charge, the rates shall be worked out as per the latest CPWD Schedule of Rates and in case, the item is not included in the CPWD schedule, the rate shall be arrived as per prevailing Market rates.
27. The Quantity shown in the schedule is an approximate estimated quantity. No rate revision will be entertained if the quantity increases/decreases due to the site condition while executing the work.
28. Water and Electricity: The contractor shall make his own arrangement for water and electricity required for the works. HLL will not be responsible for the supply of either electricity or water.
29. During the execution of work, the contractor or authorized representative/s at least one person having technical qualification should be present at site.
30. The contractor shall comply with by-laws and regulation of local and statutory authorities having jurisdiction over the work and shall be responsible for payment of all statutory fees and other charges and the giving and receiving of all necessary notices and the Owner shall be kept informed of the said compliances with by-laws, payment made, notices issued and received. All statutory payments shall be made

by the Contractor and the same will be reimbursed by HLL on producing original challans/receipts.

31. Electrical

The work shall be carried out by a contractor holding valid license issued by the State Government/Competent Authority for carrying out installation work of all voltage classes involved, under direct supervision of the persons holding valid certificates issued or recognized by the state government/competent authority.

32. Final payment shall be paid only after clearing the site as per direction of Engineer-in-charge/ Officer in charge.

14) CORRESPONDENCE

All correspondence relating to this Order shall be in English, to:

Senior Manager (Projects),
Projects Division,
HLL Lifecare Limited (A Government of India Enterprise)
Corporate Head Office, Poojappura.P.O,
Thiruvananthapuram – 695012,
Kerala, India
Phn: 0471- 2354949, 2775588
E-mail: harikrishnankp@lifecarehll.com, choprojects@lifecarehll.com

15) SETTLEMENT OF DISPUTES

Arbitration shall not be a means of settlement of any dispute or claim arising out of the contract relating to the work. Any disputes or difference arising between the parties with respect to the performance of any part of this agreement or anything connected therewith, etc shall as far as possible be mutually settled by the process of dialog and negotiation.

The Courts at Thiruvananthapuram alone shall have jurisdiction in respect of settlement of any matter arising out or in connection with the contract.

SCHEDULE III

ACCEPTANCE FORM

(To be submitted in the letter pad of the firm indicating full name and address, telephone & fax numbers etc.)

From

To

Senior Manager (Projects),
Projects Division,
HLL Lifecare Limited (A Government of India Enterprise)
Corporate Head Office, Poojappura.P.O,
Thiruvananthapuram – 695012,
Kerala, India
Phn: 0471- 2354949, 2775588
E-mail: harikrishnankp@lifecarehll.com, choprojects@lifecarehll.com

Dear Sir,

I / We, hereby offer to supply/construct/erect/install/commission the work as detailed in schedule/drawings hereto or such portion thereof as you may specify in the acceptance of Bid at the price given in the price bid and agree to hold this offer open till 90 days after the date of bid opening prescribed by the purchaser/Owner. I/We have understood the terms and conditions mentioned in the invitation for bid and Conditions of Contract furnished by you and have thoroughly examined the specifications quoted in the bid document/drawings hereto and are fully aware of the nature of the scope of work required and my/our offer is to comply strictly in accordance with the requirement and the terms and conditions mentioned above.

Yours faithfully,

SIGNATURE OF THE BIDDER

SCHEDULE IV

DRAWINGS

1. LAYOUT OF HINDLABS MRI CENTRE AT GOVT MEDICAL COLLEGE HOSPITAL ,THRISSUR

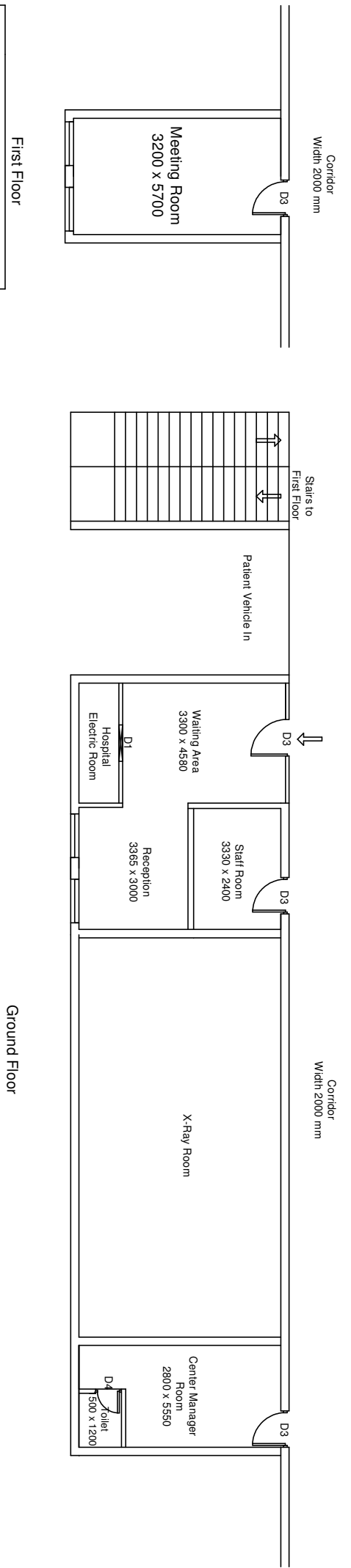
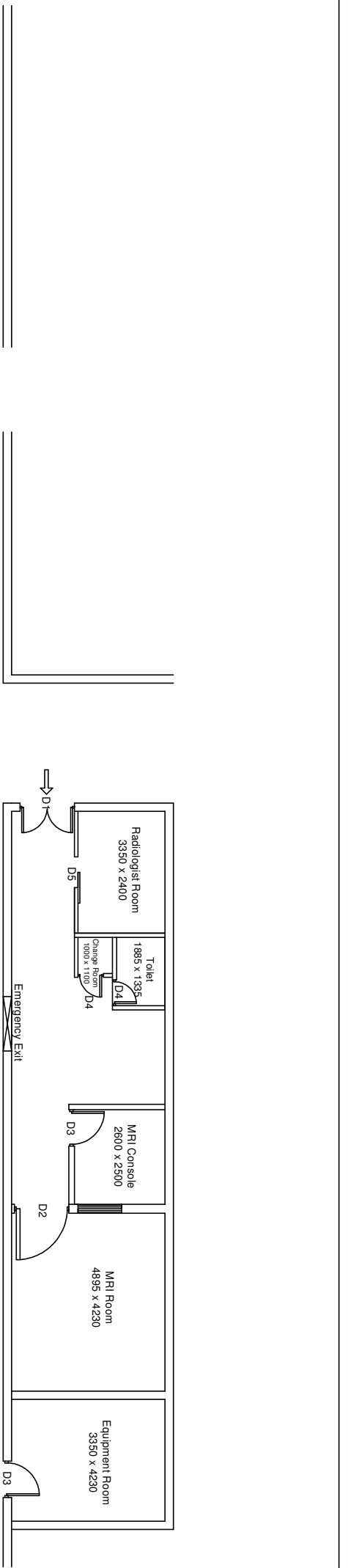

Details

D1	Double Swing Door W 1500 x H 2100 mm
D2	Single Swing Door W 1200 x H 2100 mm
D3	Single Swing Door W 900 x H 2100 mm
D4	Single Swing Door W 750 x H 2100 mm
D5	Sliding Door W 900 x H 2100 mm
W1	Window W 1200 x H 1200 mm

All Dimensions are in Millimeter

PLACE:	GMCH THRISSUR	<p>HLL Lifecare Limited Thiruvananthapuram</p>	AREA
DRAWN BY:	SARATH		152.578
CHECKED BY:	ASWATHY		Sq. M
APPROVED BY:	NTS		
DATE:	18-11-2017		
SCALE:	NTS		
DRG NO:	HLL-PRO-HCS-HL-006		
SHEET NO :	01 OF 02		
REV: 00			
DATE:	18.11.2017		



SCHEDULE V

SCHEDULE OF WORK

SCHEDULE V					
RENOVATION WORKS FOR HINDLABS MRI SCANNING CENTRE AT GOVT MEDICAL COLLEGE					
Item No	Details of items	Unit	Quantity	Rate	Amount
A CIVIL WORKS					
1	Dismantling old plaster or skirting raking out joints and cleaning the surface for plaster including disposal of rubbish to the dumping ground within 50 metres lead	Sqm	10		
2	Taking out doors, windows and clerestory window shutters (steel or wood) including stacking within 50 metres lead:				
	Of area beyond 3 sq. metres	Each	2		
3	Taking out and repair existing Aluminium door shutter, and frame etc. and refixing of repaired door shutters to existing door frames, including replacement/refixing of hinges with screws, locks handle,tower bolt etc. as required, (Additinal/new fittings like brass lock and hydrolic door closer will be pair separately), all complete as per the direction of the Engineer-in-charge.	Each	3		
4	Repairs to existing wooden cabinets/Doors by Taking out existing wooden door shutter, repair by cutting, painting etc. and refixing of repaired door shutters to existing door frames, including replacement of hinges with screws,lock etc. as required, all complete as per the direction of the Engineer-in-charge.	Sqm	25		
5	Plastering with cement mortar 1:4,(1 cement: 4 fine sand) 12 mm thick one coat to the newly constructed wall for one side	Sqm	15		
6	Removing white or colour wash by scrapping and sand papering and preparing the surface smooth including necessary repairs to scratches etc. complete	Sqm	600		
7	Providing and applying white cement based putty of average thickness 1 mm, of approved brand and manufacturer, over the plastered wall surface to prepare the surface even and smooth complete	sqm	150		
8	Applying one coat of water thinnable cement primer of approved brand and manufacture on wall surface :	Sqm	620		
9	Wall painting two coat with premium acrylic emulsion paint of interior grade, having VOC (Volatile Organic Compound) content less than 50 grams/ litre. of approved brand and manufacture, including applying additional coatswherever required to achieve even shade and colour.	Sqm	620		
10	Painting with synthetic enamel paint of approved brand and manufacture of required colour to give an even shade :				
	13.62.1 Two or more coats on new work over an under coat of suitable shade with ordinary paint of approved brand and manufacture				
	Two or more coats on new work over an under coat of suitable shade with ordinary paint of approved brand and manufactur	Sqm	15		

SCHEDULE V					
RENOVATION WORKS FOR HINDLABS MRI SCANNING CENTRE AT GOVT MEDICAL COLLEGE					
Item No	Details of items	Unit	Quantity	Rate	Amount
11	Providing and fixing tiled false ceiling of specified materials of size 595x595 mm in true horizontal level, suspended on inter locking metal grid of hot dipped galvanized steel sections (galvanized @ 120 grams/ sqm, both side inclusive) consisting of main "T" runner with suitably spaced joints to get required length and of size 24x38 mm made from 0.30 mm thick (minimum) sheet, spaced at 1200 mm center to center and cross "T" of size 24x25 mm made of 0.30 mm thick (minimum) sheet, 1200 mm long spaced between main "T" at 600 mm center to center to form a grid of 1200x600 mm and secondary cross "T" of length 600 mm and size 24x25 mm made of 0.30 mm thick (minimum) sheet to be interlocked at middle of the 1200x600 mm panel to form grids of 600x600 mm and wall angle of size 24x24x0.3 mm and laying false ceiling tiles of approved texture in the grid including, required cutting/making, opening for services like diffusers, grills, light fittings, fixtures, smoke detectors etc. Main "T" runners to be suspended from ceiling using GI slotted cleats of size 27 x 37 x 25 x1.6 mm fixed to ceiling with 12.5 mm dia and 50 mm long dash fasteners, 4 mm GI adjustable rods with galvanised butterfly level clips of size 85 x 30 x 0.8 mm spaced at 1200 mm center to center along main T, bottom exposed width of 24 mm of all T-sections shall be pre-painted with polyester paint, all complete for all heights as per specifications, drawings and as directed by Engineer-in-charge.				
	12.5 mm thick fully Perforated Gypsum Board tile made from plasterboard having glass fibre conforming to IS: 2095 part I, of size 595x595 mm, having perforation of 9.7x9.7 mm at 19.4 mm c/c with center borders of 48 mm and the side borders of 30 mm, backed with non woven tissue on the back side, having an NRC (Noise Reduction Coefficient) of 0.79, with 50 mm resin bonded glass wool backing.	sqm	10		
12	Supply and Fixing 12.5 mm thick fully Perforated Gypsum Board tile (in existing frame) made from plasterboard having glass fibre conforming to IS: 2095 part I, of size 595x595 mm, having perforation of 9.7x9.7 mm at 19.4 mm c/c with center borders of 48 mm and the side borders of 30 mm, backed with non woven tissue on the back side, having an NRC (Noise Reduction Coefficient) of 0.79, with 50 mm resin bonded glass wool backing.	Sqm	15		
13	Supply and Fixing GI Metal Ceiling Lay in perforated Tegular edge global white color tiles of size 595x595 mm and 0.5 mm thick with 8 mm drop; made of GI sheet having galvanizing of 100 gms/ sqm (both sides inclusive) and 20% perforation area with 1.8 mm dia holes and having NRC (Noise Reduction Coefficient) of 0.5, electro statically polyester powder coated of thickness 60 microns (minimum), including factory painted after bending and perforation, and backed with a black Glass fiber acoustical fleece.	Sqm	15		
14	Providing and fixing aluminium hanging floor door stopper, ISI marked, anodised (anodic coating not less than grade AC 10 as per IS : 1868) transparent or dyed to required colour and shade, with necessary screws Twin rubber stopper	Each	4		

SCHEDULE V					
RENOVATION WORKS FOR HINDLABS MRI SCANNING CENTRE AT GOVT MEDICAL COLLEGE					
Item No	Details of items	Unit	Quantity	Rate	Amount
15	Providing and fixing aluminium tower bolts ISI marked anodised (anodic coating not less than grade AC 10 as per IS: 1868) transparent or dyed to required colour or shade with nuts and screws etc. complete-				
	150 X 10 mm	Each	2		
16	Providing and fixing aluminium round shape handle of outer dia 100 mm with SS screws etc. complete as per direction of Engineerin-charge				
	Powder coated minimum thickness 50 micron aluminium	Each	4		
17	Providing and fixing aluminium die cast body tubular type universal hydraulic door closer (having brand logo with ISI, IS : 3564, embossed on the body, door weight upto 35 kg and door width upto 700 mm), with necessary accessories and screws etc. complete	Each	2		
18	Providing and fixing special quality bright finished brass locks with four levers including necessary screws etc. complete (bestmake of approved quality) :65mm	Sqm	1		
19	Providing and fixing Stainless Steel A ISI 304 (18/8) kitchen sink as per IS: 13983 with C.I. brackets and stainless steel plug 40 mm, including painting of fittings and brackets, cutting and making good the walls wherever required : 610X460mm bowel depth 200mm	Each	1		
20	Providing and fixing PTMT Waste Coupling for wash basin and sink, of approved quality and colour.	Each	1		
21	Providing and fixing P.V.C. waste pipe for sink or wash basin including P.V.C. waste fittings complete.Flexible pipe	Each	1		
22	Cleaning and Refixing existing Stainless Steel kitchen sink as per with C.I. brackets and stainless steel plug 40 mm, including PTMT grating of approved quality, waste pipe necessary plumbing work and painting of fittings and brackets, cutting and making good the walls wherever required complete as per direction of engineer in charge	Each	1		
23	Providing and Fixing modular storage cabinets made of MS shelves, with powder coated aluminum section for sliding doors and Glass shutters with proper provision of racks and shelves. The minimum thickness of glass shutters will be 4mm and minimum no of shelves is 5 and minimum depth is 2m. Maximum height of the cabinet is depending upon the available height at the location. All sides should be covered with laminated particle board and Shelves to be fixing with proper bracket holders.	Sqm	10		
24	PVC Pipe : Supplying and fixing Truebore / Supreme make PVC Pipes and pipe specials confirming IS, cutting the pipes to required lengths, making joint between pipes and pipe specials using solvent cement, ring seal couplers, aligning the pipe to perfect plumb, fixing the pipe using required clamps fixed to bracket, making earthwork excavation in trenches to required width and depth, providing 100 mm thick sand all around the pipes, refilling the trenches in layers with excavated earth, consolidating, etc. including disposing off surplus earth as directed by the Engineer-in-Charge, testing for leak proof etc. complete. 2 inches	m	15		

SCHEDULE V**RENOVATION WORKS FOR HINDLABS MRI SCANNING CENTRE AT GOVT MEDICAL COLLEGE**

Item No	Details of items	Unit	Quantity	Rate	Amount
25	PVC Pipe : Supplying and fixing Truebore / Supreme make PVC Pipes and pipe specials confirming IS, cutting the pipes to required lengths, making joint between pipes and pipe specials using solvent cement, ring seal couplers, aligning the pipe to perfect plumb, fixing the pipe using required clamps fixed to bracket, making earthwork excavation in trenches to required width and depth, providing 100 mm thick sand all around the pipes, refilling the trenches in layers with excavated earth, consolidating, etc. including disposing off surplus earth as directed by the Engineer-in-Charge, testing for leak proof etc. complete.3/4 inches	m	15		
Total Civil Works					

SCHEDULE V					
RENOVATION WORKS FOR HINDLABS MRI SCANNING CENTRE AT GOVT MEDICAL COLLEGE					
Item No	Details of items	Unit	Quantity	Rate	Amount
B ELECTRICAL WORKS					
WIRING					
1	Rewiring for light point/ fan point/ exhaust fan point/ call bell point with 1.5 sq.mm FRLS PVC insulated copper conductor single core cable and 1.5 sq.mm FRLS PVC insulated copper conductor single core cable as earth wire in existing surface/ recessed steel/PVC conduit including dismantling as required.	Point	15		
2	Point wiring in PVC conduit, with Modular type switch: Wiring for light point/ fan point/ exhaust fan point/ call bell point with 1.5 sq.mm FRLS PVC insulated copper conductor single core cable in surface / recessed medium class PVC conduit, with modular switch, modular plate, suitable GI box and earthing the point with 1.5 sq.mm. FRLS PVC insulated copper conductor single core cable etc as required - Group C(Recommended Makes: RRRKabel/National/Ralison/RKG/Finolex/Polycab / Havells)	Point	10		
3	Wiring for light/ power plug with 2X4 sq. mm FRLS PVC insulated copper conductor single core cable in surface/ recessed medium class PVC conduit alongwith 1 No. 4 sq. mm FRLS PVC insulated copper conductor single core cable for loop earthing as required. (Recommended Material : Polycab, RR Kabel, V Guard, Havells)	m	60		
4	Wiring for circuit/ submain wiring alongwith earth wire with the following sizes of FRLS PVC insulated copper conductor, single core cable in surface/ recessed medium class PVC conduit as required.(Recommended Material : RR Kabel/National/Ralison/RKG/Finolex/Polycab / Havells)				
a)	2 X 1.5 sq. mm + 1 X 1.5 sq. mm earth wire	m	20		
b)	2 X 2.5 sq. mm + 1 X 2.5 sq. mm earth wire	m	30		
5	Supplying and fixing of following sizes of medium class PVC conduit (ISI brand) along with accessories in surface/recess including cutting the wall and making good the same in case of recessed conduit as required.				
a)	25 mm	m	40		
6	S/F light plug point modular type accessories : Supplying and fixing suitable size GI box with modular plate and cover in front on surface or in recess, including providing and fixing 3 pin 5/6 amps modular socket outlet and 5/6 amps modular switch, connection,painting etc as required,	Each	4		
7	S/F Power plug point with modular type switch : Supplying and fixing suitable size GI box with modular plate and cover in front on surface or in recess, including providing and fixing 6 pin 15/16 and 15/16 amps modular switch, connection,painting etc as required.	Each	2		
8	S/F 20A SPN MCB industrial socket outlet : Supplying and fixing 20 A, 240 V, SPN Industrial type socket outlet, with 2 pole and earth, metal enclosed plug top alongwith 20 A, "C" curve, SP, MCB, in sheet steel enclosure, on surface or in recess, with chained metal cover for the socket out let and complete with connections, testing and commissioning etc. as required.	Each	1		
9	S/F Modular boxes, base & cover plate : Supplying and fixing 1 or 2 module (75 mmx75 mm),GI box along with modular base, cover plate for modular switches in recess etc as required.				

SCHEDULE V					
RENOVATION WORKS FOR HINDLABS MRI SCANNING CENTRE AT GOVT MEDICAL COLLEGE					
Item No	Details of items	Unit	Quantity	Rate	Amount
c.	RJ-45 socket outlet	Each	4		
10	Supplying and drawing of UTP 4 pair CAT 6 LAN Cable in the existing surface/ recessed Steel/ PVC conduit as required. 1 run of cable	Each	80		
	MCCB, MCB & DB'S				
11	Supplying and fixing following way, horizontal type three pole and neutral, sheet steel, MCB distribution board, 230 V, on surface/ recess, complete with tinned copper bus bar, neutral bus bar, earth bar, din bar, interconnections, powder painted including earthing etc. as required. 4 way (4 + 12), Double door	Each	1		
12	S/F 'C' series, MCB : Supplying and fixing 5 amps to 32 amps rating, 240/415 volts, "C" curve, miniature circuit breaker suitable for inductive load of following poles in the existing MCB DB complete with connections, testing and commissioning etc. as required.				
a.	Single pole	Each	15		
b.	Single pole and neutral	Each	1		
13	Supplying and fixing following rating, four pole, (three phase and neutral), 415 V, residual current circuit breaker (RCCB), having a sensitivity current 30 mA in the existing MCB DB complete with connections, testing and commissioning etc. as required. 63A	Each	1		
14	Supplying and fixing Cable End Box (Loose wire box)(IP 43) suitable for following triple pole and neutral, sheet steel, MCB distribution board, 415 V, on surface/ recess, complete with testing and commissioning etc. as required. For 4 way, Double door TPN MCBDB	each	1		
	LIGHT /FAN FITTINGS				
15	Supply, installation, testing and commissioning of the following types of light fittings with all accessories on false ceiling, true ceiling or wall as directed and giving connections with 16/0.20 mm 3 core PVC insulated and sheathed round copper conductor flex wire or extending the original wiring and giving connections as required. All recessed type fixtures are to be supported independently with chains or GI wire anchored to the ceiling with anchoring bolt of necessary size. All loose wires above the false ceiling are to be neatly concealed by flexible metal/pvc conduits.(cost to include lamps & all consumables also)				
a	15W 4000k LED luminaire with High translucent diffuser gives soft glare free light & complete with electronic driver including all required mounting accessories complete.(Havells DIVA (RECESS) - 15W or equivalent)	Each	10		
b	1x18W T8 slim type tube fitting with decorative end caps. (Havells , Philips, Bajaj or equivalent)	each	8		
c	Supply, Installation, testing and commissioning of wall mount fan (400mm sweep), adjustable speed . min 60 degree oscillation, swing, Adjustable upward and downward tilt mechanism, Protective Guard, Including connections with 1.5 sq. mm FRLS PVC insulated, copper conductor, single core cable, mounting accessories, etc. as required. It shall be double ball bearing type. (Make : USHA, Crompton , Havells)	Nos.	4		

SCHEDULE V					
RENOVATION WORKS FOR HINDLABS MRI SCANNING CENTRE AT GOVT MEDICAL COLLEGE					
Item No	Details of items	Unit	Quantity	Rate	Amount
	CABLE / EARTHING				
16	Earthing with G.I. earth pipe 4.5 meter long, 40 mm dia including accessories, and providing masonry enclosure with cover plate having locking arrangement and watering pipe etc. with charcoal/ coke and salt as required.	each	1		
17	Providing and fixing 4.00 mm dia copper wire on surface or in recess for loop earthing as required.	m	80		
	MISCELLANIOUS				
18	Supply and Installation of backlit flex board of approved size and design. The board shall be fabricated out of of GI metal fixed on MS angle supports fastened to wall/structure. Including electrical fittings, connections, all accessories, necessary coat of primer and enamel paint, complete. (size shall vary as per approved design and site conditions and will be paid as actuals)	sqm	4		
	Total for Electrical work				
Grand Total Amount					
Applicable Taxes					
Grand Total Amount					
I AGREE TO EXECUTE THE WORKS AS PER THE RATES QUOTED ABOVE					
Signature of Contractor					